

297 mm

DECATHLON

STRAP TRAINING

SANGLE DE SUSPENSION

420 mm



Photo Ref: 407929

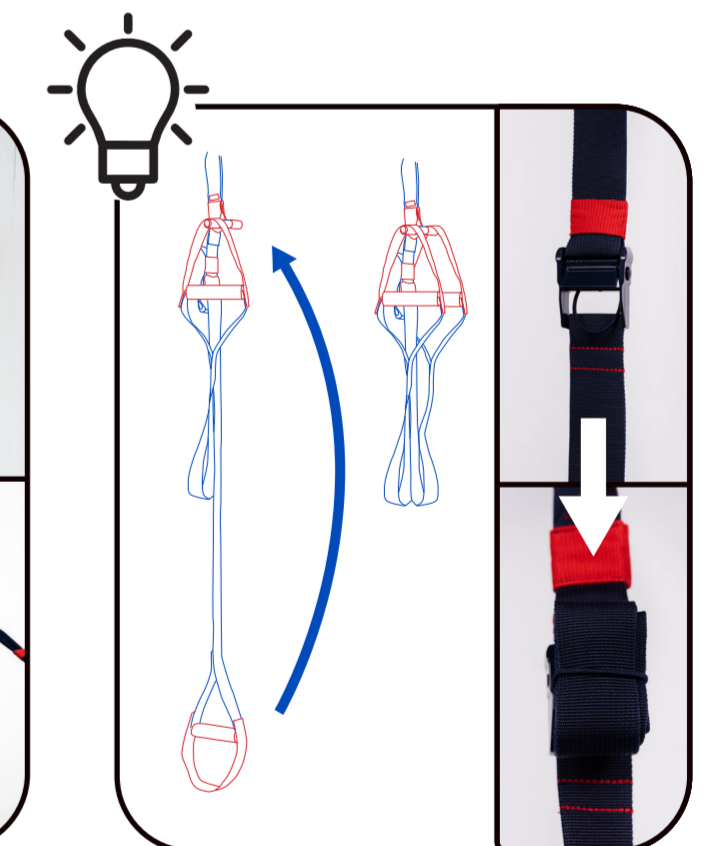
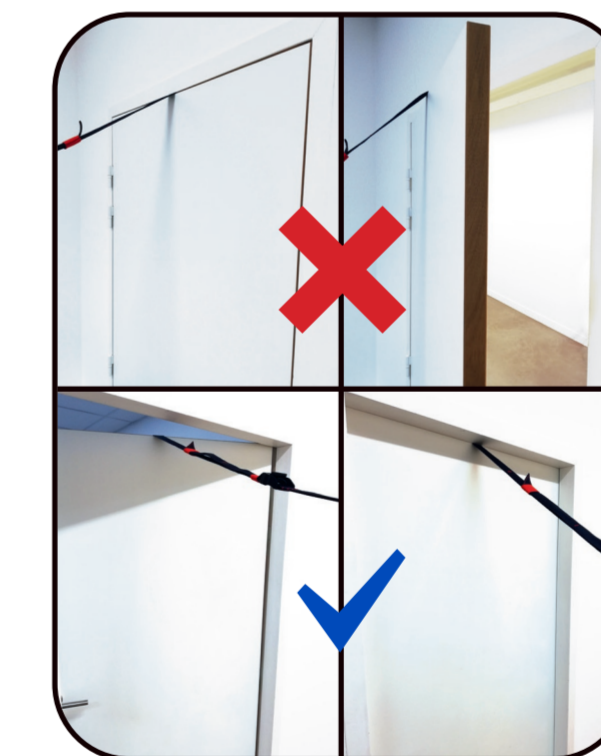
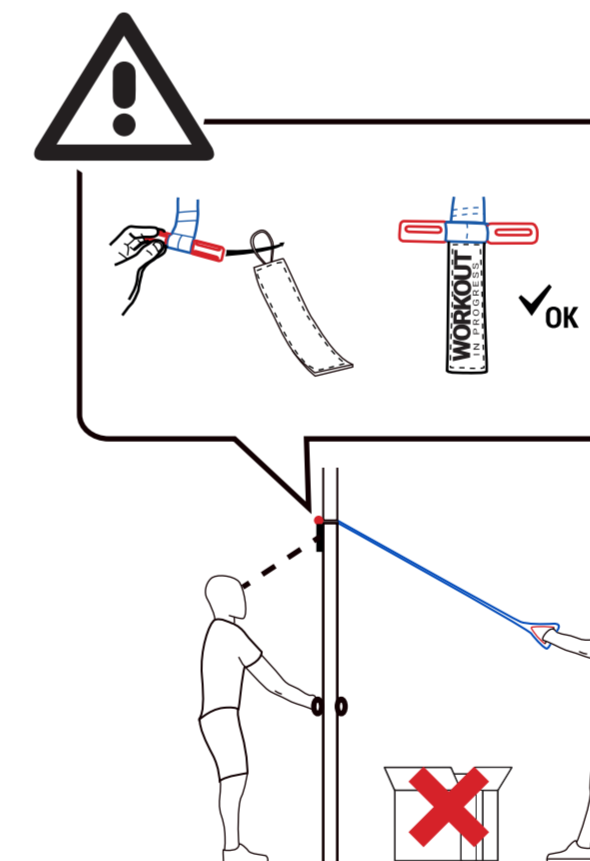
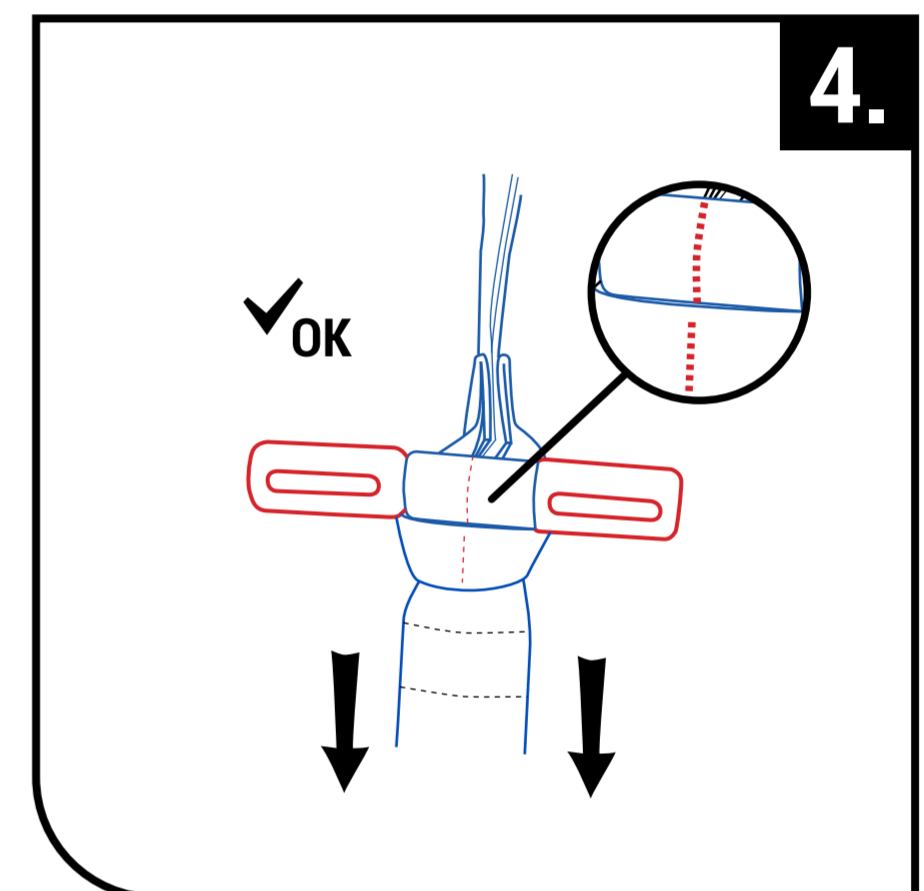
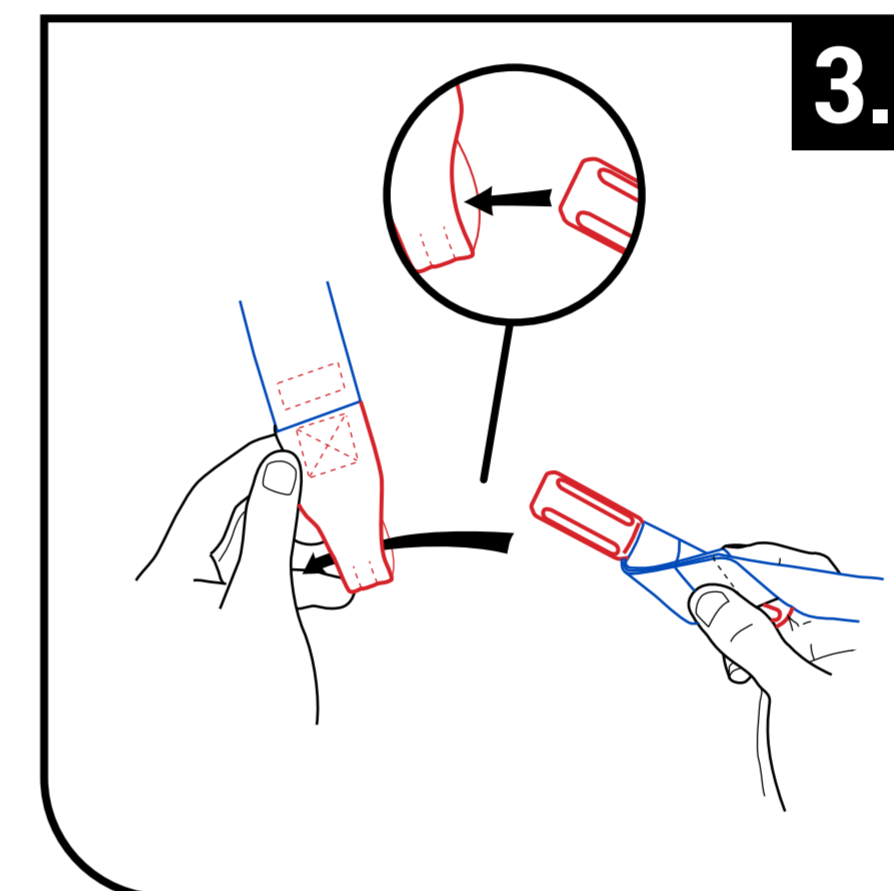
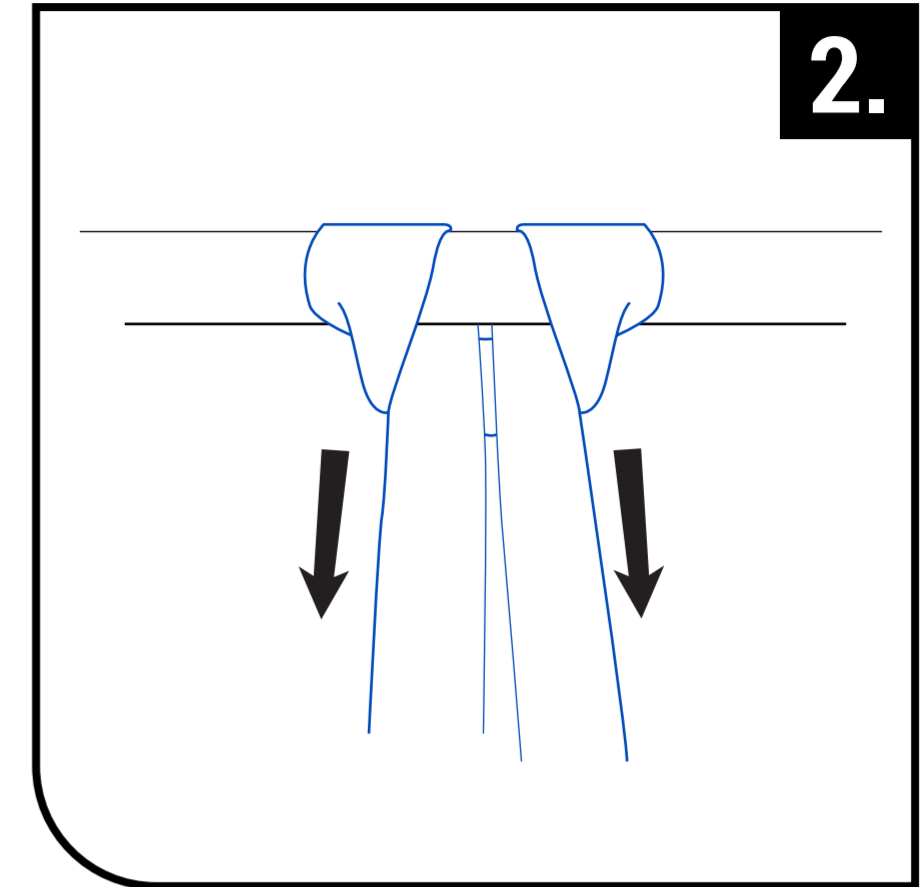
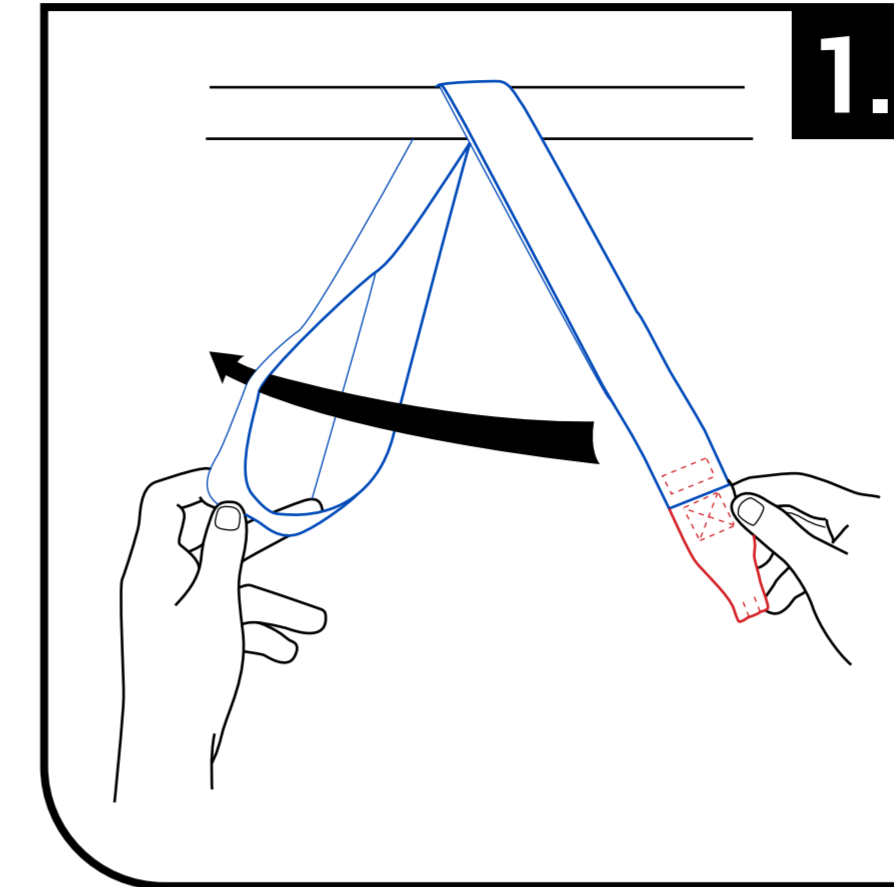

CAPTION
 — Cutting
 — Cotation

PRINTING INFORMATION

CMYK PROCESS COLORS :
 C M Y K

illuminant source : D50/2°
 Tolerance : dE* 2000 (2:1:1) ≤ 2.5
 Geometry : 45/0
 Filter: M0
 ISO 12647-2

FINISHING :
 ACRYLIC VARNISH
 Mate Satin Glossy No
 YES NO NO NO

UV VARNISH : NO

PRINTING INFORMATION : FRONT

Yes No
 Printing process :
 Offset Helio Flexo
 For printing informations, please refer to the artwork n° : XXXXXXXXXX

ARTWORK PROJECT MANAGEMENT

FILE_NAME : CHN_4079529_DARD_309804_USG
 PROJECT_MANAGER : anthony.profichet@decathlon.com
 GRAPHIC_DESIGNER : camille.moinaux@decathlon.com
 PACK_REF : 4079529
 DSM_CODE : 9810013211
 RETRIEVAL_DATE : 09/09/2019

VERSION : 09/09/19 17:45
 SCALE : 1 : 1

Le composant ci décrit doit être conforme à la directive 94/62/CE et au décret français 98/638 :
 - Taux de métaux lourds inférieur à 100ppm.
 - Minimisation des substances dangereuses (cf réglementation de la directive 67/548/CEE).
 - Les normes correspondantes sont EN 13432, EN 13430, EN 13433, EN 13431, EN 13432.
 Ce document est la propriété de DECATHLON. Tous les droits sont réservés.
 This product should respect the latest updated DECATHLON Toxicology specifications
 Ce produit devra respecter la dernière version de DECATHLON Toxicology Specifications

The component described here must comply with directive 94/62/EC and to the french decree 98/638 :
 - Heavy metal rate under 100ppm.
 - In accordance with directive 67/548/EEC, the use of hazardous substances must be minimized.
 The standards are EN 13432, EN 13430, EN 13433, EN 13431, EN 13432.
 This document is the property of DECATHLON. All rights reserved.
 This product should respect the latest updated DECATHLON Toxicology specifications

PRINTING INFORMATION : REVERSE

Yes No
 Printing process :
 Offset Helio Flexo
 For printing informations, please refer to the artwork n° : XXXXXXXXXX