

# DISTRIBUTION/WAREHOUSE SPACE

8551 Saul Bell, Albuquerque, NM 87121

## FOR LEASE

± 40,040 SF



**Lease Rate**  
**Starting at**  
**\$9.60 - \$10.95 PSF + NNN**



**Thomas Mortensen**  
**Associate Broker**  
**505.263.3159**  
**Thomas@AllenSigmon.com**

**Allen Sigmon Real Estate Group, LLC**

9201 Montgomery Blvd NE, Bldg 1  
Albuquerque, NM 87111  
505.884.4699 | Fax 505.503.1381  
[www.AllenSigmon.com](http://www.AllenSigmon.com)





# PROPERTY OVERVIEW

## DISTRIBUTION/WAREHOUSE SPACE

**8551 Saul Bell, Albuquerque, NM 87121**



**AVAILABLE SF:**  
**40,040 SF**  
**Demisable to:**  
**Suite A: 22,880 SF**  
**Suite B: 17,160 SF**



**HEATING / COOLING**  
**Warehouse:**  
**Suspended Gas / Evaporative**  
**Office:**  
**Refridgerated Air**



**TYPE:**  
**Office & Warehouse**



**COLUMN SPACING**  
**40' - 46'**



**CLEAR HEIGHT:**  
**22'-23'**



**ZONING:**  
**NR-BP**



**Thomas Mortensen**  
**Associate Broker**  
**505.263.3159**  
**Thomas@AllenSigmon.com**

**Allen Sigmon Real Estate Group, LLC**  
9201 Montgomery Blvd NE, Bldg 1  
Albuquerque, NM 87111  
505.884.4699 | Fax 505.503.1381  
[www.AllenSigmon.com](http://www.AllenSigmon.com)



## Suite A

- 22,880 SF
- 1 Grade level roll up door
- 8 Dock Doors
- 2,355 Office
  - + 2 large restrooms
  - Bull Pen
  - Large conference room/breakroom
  - 2 Private offices
- Large showroom
- Power:
  - 600 Amps
  - 120/208 Volts

## Suite B

- 17,160 SF Warehouse Space
- 6 Dock Doors (Grade Level rollup door available)
- Office Buildout Available
- 400 Amps
  - 120/208 Volts
- Open Warehouse Space
- Office Buildout Available (see broker)

# DISTRIBUTION/WAREHOUSE SPACE

8551 Saul Bell, Albuquerque, NM 87121

## FLOOR PLAN

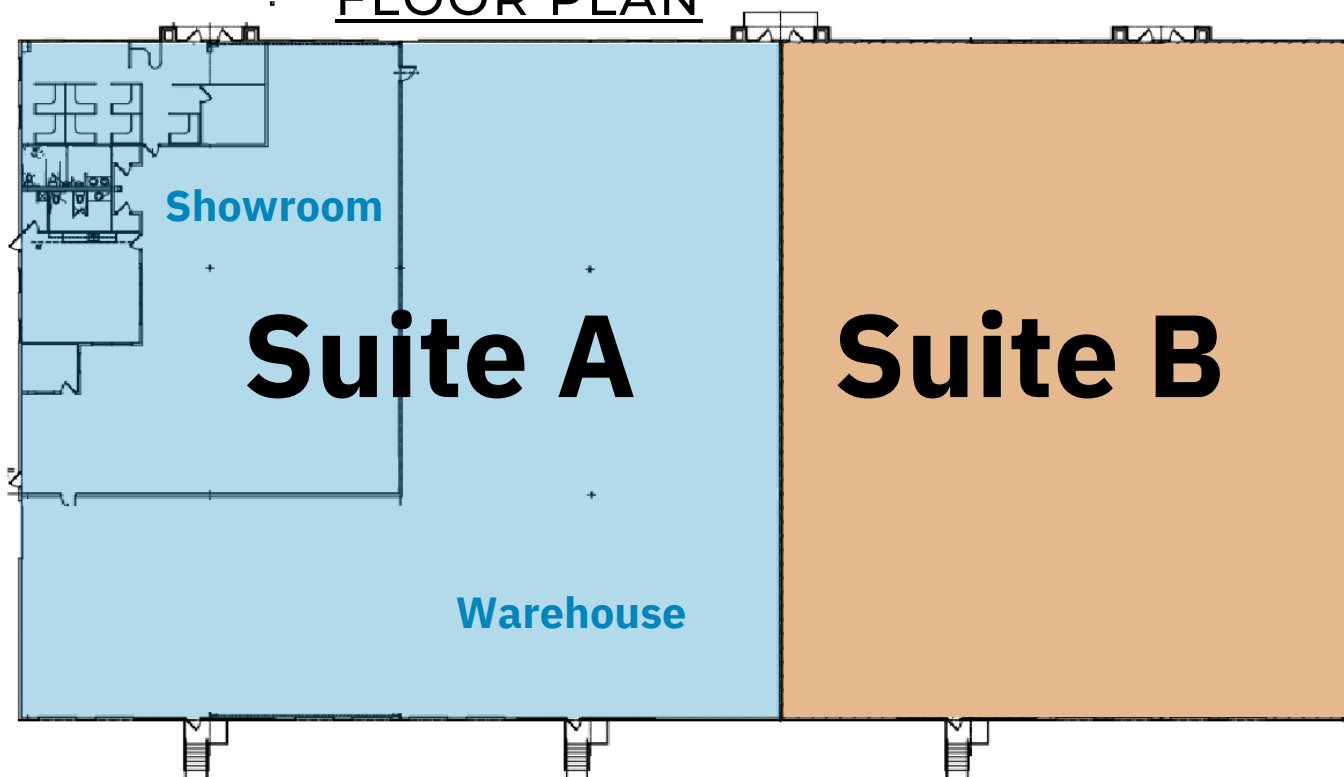

**Thomas Mortensen**  
**Associate Broker**  
**505.263.3159**  
**Thomas@AllenSigmon.com**

**Allen Sigmon Real Estate Group, LLC**  
9201 Montgomery Blvd NE, Bldg 1  
Albuquerque, NM 87111  
505.884.4699 | Fax 505.503.1381  
[www.AllenSigmon.com](http://www.AllenSigmon.com)





# INTERIOR IMAGES DISTRIBUTION/WAREHOUSE SPACE

8551 Saul Bell, Albuquerque, NM 87121

## Suite A



**Thomas Mortensen**  
**Associate Broker**  
**505.263.3159**  
**Thomas@AllenSigmon.com**

**Allen Sigmon Real Estate Group, LLC**  
9201 Montgomery Blvd NE, Bldg 1  
Albuquerque, NM 87111  
505.884.4699 | Fax 505.503.1381  
[www.AllenSigmon.com](http://www.AllenSigmon.com)





# INTERIOR IMAGES DISTRIBUTION/WAREHOUSE SPACE

8551 Saul Bell, Albuquerque, NM 87121

## Suite B



Disclosure: Listing broker has ownership interest in property

The information contained is believed reliable. While we do not doubt the accuracy, we have not verified it and make no guarantee, warranty or representation about it. It is your responsibility to independently confirm its accuracy and completeness. Any projection, opinion, assumption or estimated users are for example only and do not represent the current or future performance of the property. The value of this transaction to you depends on many factors which should be evaluated by your tax, financial, and legal counsel. You and your counsel should conduct a careful independent investigation of the property to determine that it is suitable to your needs.



**Thomas Mortensen**  
**Associate Broker**  
**505.263.3159**  
**Thomas@AllenSigmon.com**

**Allen Sigmon Real Estate Group, LLC**  
9201 Montgomery Blvd NE, Bldg 1  
Albuquerque, NM 87111  
505.884.4699 | Fax 505.503.1381  
[www.AllenSigmon.com](http://www.AllenSigmon.com)

