

NOTES

- 1. ALL CALCULATIONS INDICATE "GROSS RETAIL" AREA AS PER "BOMA" STANDARDS.
- 2. ALL FIXTURES INDICATED ARE BUILT-IN.
- 3. ALL FLOORS ARE VINYL UNLESS OTHERWISE INDICATED.
- 4. ALL CEILING HEIGHTS ARE 8'-0" UNLESS OTHERWISE NOTED.
- 5. ALL DIMENSIONS TO BE FIELD VERIFIED PRIOR TO ANY CONSTRUCTION.
- 6. SOME DIMENSIONS MAY VARY DUE TO WALLS OUT OF PLUMB.

AREA CALCULATIONS:

SUITE 1406 AREA 3094.70 SQ. FT.

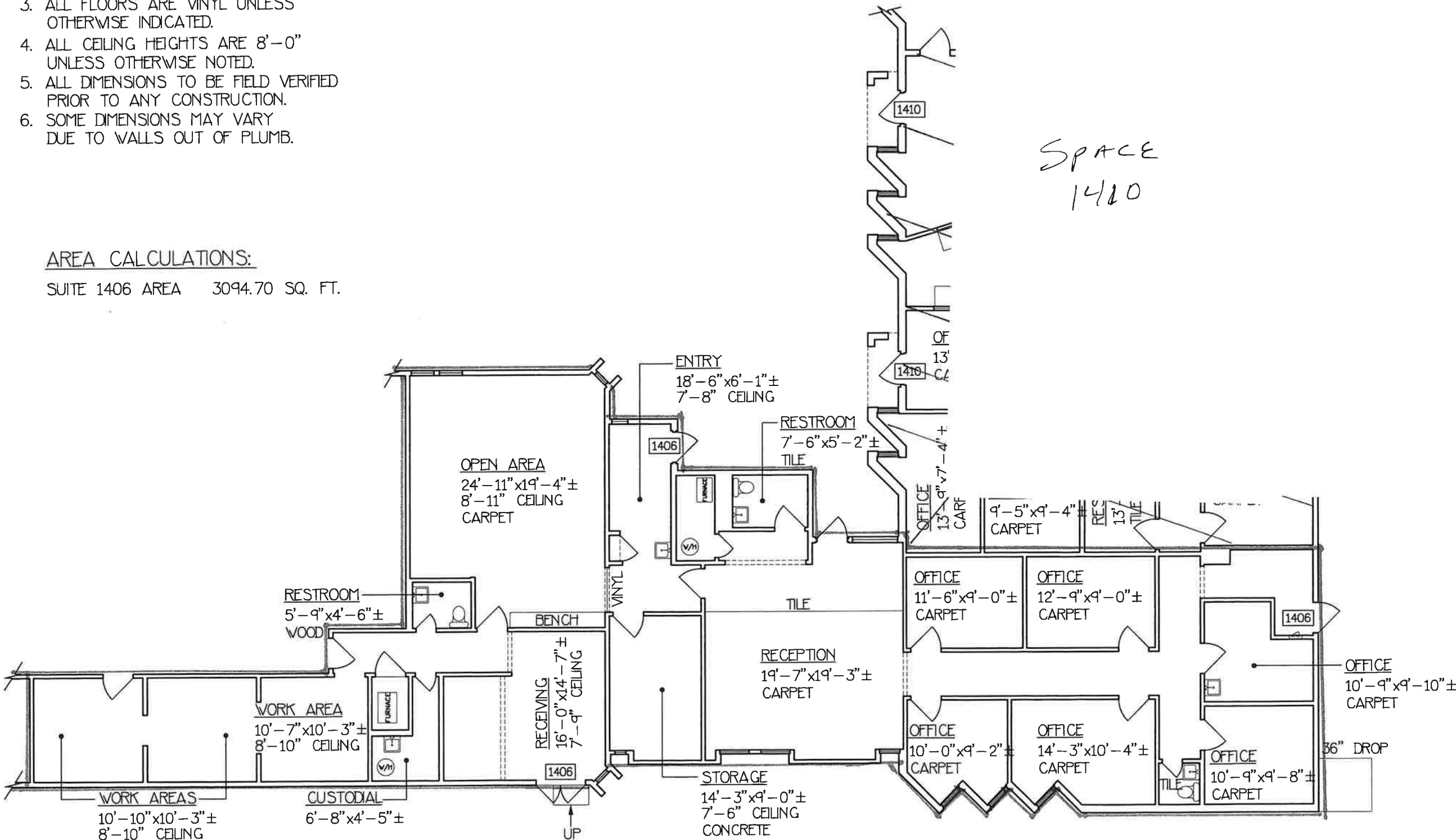

SPACE  
1410

1406 A+B SAN PEDRO DRIVE NE

ORIENTATION	MEASURED BY	JR/JO
DESIGNED BY	N.A.	
DRAFTED BY	JR/JO	
CHECKED BY	P.M.	
REVISED:		
SCALE	DATE	
3/32"=1'-0"	05/31/18	

SHEET #  
01  
OF 01

1  
8  
0  
7  
6

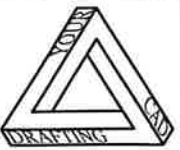

YCD DESIGNS  
505-899-1199

PROJECT:  
1406  
& 1410  
SAN PEDRO  
DRIVE NE

DESCRIPTION:  
AS-BUILT  
DRAWING

CLIENT:  
BERGER  
BRIGGS