

MENAU

2103 Menaul Blvd NE,
Albuquerque, NM 87107

Retail Space

FOR LEASE



AVAILABLE

Suite A +- 1,687

Modified Gross \$2500/Month

PROPERTY HIGHLIGHTS

- Prime Retail space Visible to over 23k Vehicles Per Day
- Close to the Big I Interchange
- Located near the Ramada & Crown Plaza Hotels
- Monument Signage Included

Joseph Maez

505.633.3335

joseph@nvreg.com

Corinna Yonemoto

505.615.6859

corinna@nvreg.com



www.nvreg.com

505.615.6859



2103 MENAUL FOR LEASE

PHOTOS



Corinna Yonemoto
505.615.6859
corinna@nvreg.com

Joseph Maez
505.633.3335
joseph@nvreg.com

THE INFORMATION CONTAINED IS BELIEVED RELIABLE. WHILE WE DO NOT DOUBT THE ACCURACY, WE HAVE NOT VERIFIED IT AND MAKE NO GUARANTEE, WARRANTY OR REPRESENTATION ABOUT IT. IT IS YOUR RESPONSIBILITY TO INDEPENDENTLY CONFIRM ITS ACCURACY.

2103 MENAUL FOR LEASE

FLOOR PLAN Main Level

PRINCETON

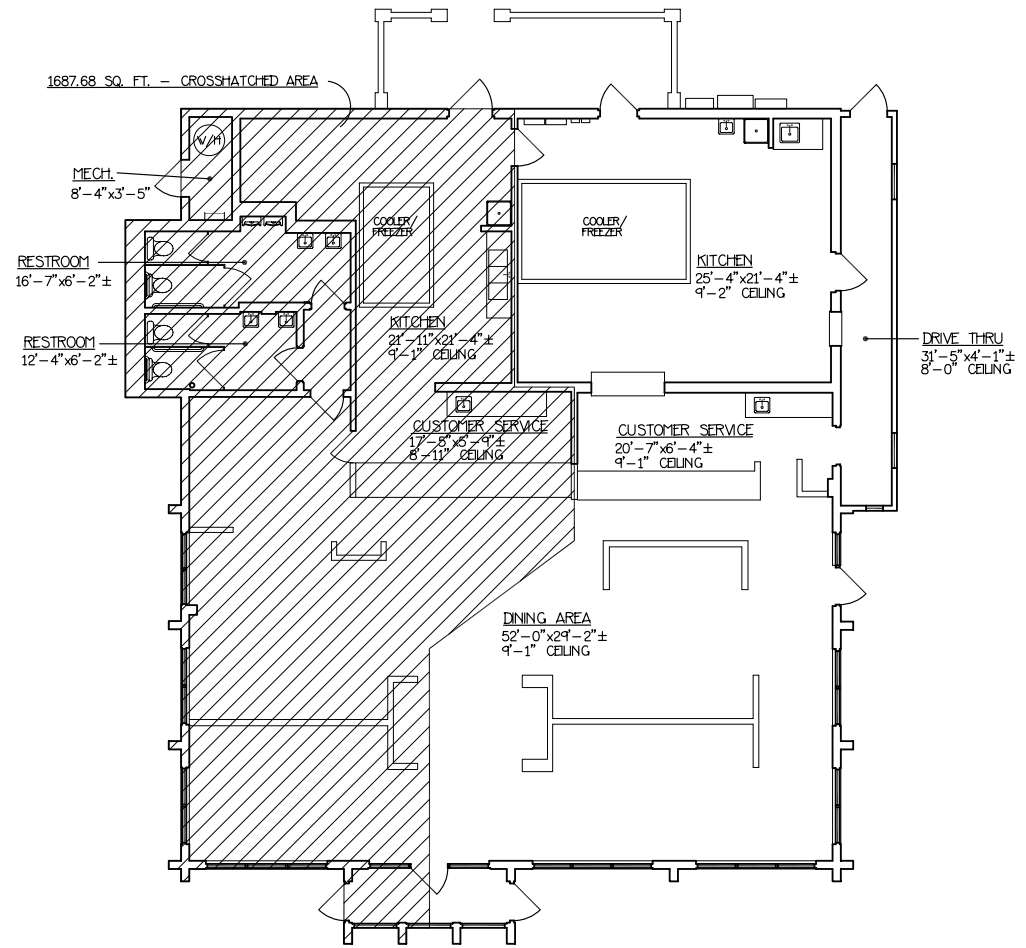

Suite Size
±1,687 SF

Building Floorplan
Currently Being Updated

Visibility
Over 23k VPD

Location
Hard Corner of Menaul & Princeton

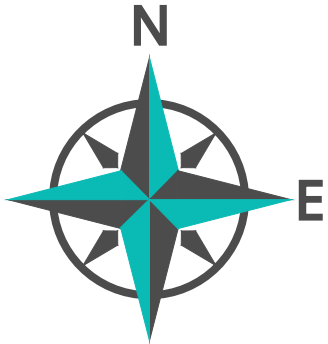

Corinna Yonemoto
505.615.6859
corinna@nvreg.com

Joseph Maez
505.633.3335
joseph@nvreg.com

THE INFORMATION CONTAINED IS BELIEVED RELIABLE. WHILE WE DO NOT DOUBT THE ACCURACY, WE HAVE NOT VERIFIED IT AND MAKE NO GUARANTEE, WARRANTY OR REPRESENTATION ABOUT IT. IT IS YOUR RESPONSIBILITY TO INDEPENDENTLY CONFIRM ITS ACCURACY.

2103 MENAUL FOR LEASE

LOCATION MAP



Corinna Yonemoto
505.615.6859
corinna@nvreg.com

Joseph Maez
505.633.3335
joseph@nvreg.com

THE INFORMATION CONTAINED IS BELIEVED RELIABLE. WHILE WE DO NOT DOUBT THE ACCURACY, WE HAVE NOT VERIFIED IT AND MAKE NO GUARANTEE, WARRANTY OR REPRESENTATION ABOUT IT. IT IS YOUR RESPONSIBILITY TO INDEPENDENTLY CONFIRM ITS ACCURACY.