

417 East Palace Ave Condo Nuggets

**417 East
Palace Ave,
Santa Fe, NM**



\$225,000 - \$235,000

Property Highlights

- 4 units available: Suites 14, 15, 16, and 17
- Downtown location close to the Plaza
- Onsite parking, recently paved
- Fiber internet service
- Minimal monthly condominium fee
- Shared professional conference room and kitchen

Property Description

These office condos are drive-up suites convenient for conducting business within walking distance of the Plaza, complete with a shared professional conference room and a shared kitchen. The monthly condominium fee covers all utilities, AC/Heating, security, exterior maintenance, property taxes, use of the shared spaces and fiber internet service. These suites also offer newly paved onsite parking.

For more information, contact:

TAI BIXBY
(505) 577-3524
tai@tba.team

REA | Real Estate Advisors
901 Rio Grande Blvd NW
#D224
Albuquerque, NM 87104
505-539-3200 (p)
www.reanm.com

We obtained the information above from sources we believe to be reliable. However, we have not verified its accuracy and make no guarantee, warranty or representation about it. It is submitted subject to the possibility of errors, omissions, change of price, rental or other conditions, prior sale, lease or financing, or withdrawal without notice. We include projections, opinions, assumptions or estimates for example only, and they may not represent current or future performance of the property. You and your tax and legal





Suite 14

Sq. Footage

214 SF

Asking Price

\$225,000

Condo Dues

\$240.77/month

Suite 15

217 SF

\$225,000

\$244.08/month

Suite 16

Sq. Footage

242 SF

Asking Price

\$235,000

Condo Dues

\$272.25/month

Suite 17

235 SF

\$235,000

\$263.96/month





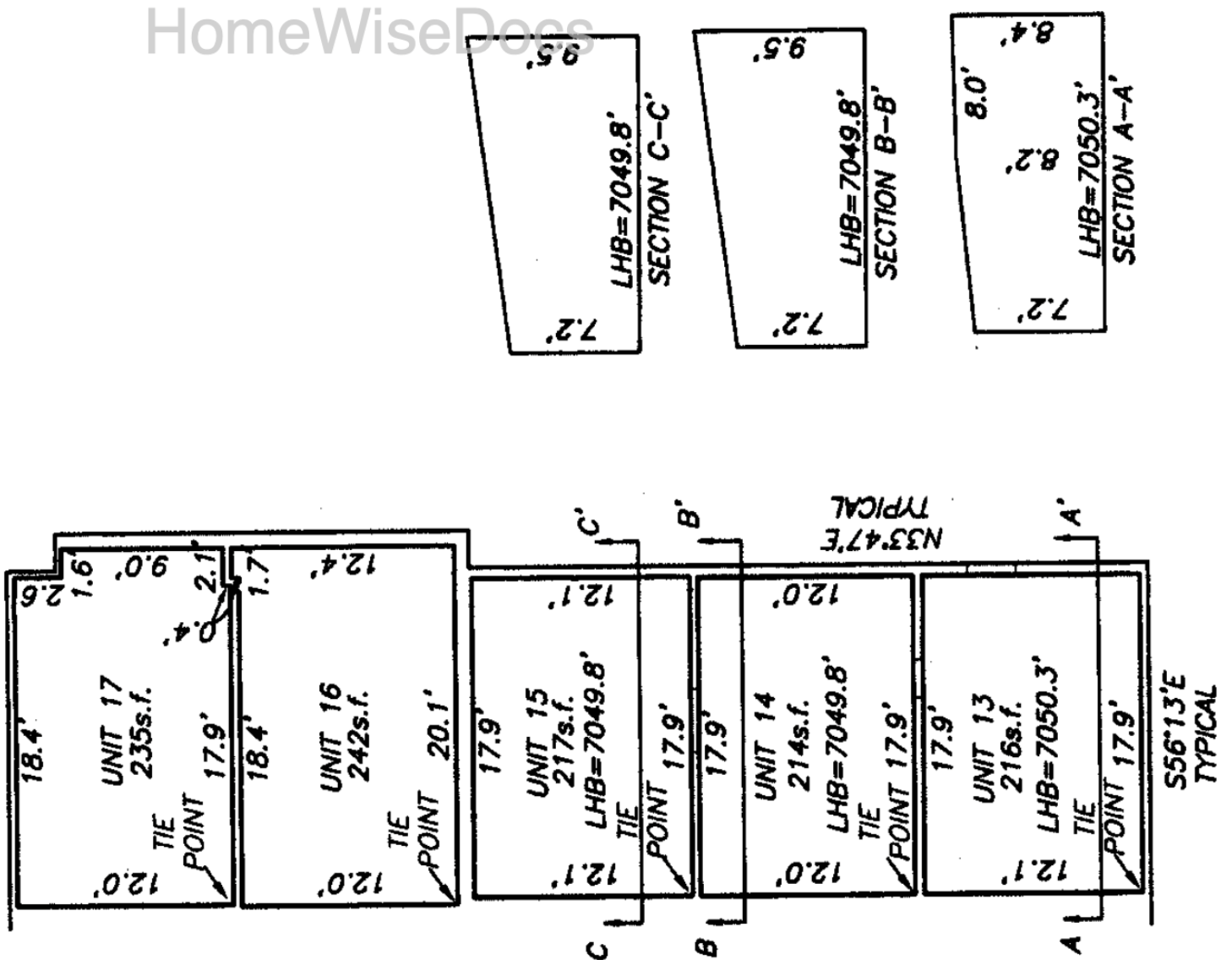

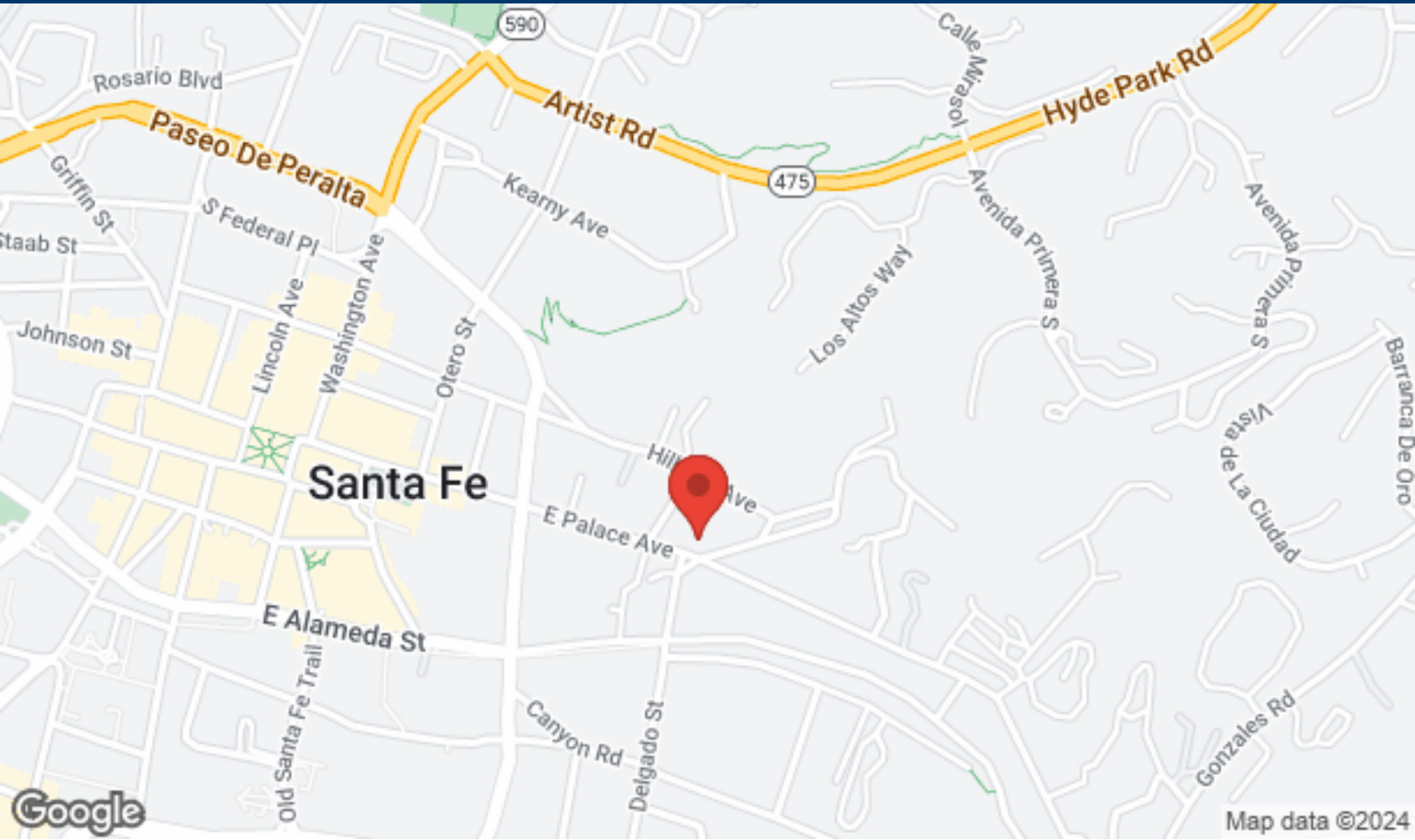

**Tai Bixby, CCIM**

505-577-3524

tai@tba.team

Tai has joined Real Estate Advisors Santa Fe Division with over 16 years of experience. He has been in real estate since 2004, working in residential and commercial brokerage, as well as development. Earning his CCIM designation in 2012, Tai has been involved with commercial real estate exclusively since 2018. Tai's experience includes real estate brokerage, office/industrial/retail sales/leasing, land sales both residential and commercial, 1031 tax deferred exchanges, financial/market/leasing analysis in the Santa Fe/Albuquerque real estate markets. In addition, Tai has extensive experience in investment management/analysis on behalf of both partnership and clients with passive and active investments. Tai enjoys working in commercial real estate because he likes problem solving and helping people achieve their business and financial goals. His work in commercial real estate also allows him the ability to have fun and meet interesting people. When Tai is not at work, you can find him snowboarding, mountain biking, sailing and traveling internationally. He balances his work/life schedule by focusing first on what matters most in his life; his faith and his family.