

PLAZA DEL SOL

PAD SITES NEAR 700 SIXTH ST.
SOCORRO, NM 87801

Walt Arnold, CCIM, SIOR
Managing Director
505.256.1255
walt.arnold@svn.com



LOT 6

LOT 4

LOT 5

LOT 2

LOT 3

CALIFORNIA ST.

Property Summary



OFFERING SUMMARY

Sale Price: Subject To Offer

Lot Size: 8.694 Acres

Market: Socorro

Price / SF: \$9.90-\$15.20 P/SF

PROPERTY OVERVIEW

Plaza del Sol is located directly in the center of Socorro New Mexico's commercial district. There are a total of seven [7] pad sites. Wal-Mart anchors pad site seven, the largest pad [13+ acres]. With the opening of Socorro's Subway in January, there are five [5] remaining pad sites: [all measurements are approximate] All pad sites offer incredible exposure to Interstate 25, I-25, and California Street, which is Socorro's main street.

PROPERTY HIGHLIGHTS

- In the center of Socorro New Mexico's commercial district
- Five [5] available pad sites
- Largest available pad [6.267 acres]
- Opening of Socorro Subway
- Incredible exposure to Interstate 25, I-25, and California Street

Site Plan

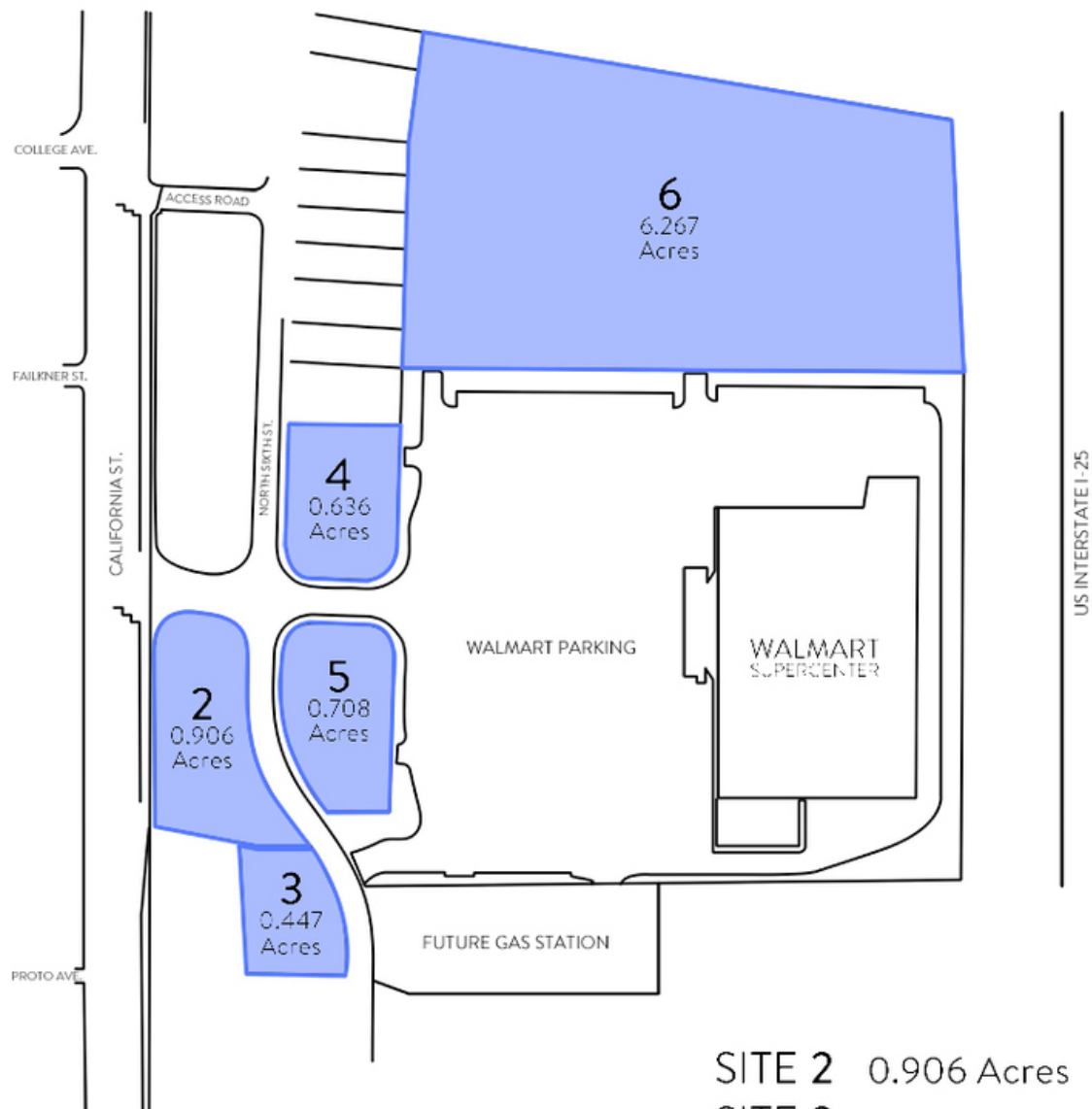

SITE 2	0.906 Acres
SITE 3	0.447 Acres
SITE 4	0.636 Acres
SITE 5	0.708 Acres
SITE 6	6.267 Acres

Land Lots

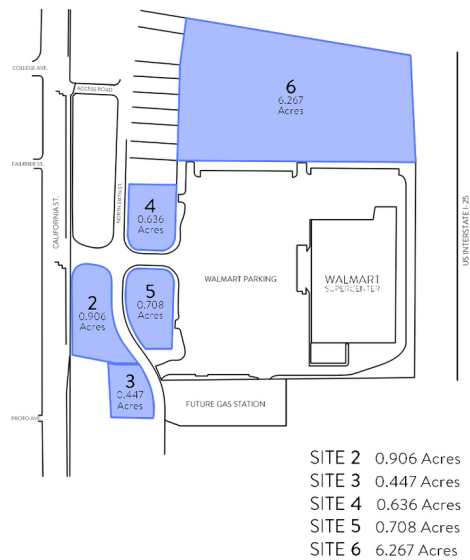

LOT #	SIZE (AC)	SALE PRICE	STATUS
2	0.906	\$600,000	Available
3	0.447	\$217,105	Available
4	0.636	\$311,672	Available
5	0.708	\$350,039	Available
6	6.267	\$2,700,720	Available

Location Maps



KEY FACTS

0

Population



Average Household Size

0.0

Median Age

\$0

Median Household Income

EDUCATION

N/A%

No High School Diploma



N/A%

High School Graduate



N/A%

Some College



N/A%

Bachelor's/Grad/Prof Degree

BUSINESS



29

Total Businesses



296

Total Employees

EMPLOYMENT

White Collar

Blue Collar

Services

0.0%

Unemployment Rate

INCOME



\$0

Median Household Income



\$0

Per Capita Income



\$0

Median Net Worth

Households By Income

The largest group: <\$15,000 (0.0%)

The smallest group: <\$15,000 (0.0%)

Indicator	Value	Difference	
<\$15,000	0.0%	-21.6%	
\$15,000 - \$24,999	0.0%	-16.9%	
\$25,000 - \$34,999	0.0%	-14.4%	
\$35,000 - \$49,999	0.0%	-14.6%	
\$50,000 - \$74,999	0.0%	-13.7%	
\$75,000 - \$99,999	0.0%	-7.3%	
\$100,000 - \$149,999	0.0%	-7.4%	
\$150,000 - \$199,999	0.0%	-3.2%	
\$200,000+	0.0%	-0.9%	

Bars show deviation from Socorro County

KEY FACTS

1,041

Population



Average
Household Size

33.9

Median Age

\$31,490

Median Household
Income

EDUCATION

18%

No High
School
Diploma



28%

High School
Graduate



26%

Some College



27%

Bachelor's/Grad/Prof
Degree

BUSINESS



186

Total Businesses



1,725

Total Employees

EMPLOYMENT



77%

White Collar



12%

Blue Collar



10%

Services

3.9%

Unemployment
Rate

INCOME



\$31,490

Median Household
Income



\$18,893

Per Capita Income



\$19,489

Median Net Worth

Households By Income

The largest group: <\$15,000 (22.0%)

The smallest group: \$200,000+ (0.2%)

Indicator	Value	Difference	
<\$15,000	22.0%	+0.4%	
\$15,000 - \$24,999	18.4%	+1.5%	
\$25,000 - \$34,999	13.6%	-0.8%	
\$35,000 - \$49,999	11.8%	-2.8%	
\$50,000 - \$74,999	16.8%	+3.1%	
\$75,000 - \$99,999	6.4%	-0.9%	
\$100,000 - \$149,999	6.2%	-1.2%	
\$150,000 - \$199,999	4.8%	+1.6%	
\$200,000+	0.2%	-0.7%	

Bars show deviation from
Socorro County

KEY FACTS

5,232

Population



2.1

Average Household Size

34.6

Median Age

\$31,460

Median Household Income

EDUCATION

20%

No High School Diploma



31%

High School Graduate



26%

Some College



24%

Bachelor's/Grad/Prof Degree

BUSINESS



286

Total Businesses



2,742

Total Employees

EMPLOYMENT



70%

White Collar



15%

Blue Collar



15%

Services

5.7%

Unemployment Rate

INCOME



\$31,460

Median Household Income



\$18,942

Per Capita Income



\$18,873

Median Net Worth

Households By Income

The largest group: <\$15,000 (23.2%)

The smallest group: \$200,000+ (0.4%)

Indicator	Value	Difference	
<\$15,000	23.2%	+1.6%	
\$15,000 - \$24,999	16.8%	-0.1%	
\$25,000 - \$34,999	14.0%	-0.4%	
\$35,000 - \$49,999	13.9%	-0.7%	
\$50,000 - \$74,999	14.4%	+0.7%	
\$75,000 - \$99,999	6.1%	-1.2%	
\$100,000 - \$149,999	7.1%	-0.3%	
\$150,000 - \$199,999	4.0%	+0.8%	
\$200,000+	0.4%	-0.5%	

Bars show deviation from Socorro County

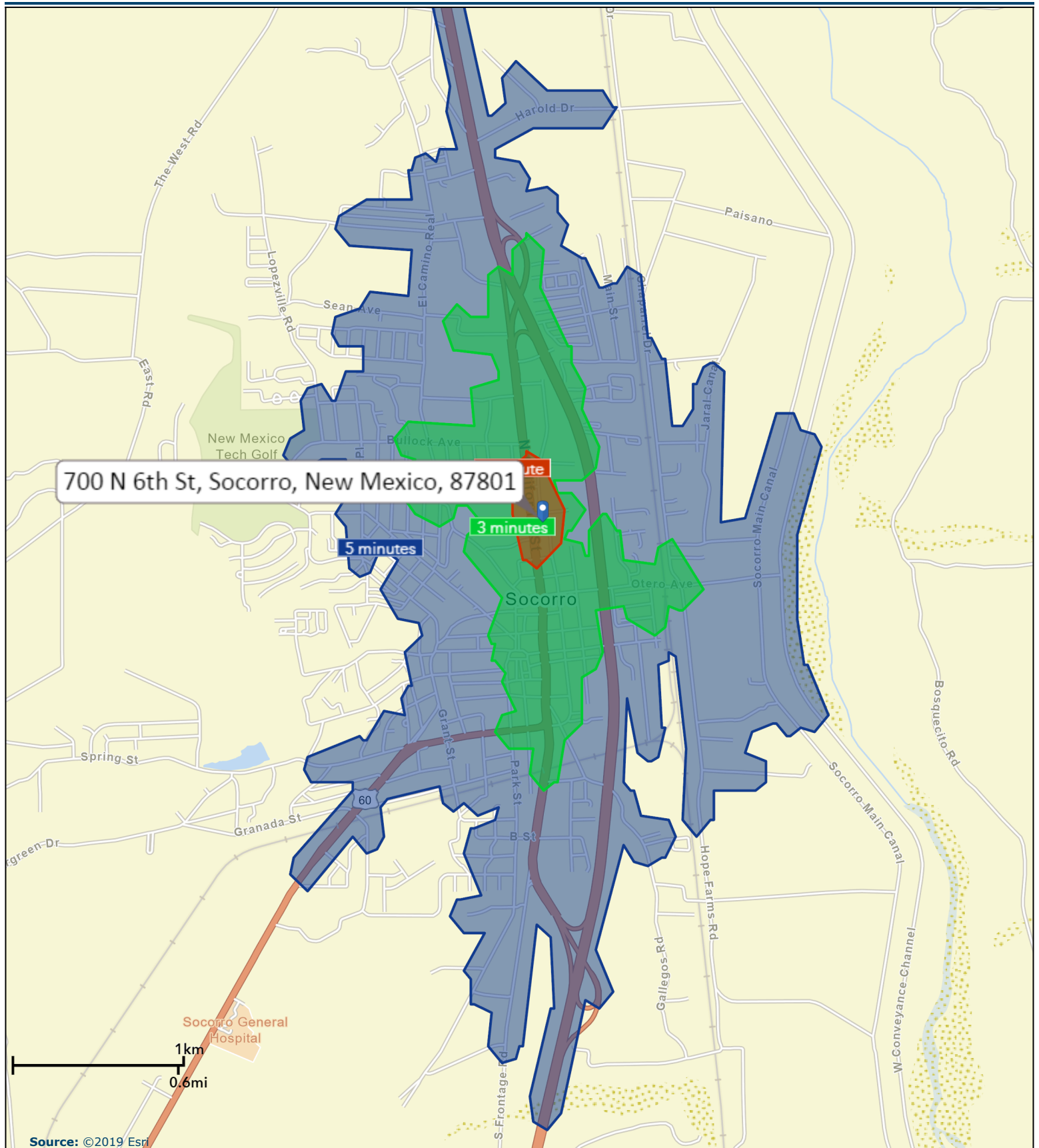

Traffic Count Map

700 N 6th St, Socorro, New Mexico, 87801
Drive Time: 1, 3, 5 minute radii

Prepared by Esri
Latitude: 34.06438
Longitude: -106.89176

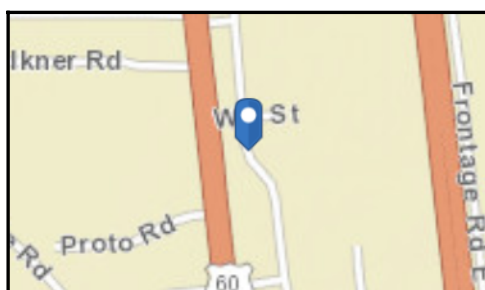
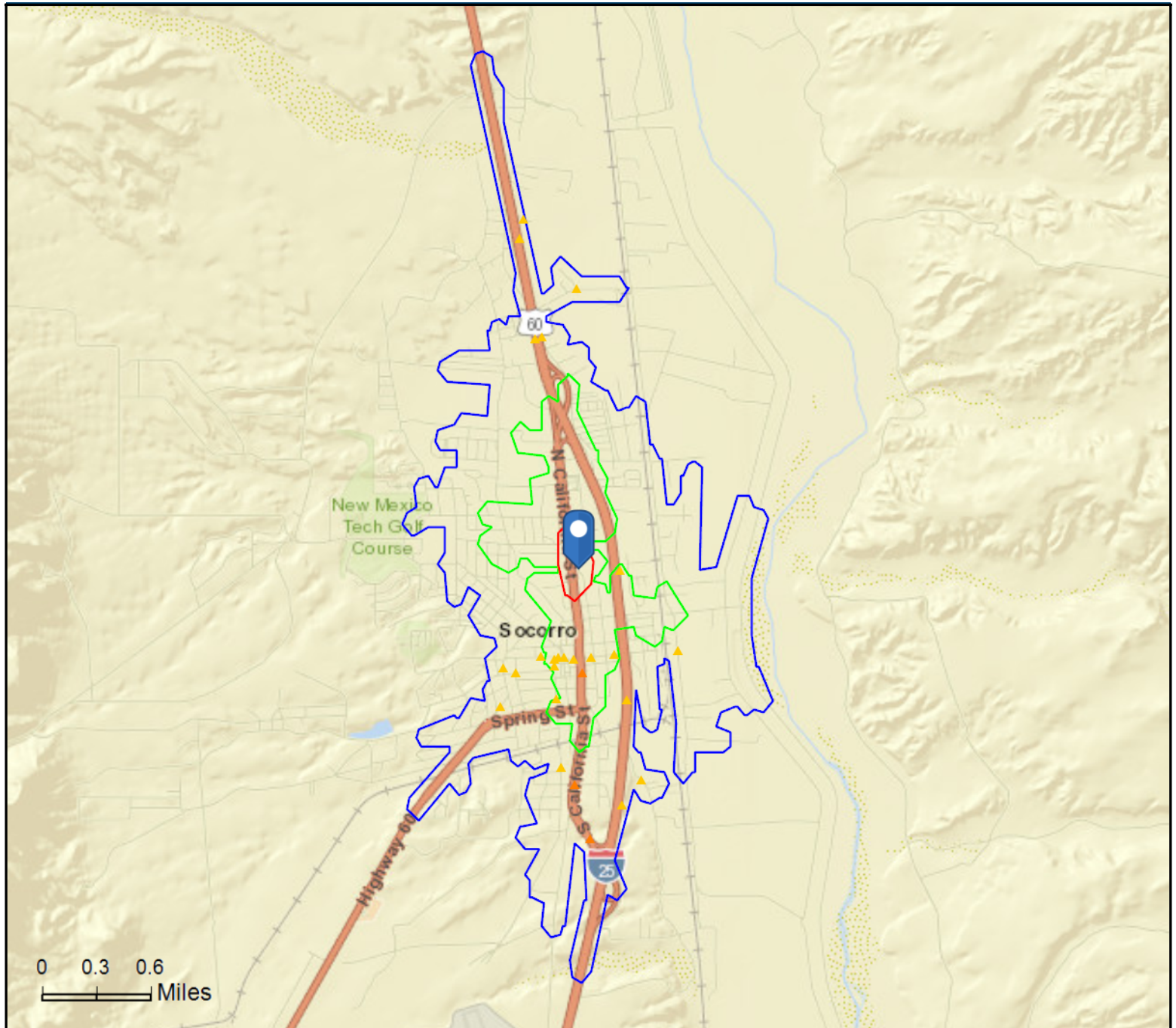

Average Daily Traffic Volume
 ▲ Up to 6,000 vehicles per day
 ▲ 6,001 - 15,000
 ▲ 15,001 - 30,000
 ▲ 30,001 - 50,000
 ▲ 50,001 - 100,000
 ▲ More than 100,000 per day



Source: ©2019 Kalibrate Technologies (Q3 2019).

February 26, 2020