

SKETCH/AREA TABLE ADDENDUM

SUBJECT INFO

File No.: This is not an appraisal. Parcel No.: Information provided by an appraiser will supercede this drawing
 Property Address: 1000 Eubank Blvd NE
 City: Albuquerque County: State: NM ZipCode: 87112
 Owner:
 Client: Christa Hamburger Client Address:
 Appraiser Name: Tom Schoneman Inspection Date: 01/25/2021

SKETCH

Prepared Exclusively For:
 Christa Hamburger
 Coldwell Banker

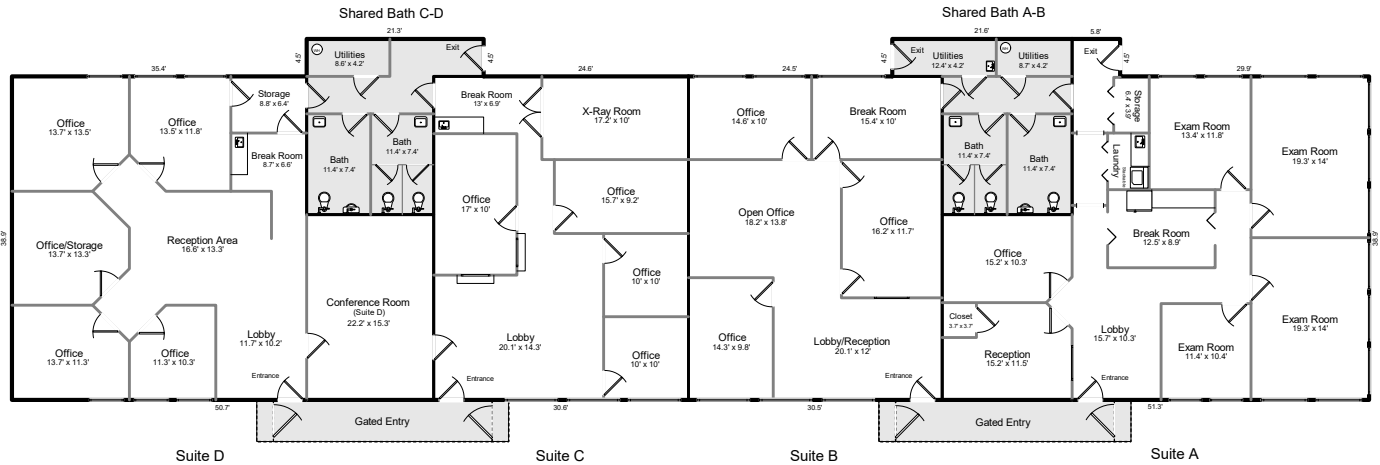

1000 Eubank Blvd NE Albuquerque, NM 87112	
Drawn by: Tom Schoneman 263-2973	
Suite A	1762.7 sf
Suite B	1186.5 sf
Bathroom A-B	356.2 sf
Suite C	1190.3 sf
Suite D	1718.3 sf
Bathroom C-D	349.8 sf
Total Building Area	6563.8 sf

All Room Sizes are estimated.
 This is not an appraisal. It is not intended to represent an appraiser's opinion.
 Greater ABQ Homes will not be liable for any discrepancies with an appraiser.
 This is a representation based on the opinion of the creator using RMS standards.
 This drawing may not be copied or reproduced without written consent from Greater ABQ Homes, LLC.

All square footage based on interior measurements.
 Ceiling height is 9' throughout.

Sketch by Apex Sketch

AREA CALCULATIONS SUMMARY						AREA CALCULATIONS BREAKDOWN				
Code	Description	Factor	Net Size	Perimeter	Net Totals	Name	Base x	Height x	Width =	Area
GBA0	Suite D	1.0	1718.3	179.2	1718.3	Suite D		38.9 x	35.4 =	1377.1
GBA5	Shared Bath A	1.0	356.2	85.4	356.2			22.3 x	15.3 =	341.2
GBA6	Shared Bath C	1.0	349.8	84.8	349.8	Suite C		16.6 x	6.0 =	99.6
GBA7	Suite A	1.0	1762.7	189.4	1762.7			22.3 x	6.0 =	133.8
GBA8	Suite B	1.0	1186.5	138.8	1186.5			38.9 x	24.6 =	956.9
GBA9	Suite C	1.0	1190.3	139.0	1190.3	Suite B		16.6 x	6.0 =	99.6
P/P	Gated Entry	1.0	151.5	70.6				24.5 x	16.6 =	406.7
	Gated Entry	1.0	151.5	70.6	303.0			30.5 x	22.3 =	680.2
						Suite A		43.4 x	5.8 =	251.7
								22.3 x	15.6 =	347.9
								38.9 x	29.9 =	1163.1
						Shared Bath A-		21.1 x	15.6 =	329.2
								6.0 x	4.5 =	27.0
						Shared Bath C-		21.3 x	4.5 =	95.8
								16.6 x	15.3 =	254.0
	Net BUILDING			(rounded)	6,564	15 total items			(rounded)	6,564