



# INDUSTRIAL FOR SALE/LEASE

Brand New Flex Units Coming Soon

**MAX GROVER, CCIM**  
616 890 7794  
[maxg@workwithMOXIE.com](mailto:maxg@workwithMOXIE.com)

[workwithMOXIE.com](http://workwithMOXIE.com)





# LISTING INFORMATION

2780 28<sup>th</sup> St SW, Wyoming, MI 49519



[workwithMOXIE.com](https://workwithMOXIE.com)

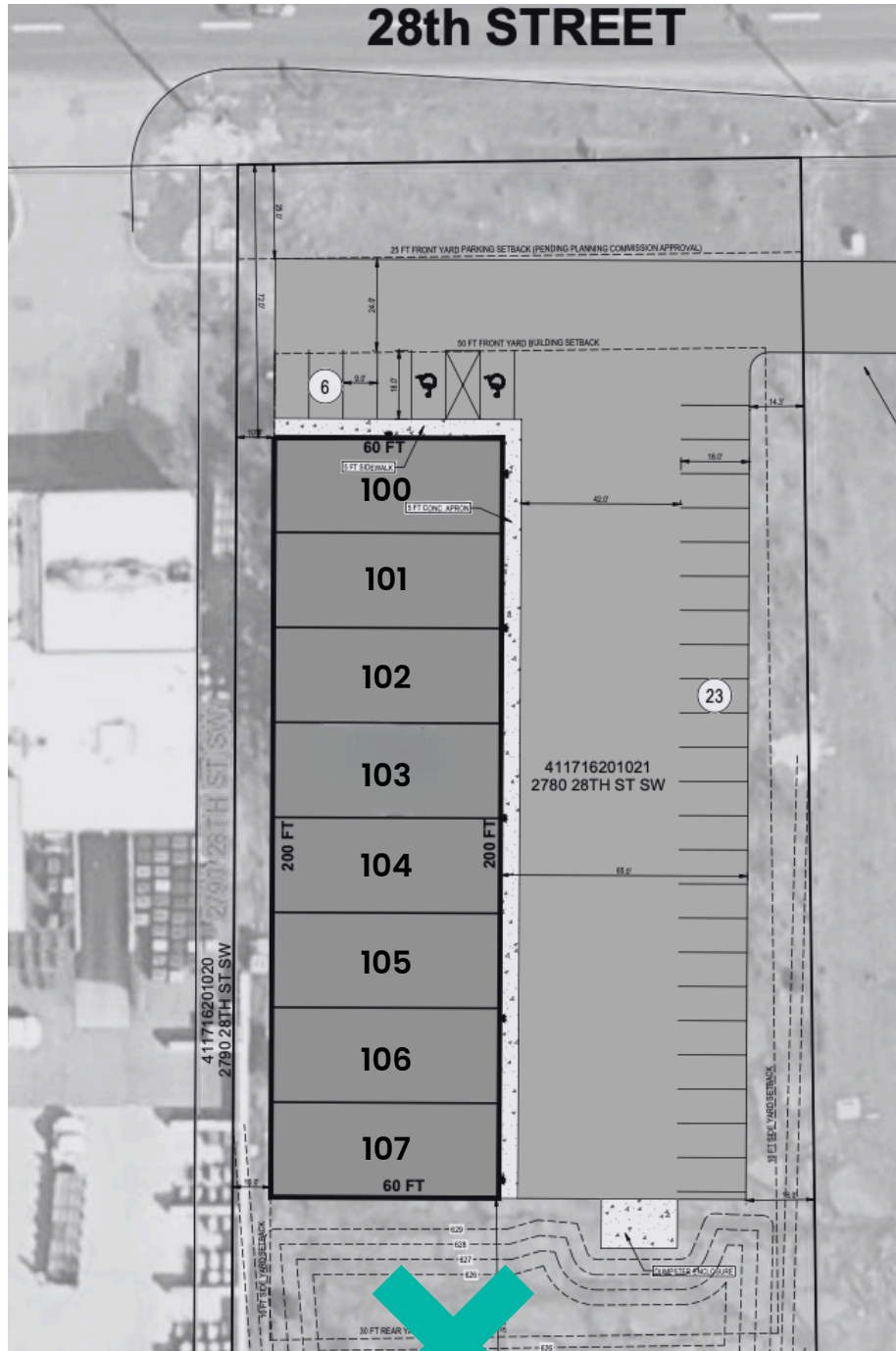

Unit Rate  
**\$1,995**  
Monthly

\*All leases NNN

## PRICING

Unit Size  
**1,500**  
25'x 60'

Square Feet



[workwithMOXIE.com](http://workwithMOXIE.com)



## PRIME LOCATION

Located along the high-traffic 28th Street (M-11) corridor in Wyoming, Michigan, 2780 28th St SW sits within a well-established and active commercial and industrial node. The property is surrounded by a strong mix of contractor services, light manufacturing, warehousing, and logistics users, creating a business-friendly environment with built-in synergy. The site offers excellent regional connectivity, with immediate access to Chicago Drive and convenient routes to I-196 and M-6, providing efficient transportation links to Grand Rapids, Holland, and key West Michigan markets.



## BUILDING HIGHLIGHTS

1 WEST ELEVATION  
A.2 1/8" = 1'-0"

- ✕ 18' Clear Heights.
- ✕ 14' x 14' Overhead Doors
- ✕ Transom windows on overhead doors and warehouse
- ✕ Built in 2026 energy codes for enhanced energy savings

## Versatile Layout

25'x60' floor plans with 16' ceilings and 14' overhead doors provide a rare, highly versatile flex space suitable for a wide range of uses.

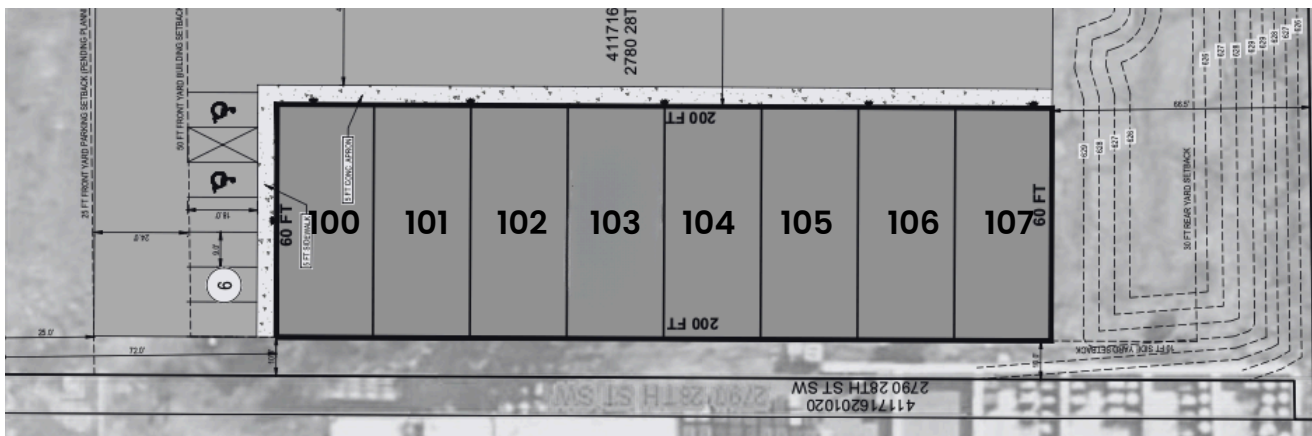

[workwithMOXIE.com](http://workwithMOXIE.com)





**IX**

[workwithMOXIE.com](http://workwithMOXIE.com)





[workwithMOXIE.com](https://workwithMOXIE.com)





**IX**

[workwithMOXIE.com](http://workwithMOXIE.com)

# CONTACT

MOXIE IS READY TO MOVE YOU FORWARD.



# MOXIE

3437 Eastern Ave SE, Grand Rapids, MI 49508

**MAX GROVER, CCIM**

616 890 7794

[maxg@workwithMOXIE.com](mailto:maxg@workwithMOXIE.com)

MOXIE Holdings, LLC DBA MOXIE Real Estate + Development (hereinafter referred to as "MOXIE") has prepared this Offering Memorandum (the "Memorandum") for informational purposes only. The information contained herein has been obtained from sources believed to be reliable; however, MOXIE makes no representations or warranties, express or implied, as to the accuracy or completeness of such information. All potential investors, tenants, buyers and/ or recipients of this Memorandum are hereby notified to conduct their own independent due diligence and verification of all information contained within. MOXIE shall not be liable for any errors or omissions in the information, or for any damages (whether direct, indirect, consequential, incidental, special, punitive, or otherwise) arising out of or in connection with the furnishing, use of, or reliance upon this Memorandum. This Memorandum is not intended to be, and should not be construed as, an offer to sell or a solicitation of an offer to buy any security or interest in any real estate. This Memorandum is presented in good faith and to the best of MOXIE's knowledge and understanding.