



SIGNATURE ASSOCIATES
KNOW SIGNATURE | KNOW RESULTS

Office For Lease

Property Name:
Location: 6100 Dixie Highway
City, State: Clarkston, MI
Cross Streets: Maybee Road
County: Oakland

BUILDING SIZE / AVAILABILITY

Total Building Sq. Ft.: 8,100	Total Available Sq. Ft.: 1,600	Class: B
Typical Floor Plate: 4,050	Min / Max Cont. Sq. Ft.: 1,600 / 1,600	No. of Floors: 2

PROPERTY INFORMATION

Zoning: BI	Parking: 37
Exterior Construction: Brick	Power: N/A
Structural System: Steel	Security Systems: No
Roof: Shingle	Restrooms: Yes
Floors / Covering: Concrete / N/A	Sprinklers: No
Heating: HVAC	Signage: Monument
Air-Conditioning: Yes	Delivery Area: N/A
Ceiling Height: 9'	Date Available: Immediate
Year Built: 2002	Acreage: 0.98

Current Tenants:

PRICING INFORMATION

Lease Rate: \$19.50 NNN	Rentable/Usable: N/A	Impr Allowance: N/A
Lease Term: 3 Years	Total Taxes:	Deposit: N/A
Options: N/A	Parcel #: 08-33-302-006	

Tenant Responsibility: NNN Charges

Comments: Beautiful suite with dedicated side entrance. Ample parking. Modern building and well maintained property. Kitchenette and fireplace in suite.

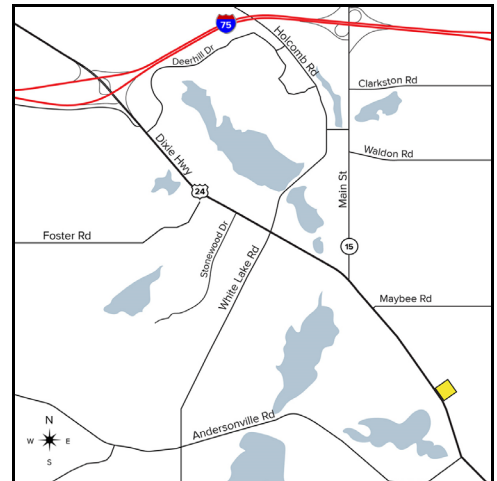

Broker: SIGNATURE ASSOCIATES

Agent(s):

Peter Vanderkaay, (248) 359-3837, pvanderkaay@signatureassociates.com