

300 E. MILWAUKEE AVENUE
DETROIT, MICHIGAN

INDUSTRIAL FOR SALE
9,000 Square Feet Available



**SIGNATURE
ASSOCIATES**
KNOW SIGNATURE | KNOW RESULTS

SUBSTANTIAL PRICE REDUCTION!



PROPERTY FEATURES

- 9,000 square feet available
- 12' – 22' clear height
- (1) 10' x 12' grade level door
- Zoned M3
- Available immediately
- Easy access to I-75 and I-94
- Available for individual sale or as part of an 8-property portfolio totaling 30,700 square feet and 1.21 acres
- Sale Price: \$500,000 (\$55.56/sq. ft.)



For more information, please contact:

STEVE GORDON

(248) 948 0101

sgordon@signatureassociates.com

CHRIS MONSOUR

(248) 948 0107

cmonsour@signatureassociates.com

JOE STACK

(248) 359 0615

jstack@signatureassociates.com

300 E. Milwaukee Avenue – Detroit, Michigan

Industrial For Sale

9,000
Square Feet
AVAILABLE

Site Plan

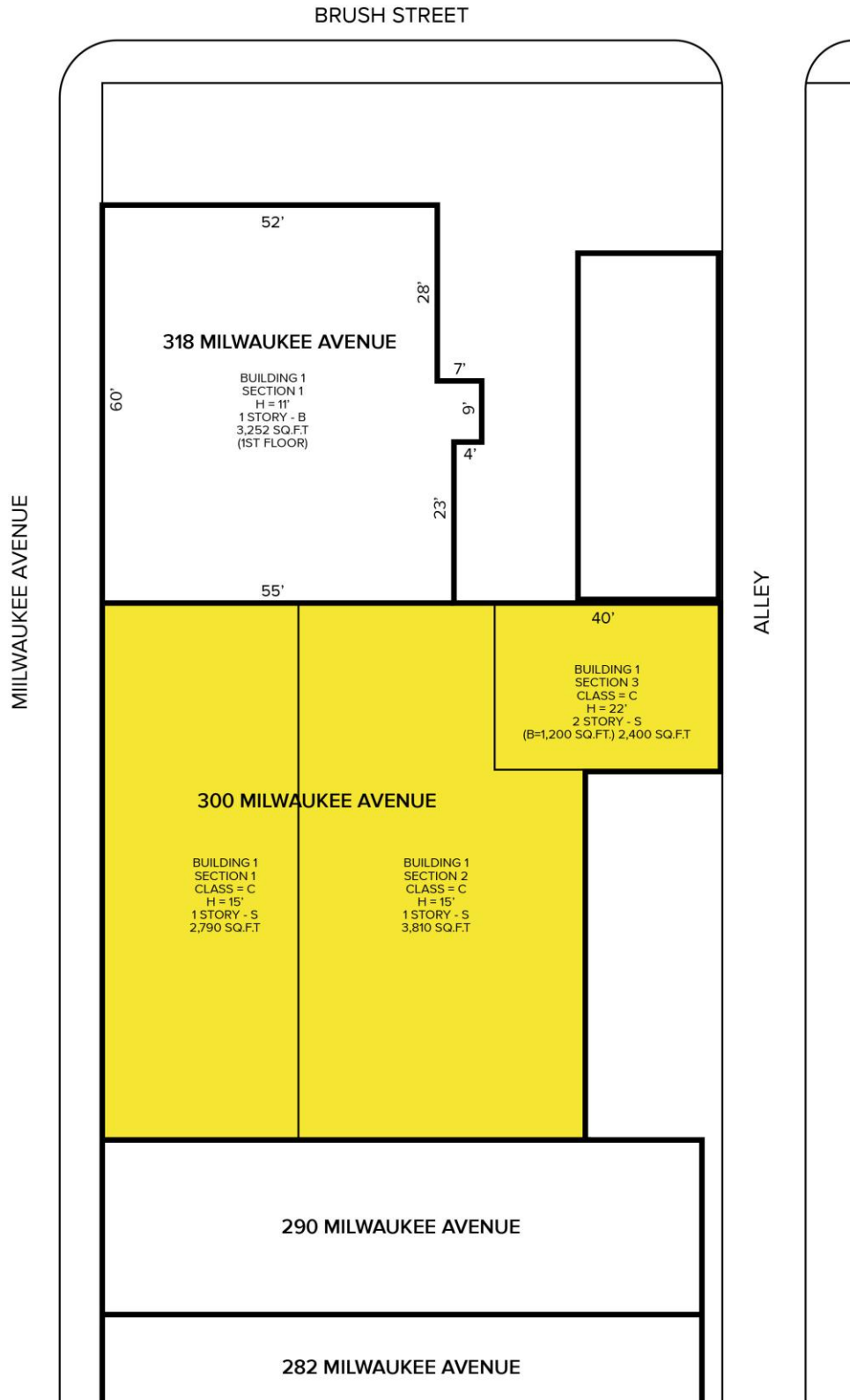

For more information, please contact:

STEVE GORDON
(248) 948 0101

CHRIS MONSOUR
(248) 948 0107

JOE STACK
(248) 359 0615

SIGNATURE ASSOCIATES
One Towne Square, Suite 1200
Southfield, MI 48076
www.signatureassociates.com

300 E. Milwaukee Avenue – Detroit, Michigan

Industrial For Sale

9,000
Square Feet
AVAILABLE

Aerial



For more information, please contact:

STEVE GORDON
(248) 948 0101

CHRIS MONSOUR
(248) 948 0107

JOE STACK
(248) 359 0615

SIGNATURE ASSOCIATES
One Towne Square, Suite 1200
Southfield, MI 48076
www.signatureassociates.com