



Industrial For Sale

Property Name:
Location: 300 E. Milwaukee Avenue
City, State: Detroit, MI
Cross Streets: Brush Street
County: Wayne
Zoning: M3

BUILDING SIZE / AVAILABILITY

| | | | |
|--------------------------------|-------|----------------------------------|-------|
| Building Type: | Built | Mezzanine: | N/A |
| Total Building Sq. Ft.: | 9,000 | Available Shop Sq. Ft.: | 9,000 |
| Available Sq. Ft.: | 9,000 | Available Office Sq. Ft.: | 0 |
| | | Office Dim: | N/A |
| | | Shop Dim: | N/A |

PROPERTY INFORMATION

| | | | |
|-------------------------------|----------------|-------------------------|----------|
| Freestanding: | Yes | Year Built: | 1947 |
| Clear Height: | 12' - 22' | Rail: | No |
| Grade Level Door(s): | 1: 10 x 12 | Security: | No |
| Truckwells or Docks: | 0 | Interior: | N/A |
| Exterior Construction: | N/A | Lighting: | N/A |
| Structural System: | N/A | Bay Sizes: | N/A |
| Air-Conditioning: | N/A | Restrooms: | N/A |
| Heating: | Gas Forced Air | Cranes: | No |
| Availability: | Immediately | Parking: | N/A |
| Power (Amps/Volts): | N/A | Roof: | N/A |
| | | Floors: | N/A |
| | | Floor Drains: | No |
| | | Acreage: | 0.210 |
| | | Land Dimensions: | 90 x 100 |

PRICING INFORMATION

| | | | | | |
|--------------------|--------------------------|-----------------|-----|--------------------|-----|
| Sale Price: | \$500,000 (\$55.56/sqft) | Deposit: | N/A | TD: | N/A |
| Taxes: | \$3,643.49 (2025) | Options: | N/A | Assessor #: | N/A |
| Parcel #: | 01001964-6 | | | | |

COMMENTS

Substantial price reduction! Highly motivated owner seeking a quick close. Available for individual sale or as part of an 8-property portfolio totaling 30,700 square feet and 1.21 acres.

Industrial building with easy access to I-94 and I-75.

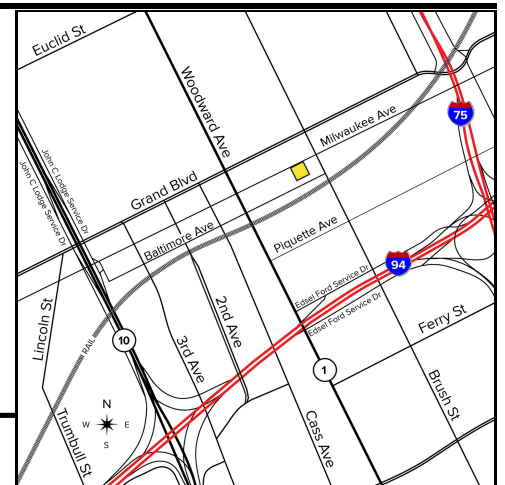

Broker: SIGNATURE ASSOCIATES

Agent(s):

Steve Gordon, (248) 948-0101, sgordon@signatureassociates.com
 Chris Monsour, (248) 948-0107, cmonsour@signatureassociates.com
 Joe Stack, (248) 359-0615, jstack@signatureassociates.com

Information is subject to verification and no liability for errors or omissions is assumed. Price and terms are subject to modification.