



LAND For Sale

Location: 335 E. Milwaukee Avenue
Side of Street: North
City: Detroit, MI
Cross Streets: Brush Street
County: Wayne

Acreage:	0.17	Improvements:	N/A
Zoning:	M3	Dimensions:	45.00 x 160.00

UTILITIES

Sanitary Sewer:	Yes	Gas:	Yes
Storm Sewer:	Yes	Outside Storage:	No
Water:	Yes	Rail Siding:	No

ADJACENT LAND

North:	East:
South:	West:

PRICING INFORMATION

Asking Price:	\$100,000.00	Parcel #:	01001918
Per Acre:		Assessor Number:	N/A
Per SqFt :		Taxes:	\$508.52 (2025)

TRAFFIC INFORMATION

Yr: 2025	Count: 16,725	E. Grand Blvd. E. of Woodward Ave.
Yr: 2025	Count: 17,993	E. Grand Blvd. W. of Woodward Ave
Yr: 2025	Count: 13,773	Woodward Ave. S. of E. Grand Blvd.
Yr: 2025	Count: 11,554	Woodward Ave. N. of E. Grand Blvd.

DEMOGRAPHICS

	Population	Median HH Income
1 Mile Radius	16,714	\$43,682
3 Mile Radius	142,153	\$43,793
5 Mile Radius	327,828	\$43,760

Comments: Substantial price reduction! Highly motivated owner seeking a quick close. Available for individual sale or as part of an 8-property portfolio totaling 30,700 square feet and 1.21 acres.

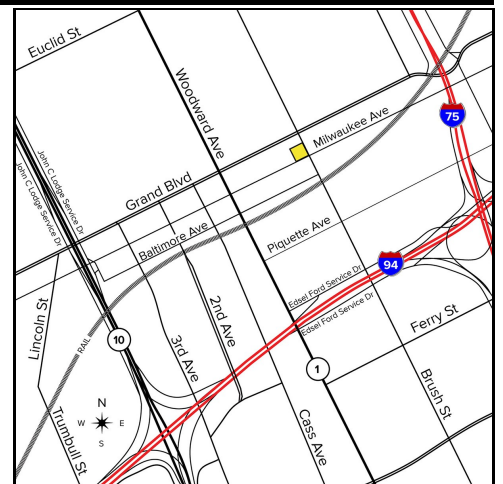

Broker: SIGNATURE ASSOCIATES

Agent(s):

Steve Gordon, (248) 948-0101, sgordon@signatureassociates.com
 Chris Monsour, (248) 948-0107, cmonsour@signatureassociates.com
 Joe Stack, (248) 359-0615, jstack@signatureassociates.com

Information is subject to verification and no liability for errors or omissions is assumed. Price and terms are subject to modification.