

14492 - 14500 SHELDON RD  
PLYMOUTH, MICHIGAN

OFFICE FOR LEASE  
6,100 Square Feet Available



**SIGNATURE  
ASSOCIATES**  
KNOW SIGNATURE | KNOW RESULTS

## PLYMOUTH EXECUTIVE PARK



# REDUCED RENTAL RATE

## PROPERTY FEATURES

- Reduced Lease Rate: ~~\$12.50~~ \$10.95/sq.ft. NNN
- 6,100 square foot suites available
- Convenient access to M-14, I-275 and I-96
- Attractive leasehold improvements
- New LED lighting throughout
- Abundant parking
- Available immediately

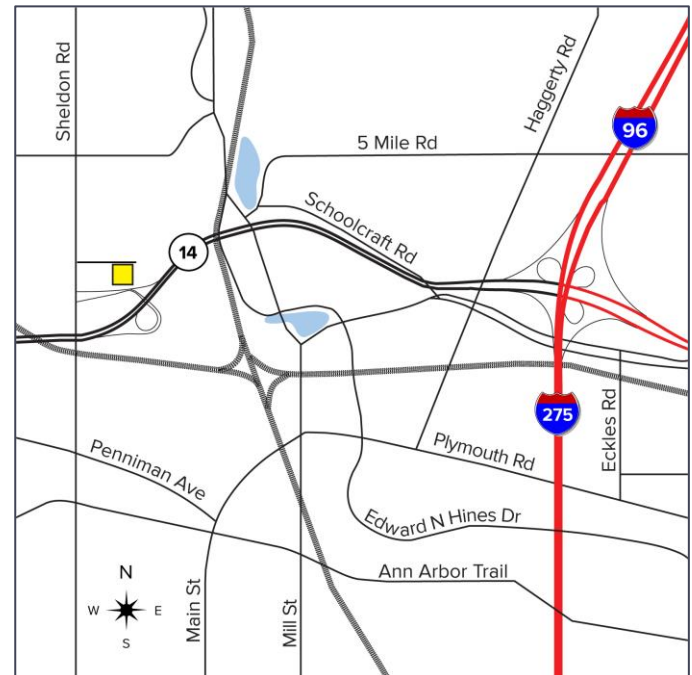

For more information, please contact:

**DAVE GREEN**  
(248) 948 4184  
dgreen@signatureassociates.com

**SIGNATURE ASSOCIATES**  
One Towne Square, Suite 1200  
Southfield, MI 48076  
www.signatureassociates.com

Information is subject to verification and no liability for errors or omissions is assumed. Price is subject to change and listing withdrawal.

# 14492 - 14500 Sheldon Road - Plymouth, Michigan

Office For Lease

6,100  
Square Feet  
AVAILABLE

14496 Sheldon  
Suite 240

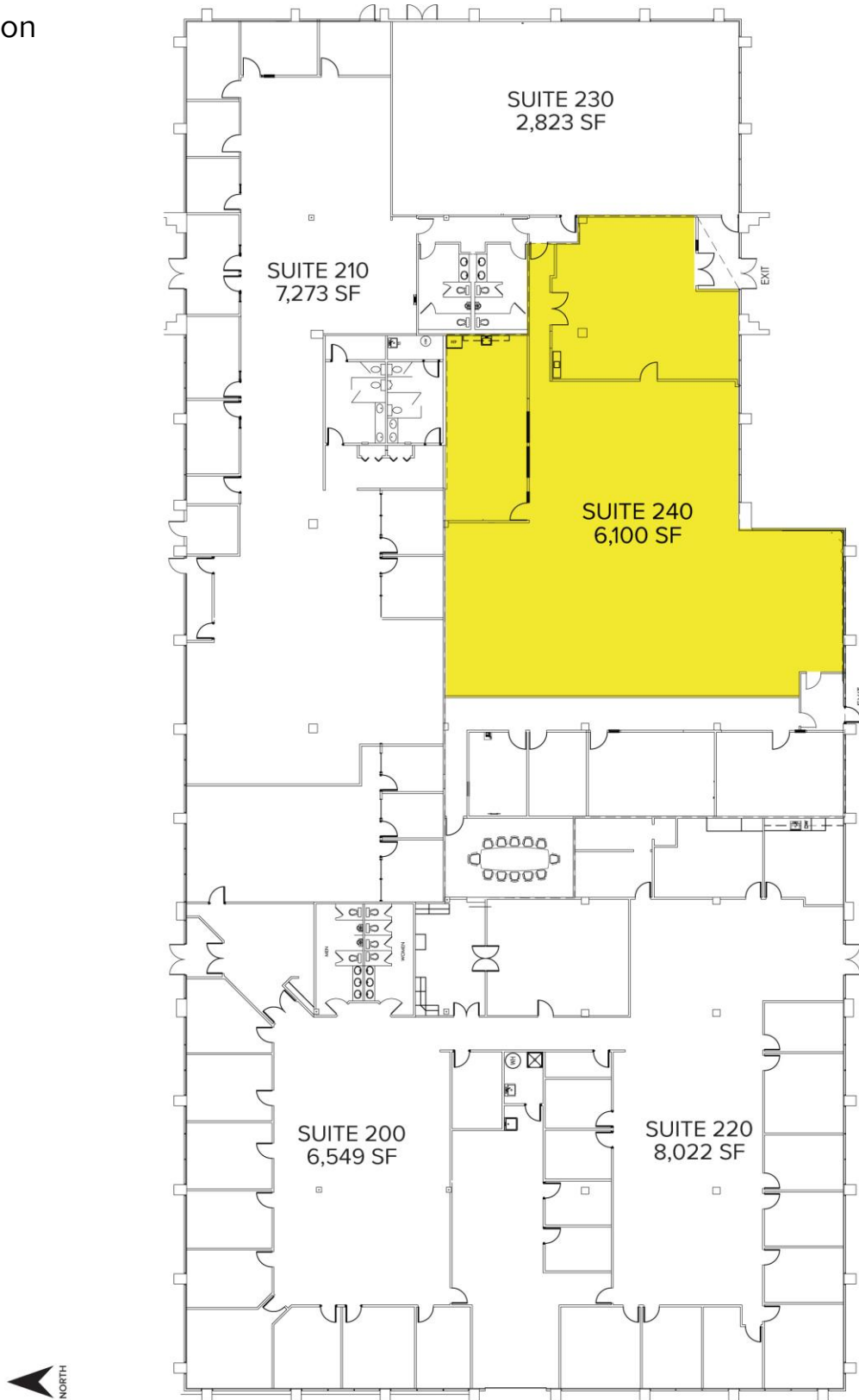

For more information, please contact:

**DAVE GREEN**  
(248) 948 4184  
dgreen@signatureassociates.com

**SIGNATURE ASSOCIATES**  
One Towne Square, Suite 1200  
Southfield, MI 48076  
www.signatureassociates.com