

**210 MECHANIC STREET - FRONT
WATERVILLE, OH 43566**

**OFFICE/WAREHOUSE BUILDING FOR LEASE
1,600 Square Feet Office Space Available**



**SIGNATURE
ASSOCIATES**
KNOW SIGNATURE | KNOW RESULTS

FULL-SERVICE COMMERCIAL REAL ESTATE



GENERAL INFORMATION

Lease Rate:	\$9.00/SF + \$185/mo- electric/water/sewer/gas
Space Available:	1,600 SF
Total Available Space:	1,600 SF
Building Size:	45,250 SF
Office Size:	3,200 SF
Year Constructed:	1921 (1974- subject space)
Condition:	Good
Acreage:	1.97 Acres
Closest Cross Street:	US 24 (Anthony Wayne Trail)
County:	Lucas
Zoning:	Commercial
Parking:	40 shared spaces – In front of the loading docks & behind subject space
Curb Cuts:	2 – Mechanic Street & 2 nd Street
Street:	2 lane, 2 way

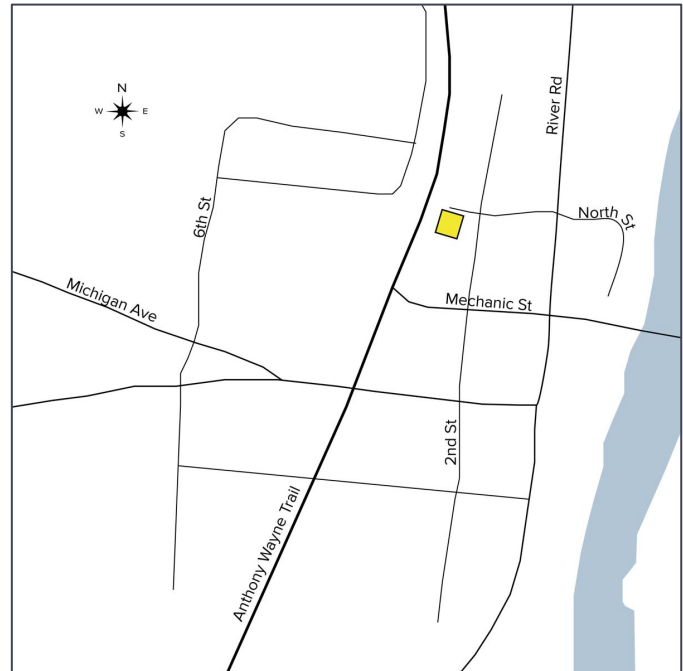

For more information, please contact:

MEGAN MALCZEWSKI, CCIM, SIOR
(419) 215 1008
mmalczewski@signatureassociates.com

ROBERT P. MACK, CCIM, SIOR
(419) 466 6225
rpmack@signatureassociates.com

SIGNATURE ASSOCIATES
Four SeaGate, Suite 608
Toledo, Ohio 43604
www.signatureassociates.com

Information is subject to verification and no liability for errors or omissions is assumed. Price is subject to change and listing withdrawal.

210 Mechanic Street, Waterville, OH 43566

Office Building For Lease

1,600
Square Feet
AVAILABLE

BUILDING SPECIFICATIONS

Exterior Walls:	Mainly metal & block
Structural System:	Block & steel
Roof:	Rubber & metal
Floors:	Concrete
Stories:	1
Ceiling Height:	8' ± Office 22' ± Warehouse
Basement:	No
Heating:	GFA
Air Conditioning:	No
Power:	200 amp Office 1200 amp/240V Warehouse
Restrooms:	2 in office
Security System:	No
Sprinklers:	No
Signage:	Per code
Lighting:	LED motion-sensored

UTILITIES

Electric:	Toledo Edison
Gas:	Waterville Gas & Oil Co.
Water:	City of Toledo
Sanitary Sewer:	City of Toledo
Storm Sewer:	City of Toledo

BUILDING INFORMATION

Current Occupant:	Vacant - Office
Occupancy Date:	Upon lease execution
Other Occupants:	None
Sign on Property:	Yes
Showing Instructions:	Contact listing agents

LEASE DETAILS

Term:	Negotiable
Security Deposit:	Equal to 1 month's rent
Options:	Negotiable
Tenant Responsible For:	Utilities – office space

Comments:

- The property encompasses nearly the entire block, and it is surrounded by commercial/retail.
- Located at the heart of downtown Waterville at the corner of "Main & Main".
- The subject office space is the 1,600 square feet located in the front building off of Mechanic Street.

For more information, please contact:

MEGAN MALCZEWSKI, CCIM, SIOR
(419) 215 1008
mmalczewski@signatureassociates.com

ROBERT P. MACK, CCIM, SIOR
(419) 466 6225
rpmack@signatureassociates.com

SIGNATURE ASSOCIATES
Four SeaGate, Suite 608
Toledo, Ohio 43604
www.signatureassociates.com

Information is subject to verification and no liability for errors or omissions is assumed. Price is subject to change and listing withdrawal.

210 Mechanic Street, Waterville, OH 43566
Office Building For Lease

1,600
Square Feet
AVAILABLE

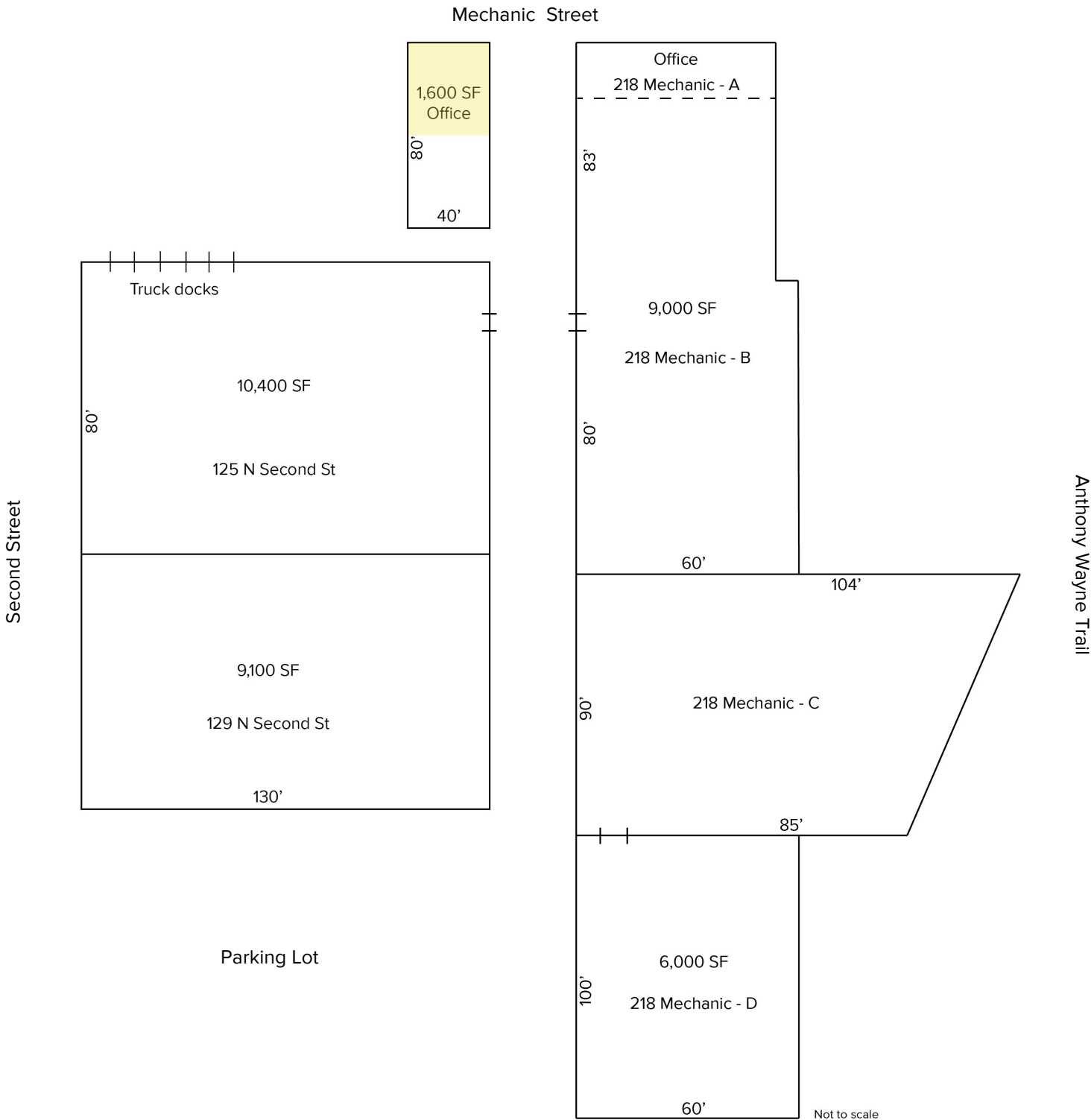

210 Mechanic Street, Waterville, OH 43566

Office Building For Lease

1,600
Square Feet
AVAILABLE



For more information, please contact:

MEGAN MALCZEWSKI, CCIM, SIOR
(419) 215 1008
mmalczewski@signatureassociates.com

ROBERT P. MACK, CCIM, SIOR
(419) 466 6225
rpmack@signatureassociates.com

SIGNATURE ASSOCIATES
Four SeaGate, Suite 608
Toledo, Ohio 43604
www.signatureassociates.com

Information is subject to verification and no liability for errors or omissions is assumed. Price is subject to change and listing withdrawal.

210 Mechanic Street, Waterville, OH 43566

Office Building For Lease

1,600
Square Feet
AVAILABLE



For more information, please contact:

MEGAN MALCZEWSKI, CCIM, SIOR
(419) 215 1008
mmalczewski@signatureassociates.com

ROBERT P. MACK, CCIM, SIOR
(419) 466 6225
rpmack@signatureassociates.com

SIGNATURE ASSOCIATES
Four SeaGate, Suite 608
Toledo, Ohio 43604
www.signatureassociates.com

Information is subject to verification and no liability for errors or omissions is assumed. Price is subject to change and listing withdrawal.