

9401 GENERAL DRIVE
PLYMOUTH, MICHIGAN

OFFICE FOR LEASE
2,117 & 2,449 Square Feet Available



**SIGNATURE
ASSOCIATES**
KNOW SIGNATURE | KNOW RESULTS

LILLEY EXECUTIVE PLAZA II



PROPERTY FEATURES

- 2,117 & 2,449 square foot suite available
- Well maintained building with on-site management
- Ample parking
- Great location near downtown Plymouth
- Close to M-14, I-96 and I-275
- Lease Rate: \$16.50/sf MG



For more information, please contact:

JASON STOUGH
(248) 948 4180

jstough@signatureassociates.com

DAVE GREEN
(248) 948 4184

dgreen@signatureassociates.com

SIGNATURE ASSOCIATES
One Towne Square, Suite 1200
Southfield, MI 48076
www.signatureassociates.com

9401 General Drive - Plymouth, Michigan

Office For Lease

2,117 & 2,449
Square Feet
AVAILABLE

Site Plan



For more information, please contact:

JASON STOUGH

(248) 948 4180

jstough@signatureassociates.com

DAVE GREEN

(248) 948 4184

dgreen@signatureassociates.com

SIGNATURE ASSOCIATES

One Towne Square, Suite 1200

Southfield, MI 48076

www.signatureassociates.com

Floor Plans

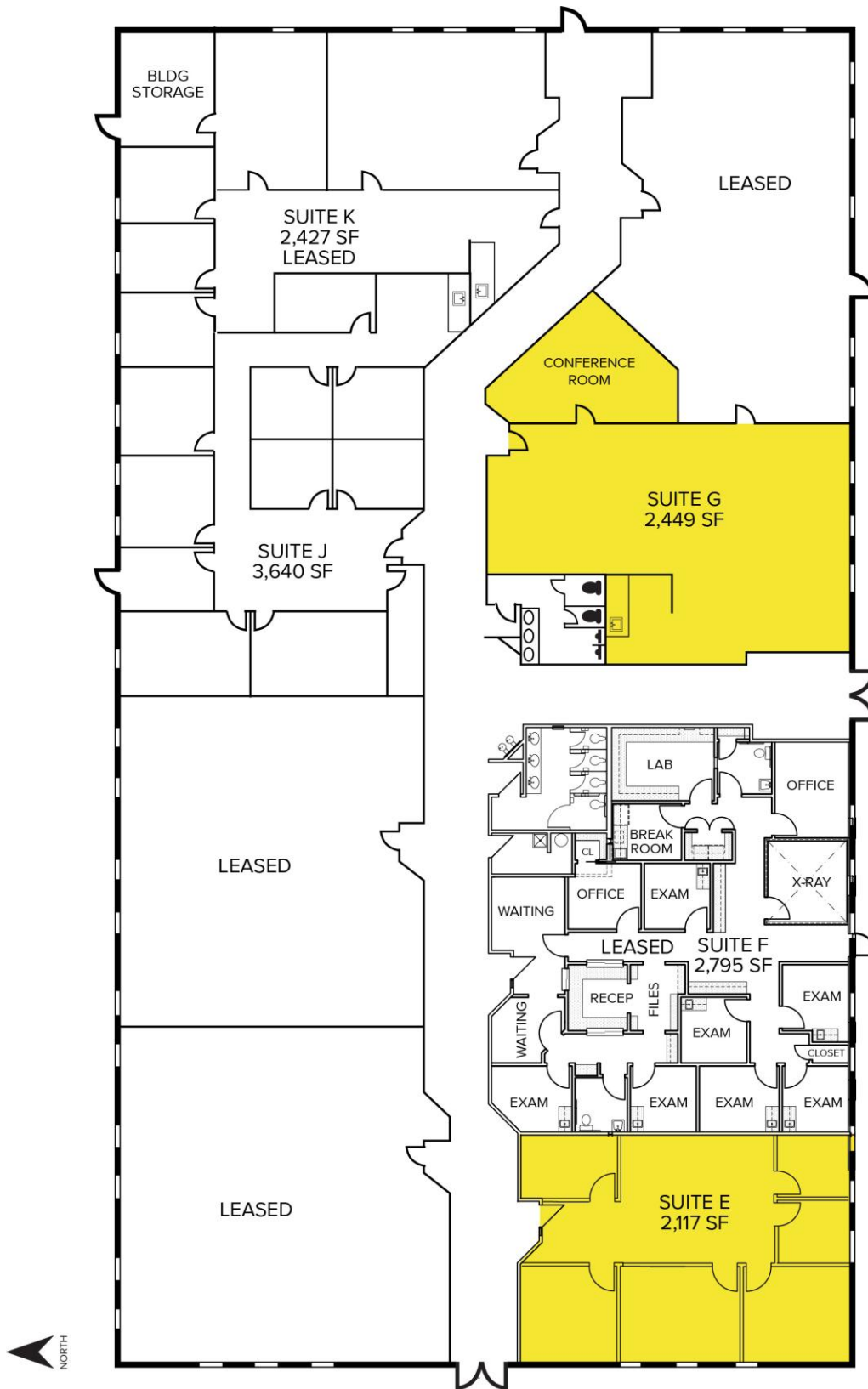

For more information, please contact:

JASON STOUGH

(248) 948 4180

jstough@signatureassociates.com

DAVE GREEN

(248) 948 4184

dgreen@signatureassociates.com

SIGNATURE ASSOCIATES

One Towne Square, Suite 1200

Southfield, MI 48076

www.signatureassociates.com