

880 W. JEFFERSON AVENUE
TRENTON, MI

INDUSTRIAL FOR SALE OR LEASE
24,205 Square Feet Available



**SIGNATURE
ASSOCIATES**
KNOW SIGNATURE | KNOW RESULTS



PROPERTY FEATURES

- 24,205 square feet available
- 4,205 sq. ft. of office space
- Zoned industrial/marijuana cultivation and processing approved
- Excellent manufacturing building with warehouse and 2,500 sq. ft. second floor office
- 10'-18' clear height
- (2) grade level doors, (1) interior truckwell
- Heavy power
- Built in 1980, updated in 2016
- 21 parking spaces
- Sale Price: \$1,100,000 (\$45.45/sq. ft.)
- Lease Rate: \$6.95/sq. ft. NNN



For more information, please contact:

JUSTIN GAFFREY

(248) 799 3143

jgaffrey@signatureassociates.com

BRAD VIERGEVER

(248) 799 3146

bviergever@signatureassociates.com

SIGNATURE ASSOCIATES

One Towne Square, Suite 1200

Southfield, MI 48076

www.signatureassociates.com

800 W. Jefferson Avenue – Trenton, Michigan

Industrial For Sale or Lease

24,205
Square Feet
AVAILABLE

Site Plan

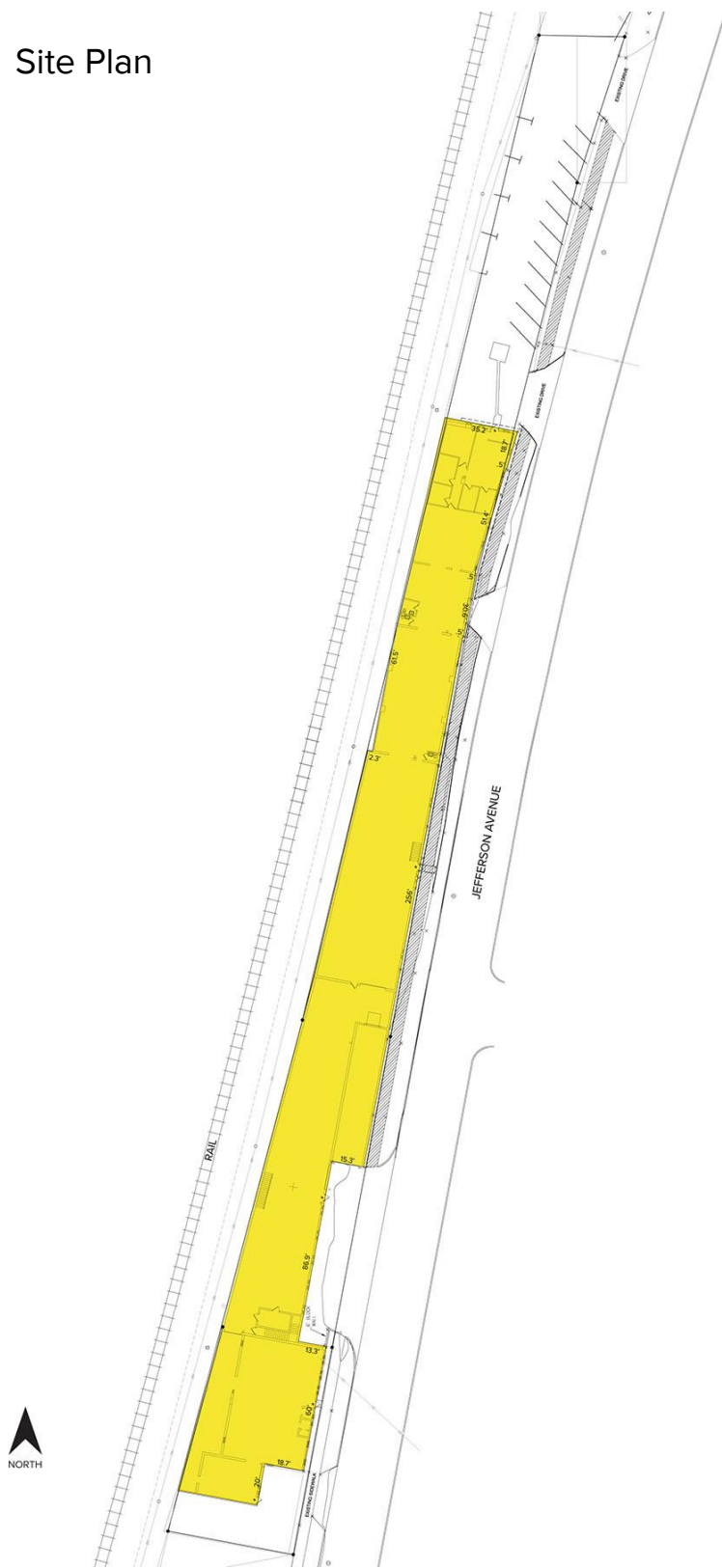

Floor Plan

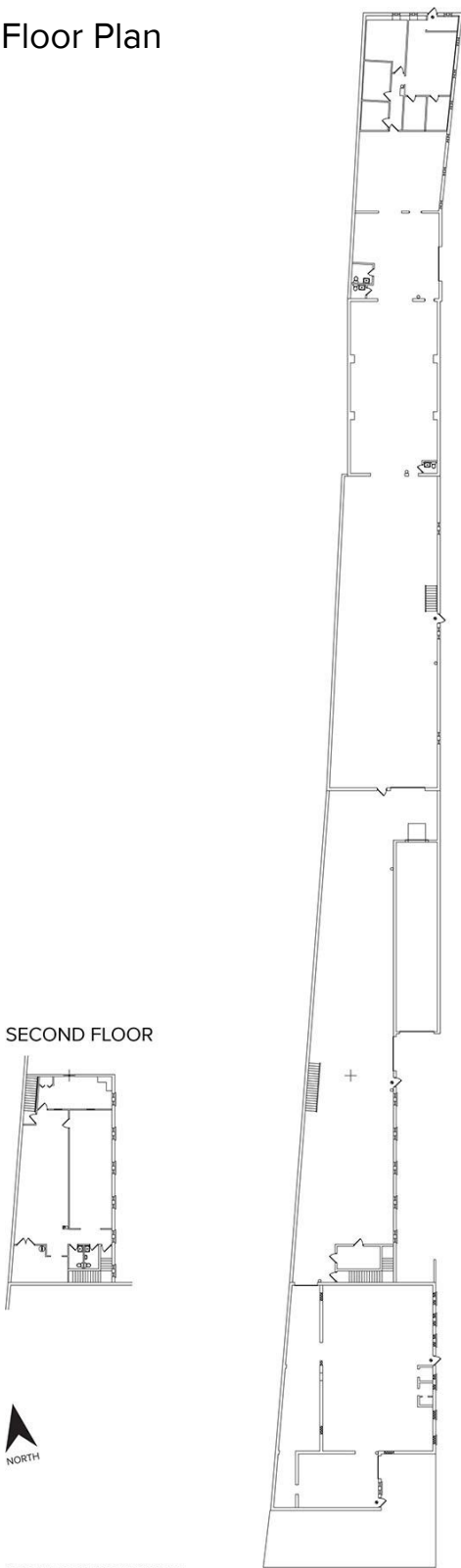

For more information, please contact:

JUSTIN GAFFREY
(248) 799 3143
jgaffrey@signatureassociates.com

BRAD VIERGEVER
(248) 799 3146
bviergever@signatureassociates.com

SIGNATURE ASSOCIATES
One Towne Square, Suite 1200
Southfield, MI 48076
www.signatureassociates.com

800 W. Jefferson Avenue – Trenton, Michigan

Industrial For Sale or Lease

24,205
Square Feet
AVAILABLE

Aerial



For more information, please contact:

JUSTIN GAFFREY

(248) 799 3143

jgaffrey@signatureassociates.com

BRAD VIERGEVER

(248) 799 3146

bviergever@signatureassociates.com

SIGNATURE ASSOCIATES

One Towne Square, Suite 1200

Southfield, MI 48076

www.signatureassociates.com

Information is subject to verification and no liability for errors or omissions is assumed. Price is subject to change and listing withdrawal.