



## Industrial For Lease

**Property Name:** West Bloomfield Tech Center  
**Location:** 3160 Haggerty Road  
**City, State:** West Bloomfield, MI  
**Cross Streets:** Haggerty and Oakley Park Road  
**County:** Oakland  
**Zoning:** Light Industrial

### BUILDING SIZE / AVAILABILITY

<b>Total Building Sq. Ft.:</b> 81,184	<b>Building Type:</b> Built	<b>Mezzanine:</b> N/A
<b>Available Sq. Ft.:</b> 4,800 - 15,870	<b>Available Shop Sq. Ft.:</b> 2,493 - 3,766	<b>Office Dim:</b> N/A
	<b>Available Office Sq. Ft.:</b> 1,500 - 3,147	<b>Shop Dim:</b> N/A

### PROPERTY INFORMATION

<b>Clear Height:</b> 19'	<b>Multi-Tenant:</b> Yes	<b>Year Built:</b> 1988 (Retrofit: 2022)
<b>Grade Level Door(s):</b> 2: 12 x 14	<b>Rail:</b> No	<b>Sprinklers:</b> No
<b>Truckwells or Docks:</b> 0	<b>Security:</b> No	<b>Signage:</b> N/A
<b>Exterior Construction:</b> Stucco	<b>Interior:</b> N/A	<b>Exterior:</b> N/A
<b>Structural System:</b> Block	<b>Lighting:</b> Fluorescent	<b>Roof:</b> N/A
<b>Air-Conditioning:</b> 100%	<b>Bay Sizes:</b> N/A	<b>Floors:</b> N/A
<b>Heating:</b> GFA	<b>Restrooms:</b> Yes	<b>Floor Drains:</b> No
<b>Availability:</b> Immediately	<b>Cranes:</b> No	<b>Acreage:</b> 6.220
<b>Power (Amps/Volts):</b> 200 Amps, 208 Volts, 3-Phase	<b>Parking:</b> 150, Shared	<b>Land Dimensions:</b> N/A

### PRICING INFORMATION

<b>Lease Rate:</b> \$10.95	<b>Mthly Rate:</b> N/A	<b>TD:</b> N/A
<b>Lease Type:</b> NNN	<b>Taxes:</b> \$146,456 (2024)	<b>Deposit:</b> N/A
<b>Lease Term:</b> N/A	<b>Parcel #:</b> 18-19-101-021	<b>Assessor #:</b> N/A
	<b>Imprv Allow:</b> N/A	<b>Options:</b> N/A

**Tenant Responsibility:** N/A

### COMMENTS

Frontage on Haggerty Road with quick access to M-5, I-696, I-96, and I-275.

Potential available combination of suites include:

E & F: 10,440 sq. ft.  
 F & G: 10,230 sq. ft.  
 E, F, & G: 15,870 sq. ft.

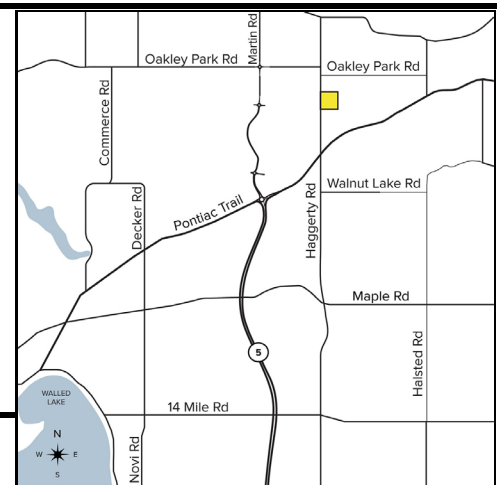

**Broker:** SIGNATURE ASSOCIATES

#### Agent(s):

Jeff Lemanski, (248) 359-0641, jlemanski@signatureassociates.com  
 Chris D'Angelo, (248) 948-0109, cdangelo@signatureassociates.com