



# 2465 Woodlake Circle

Okemos, Michigan 48864

## Property Highlights

- Stand alone building with 7218 sqft
- Building is potentially divisible into 3 suites
- Off Jolly Rd just west of Okemos Rd
- Easy access to I-96
- Restaurants, shopping, hotels and banks close by

## Offering Summary

Lease Rate:	\$15.00 SF/yr (MG)
Building Size:	7,218 SF
Available SF:	7,218 SF
Lot Size:	71,241 SF

## For More Information



### Steve Slater

Associate Broker

O: 517 487 9222 | C: 517 749 7914

[steveslater@naimidmichigan.com](mailto:steveslater@naimidmichigan.com)

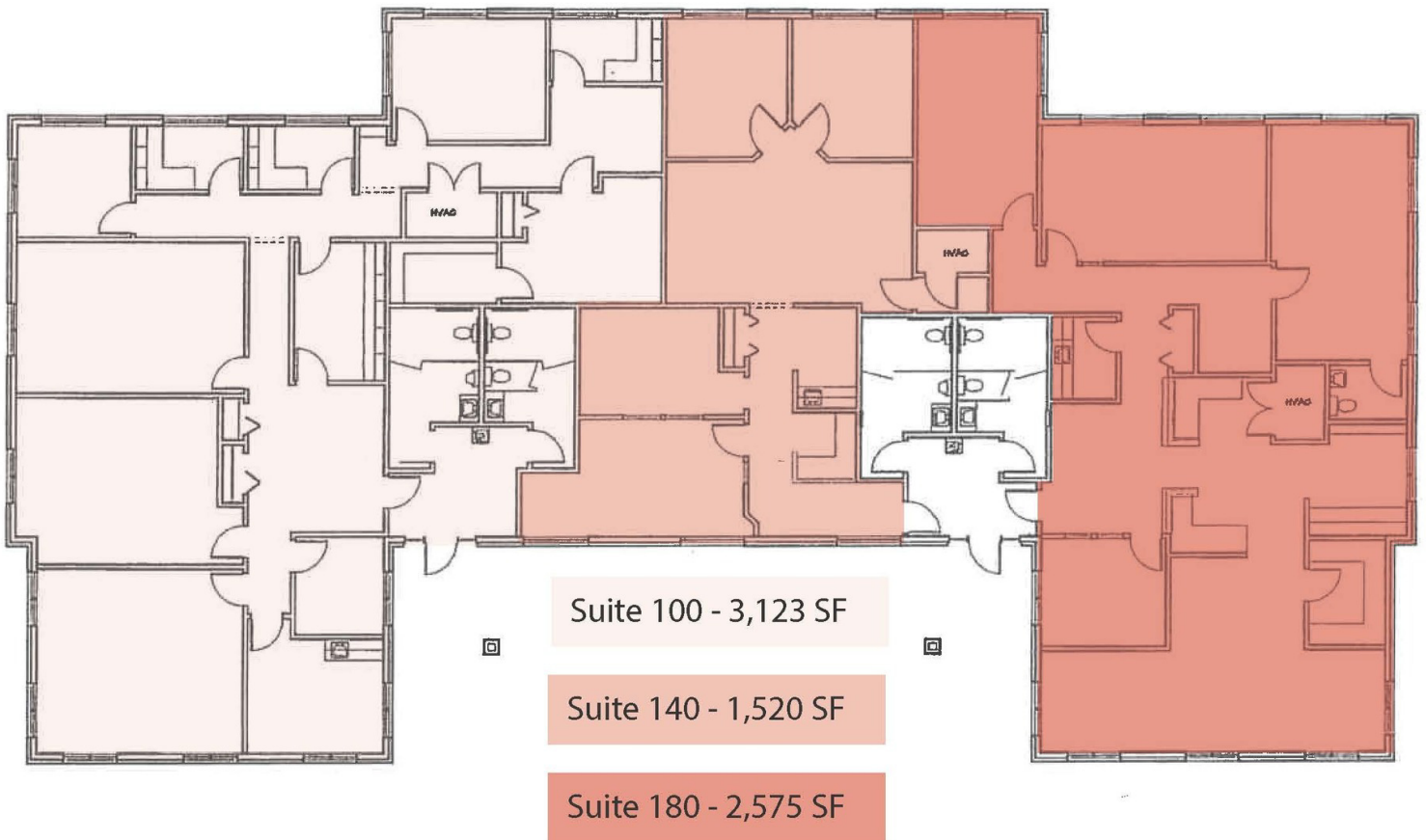



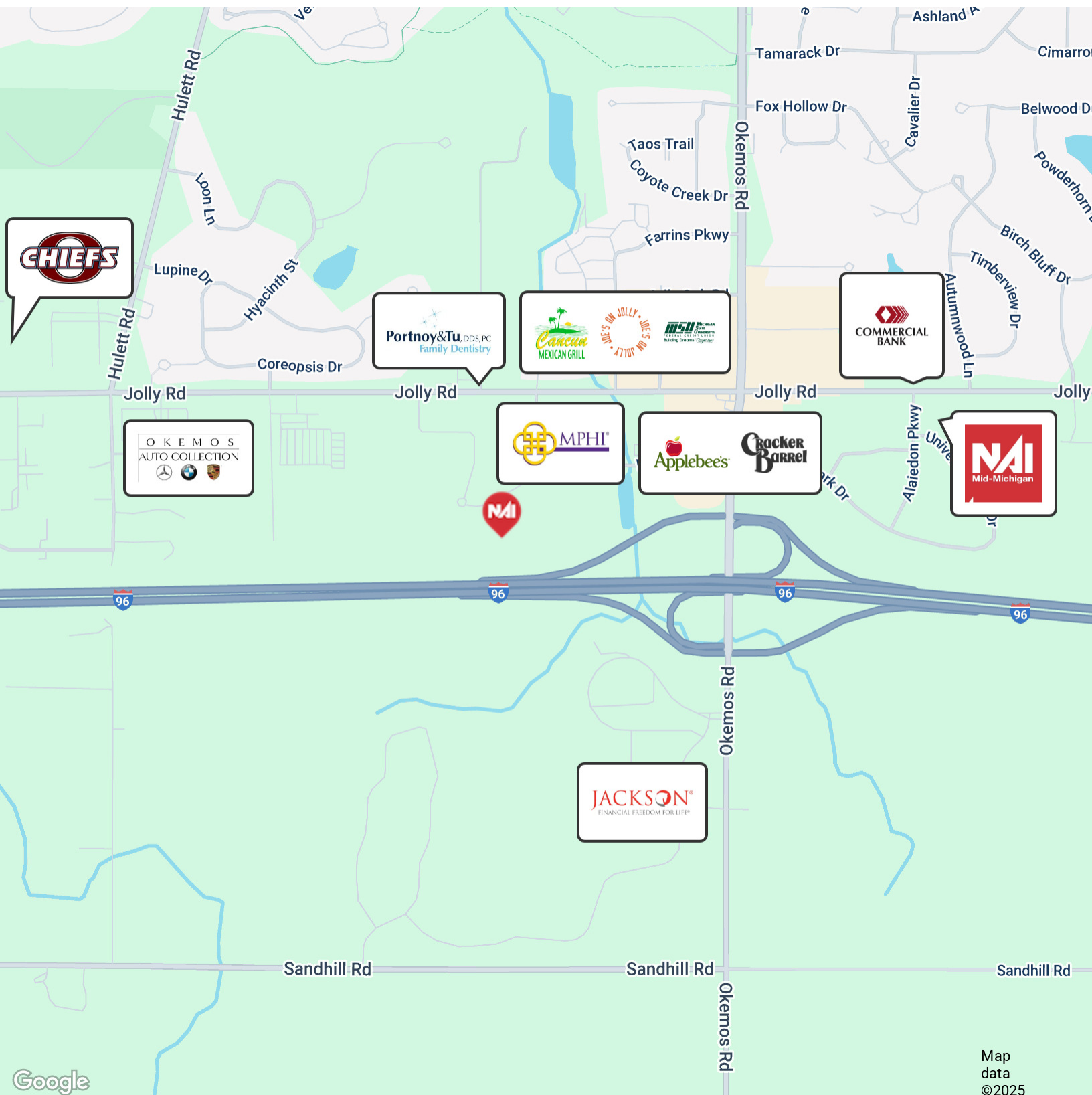

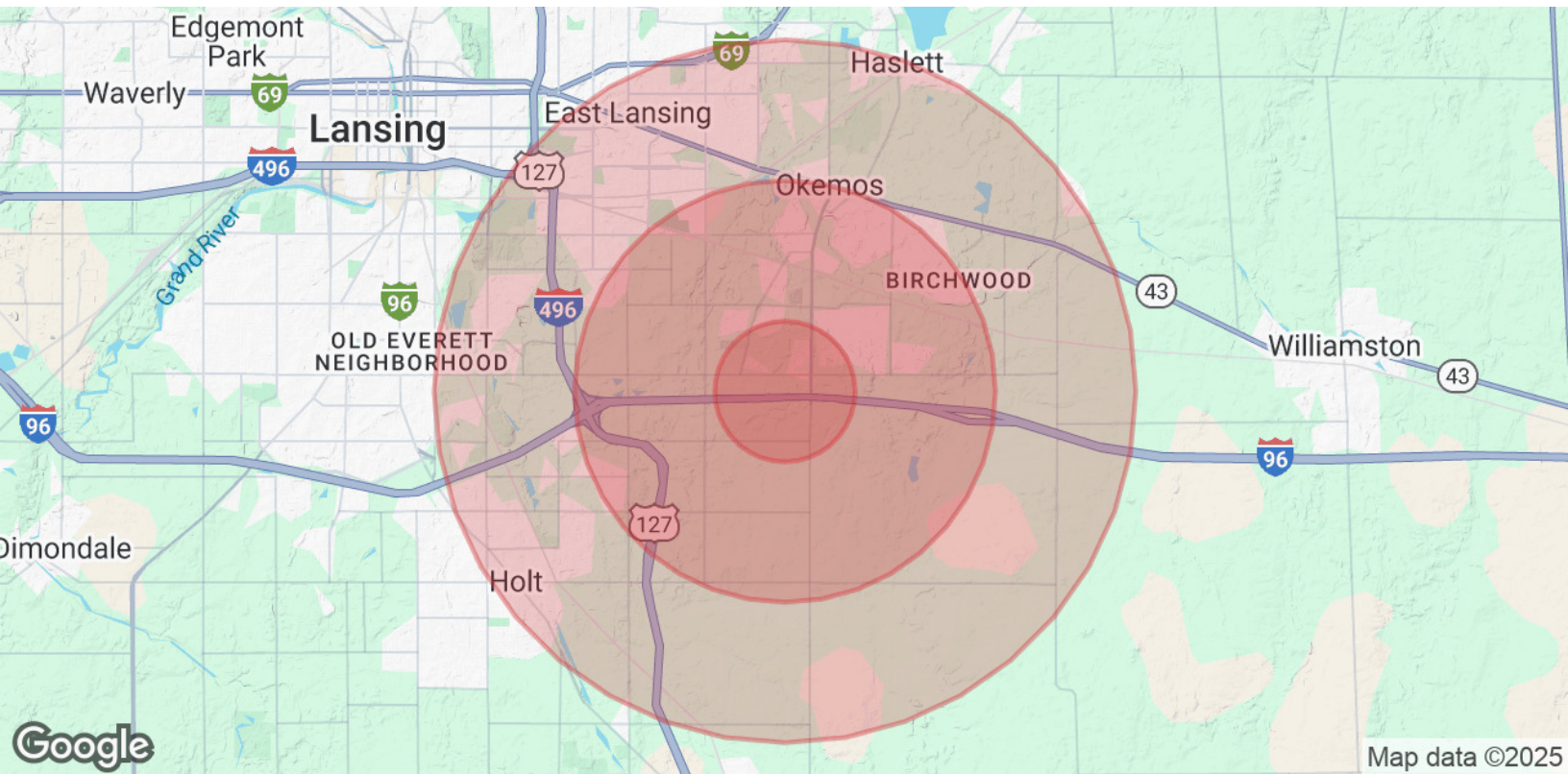

Population	1 Mile	3 Miles	5 Miles
Total Population	3,064	22,259	95,023
Average Age	38	39	34
Average Age (Male)	38	38	34
Average Age (Female)	38	40	35
Households & Income	1 Mile	3 Miles	5 Miles
Total Households	1,182	8,855	35,065
# of Persons per HH	2.6	2.5	2.7
Average HH Income	\$140,328	\$130,980	\$94,038
Average House Value	\$426,695	\$363,320	\$252,479

Demographics data derived from AlphaMap