

LAND For Sale

Location: North Territorial Road
Side of Street: North
City: Northfield Twp., MI
Cross Streets: NEC of North Territorial & US-23
County: Washtenaw

Acreage: 5.00 - 96.75
Zoning: PSC-Planned SC
Improvements: N/A
Dimensions:

UTILITIES

Sanitary Sewer: Yes
Storm Sewer: Yes
Water: Yes
Gas: Yes
Outside Storage: No
Rail Siding: Yes

ADJACENT LAND

North: Mixed Use
South: Retail
East: Mixed Use
West: Mixed Use

PRICING INFORMATION

Asking Price:

Per Acre: \$59,900.00
Per SqFt :
Terms:
Parcel #: See Comments
Assessor Number: N/A
Taxes: \$47,606.38 (2025)

TRAFFIC INFORMATION

Yr: 2025 Count: 72,614 US-23 N. of N. Territorial Rd.
Yr: 2025 Count: 74,131 US-23 S. of N. Territorial Rd.
Yr: 2025 Count: 8,123 N. Territorial Rd. E. of US-23
Yr: 2025 Count: 10,781 N. Territorial Rd. W. of US-23

DEMOGRAPHICS

| | Population | Median HH Income |
|----------------------|------------|------------------|
| 1 Mile Radius | 416 | \$107,008 |
| 3 Mile Radius | 5,739 | \$108,436 |
| 5 Mile Radius | 29,161 | \$122,110 |

Comments: High visibility site. Zoned PSC, Planned Shopping Center.
 Parcel IDS #: B-02-20-200-001, 002, 009 & B-02-20-100-005

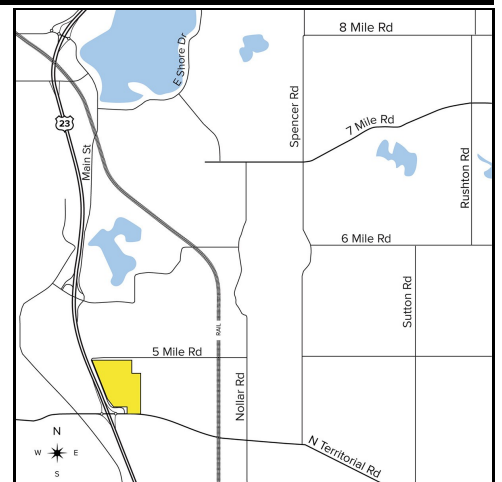

Broker: SIGNATURE ASSOCIATES

Agent(s):

Dave Green, (248) 948-4184, dgreen@signatureassociates.com