



LAND For Sale

Location: 8260 Lyndon Street
Side of Street: North
City: Detroit, MI
Cross Streets: Cloverlawn Ave.
County: Wayne

Acreage: 0.52

Zoning: M-2

Improvements: N/A

Dimensions: 228.00 x 100.00

UTILITIES

Sanitary Sewer: Yes

Storm Sewer: Yes

Water: Yes

Gas: Yes

Outside Storage: No

Rail Siding: No

ADJACENT LAND

North:

East:

South:

West:

PRICING INFORMATION

Asking Price: \$149,000.00

Per Acre:

Parcel #: 16005961-71

Per SqFt :

Assessor Number: N/A

Terms:

Taxes: \$1,081.12 (2024)

TRAFFIC INFORMATION

Yr: 2025 Count: 4,641 Lyndon St. W. of Livernois

Yr: 2025 Count: 21,446 Livernois N. of Lyndon St.

Yr: 2025 Count: 17,176 Livernois S. of Lyndon St.

Yr: Count:

DEMOGRAPHICS

	Population	Median HH Income
1 Mile Radius	15,239	\$37,168
3 Mile Radius	160,370	\$42,392
5 Mile Radius	438,395	\$47,599

Comments: Sale via Quit Claim Deed.

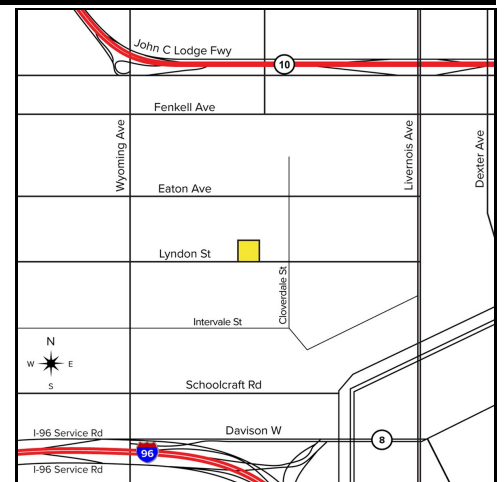

Broker: SIGNATURE ASSOCIATES

Agent(s):

Chris Monsour, (248) 948-0107, cmonsour@signatureassociates.com

Joe Stack, (248) 359-0615, jstack@signatureassociates.com

Information is subject to verification and no liability for errors or omissions is assumed. Price and terms are subject to modification.