

# STERLING PROFESSIONAL OFFICE CENTER



## PILOT PROPERTY GROUP

**33464 SCHOENHERR, STERLING HEIGHTS, MI 48312**

### PROPERTY OVERVIEW:

Professionally managed office building.  
Ample parking.  
Flexible square footage.  
Contact the Broker for more details.

*Property Type:* ..... Office  
*Cross Streets:* ..... East side of Schoenherr, North of 14 Mile Road  
*Total Square Footage:* ..... 41,000  
*Building Name:* ..... Sterling Professional  
*Minimum Square Footage:* ..... 2,750  
*Maximum Square Footage:* ..... 6,972  
*Parcel Size:* ..... 4.21 Acres  
*Year Built:* ..... 2006  
*Zoning:* ..... O-1  
*Parking Spaces:* ..... 210+  
*Lease Rate:* ..... \$14.95 PSF  
*Lease Type:* ..... Gross

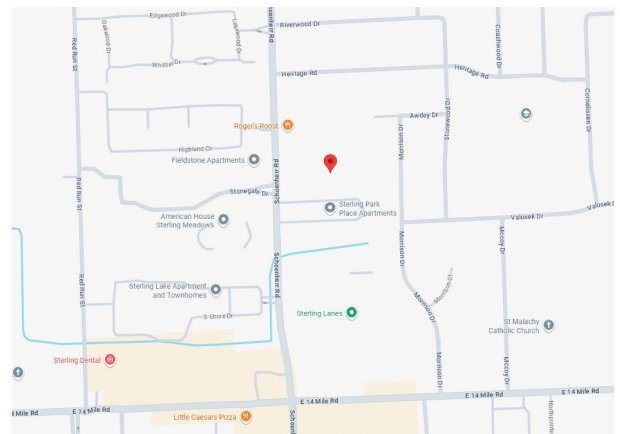

### AGENT CONTACT INFO

**ANTHONY RUBINO** O: 586.254.0900 x101 • C: 586.873.5419 • [anthony@pilotpg.com](mailto:anthony@pilotpg.com)  
**JIMMY DIEHL** O: 586.254.0900 x109 • C: 586.337.5241 • [j.diehl@pilotpg.com](mailto:j.diehl@pilotpg.com)

*Matching the right people to the right place.*

*Offices in Sterling Heights and Port Huron to serve you  
586.254.0900 • [www.pilotpg.com](http://www.pilotpg.com)*

## ADDITIONAL PHOTOS



*Matching the right people to the right place.*

Offices in Sterling Heights and Port Huron to serve you  
586.254.0900 • [www.pilotpg.com](http://www.pilotpg.com)

## FLOORPLAN

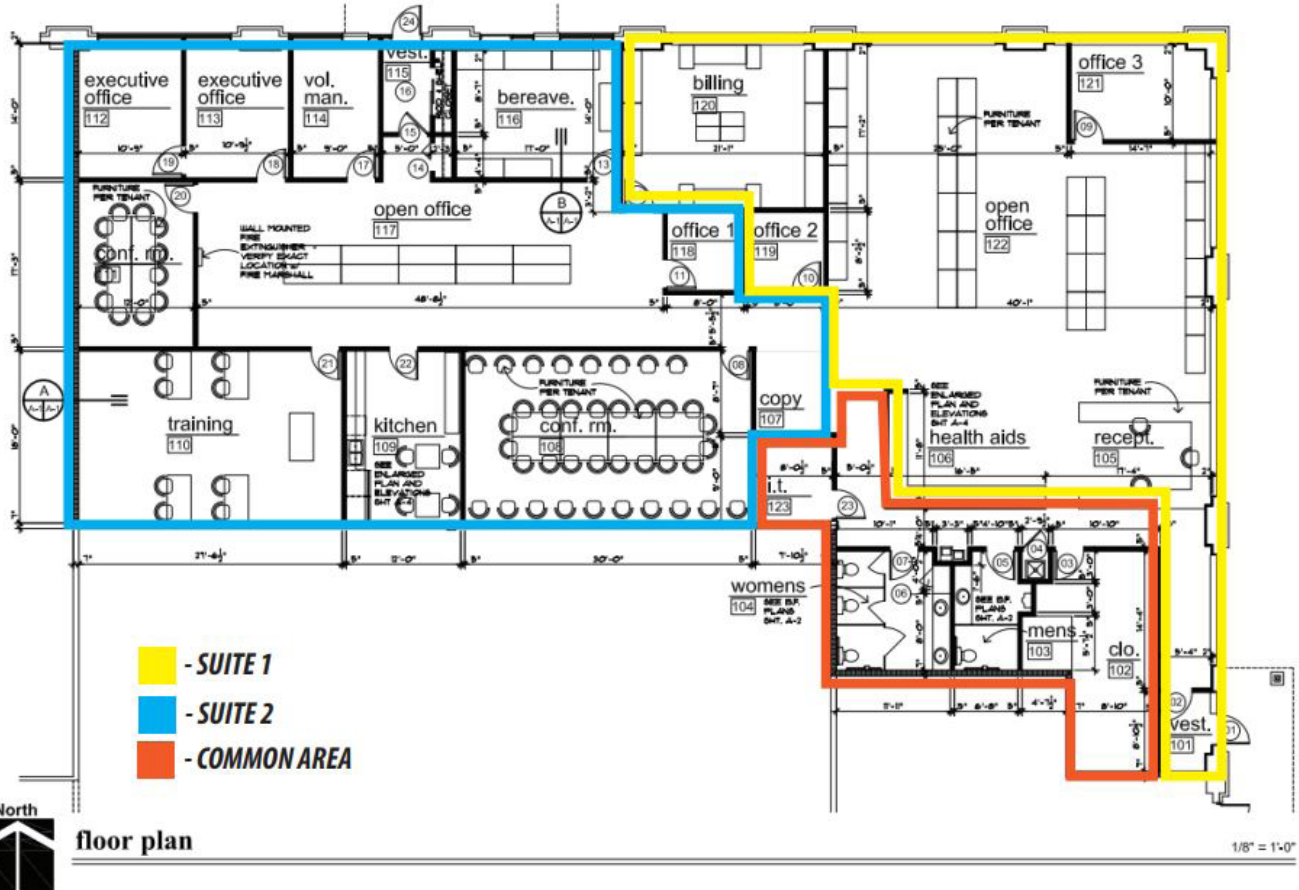

*Matching the right people to the right place.*

Offices in Sterling Heights and Port Huron to serve you  
586.254.0900 • www.pilotpg.com