

# CENTURY PLAZA

3614-3640 Rochester Road / Troy, MI



**MID-AMERICA®**  
Real Estate-Michigan, Inc.

## FOR LEASE



RETAIL OPPORTUNITY



# CENTURY PLAZA



## Address

3614 - 3640 Rochester Road  
Troy, MI 48083

## Availability

1,260 SF

## Features

Last space remaining in this high-profile neighborhood center located on the east side of Rochester Road, just north of Big Beaver Road. Century Plaza offers exceptional visibility in one of Troy's most active retail corridors, with over 50,000 vehicles passing daily. The area features strong demographics, with over 88,000 residents within a 3-mile radius and an average household income of around \$130,000. The property includes a multi-panel monument sign on Rochester Road, multiple points of ingress and egress, improved road infrastructure following the recent Rochester Road widening project, and newly updated storefronts featuring stone, brick, and glass.

## Co-Tenants



## Demographics (2025)

	1 MILES	3 MILES	5 MILES
POPULATION	10,291	88,394	249,373
HOUSEHOLDS	3,673	35,614	104,239
AVG HOUSEHOLD INCOME	\$169,513	\$130,337	\$130,448
DAYTIME POPULATION	11,841	130,718	312,856

# CENTURY PLAZA

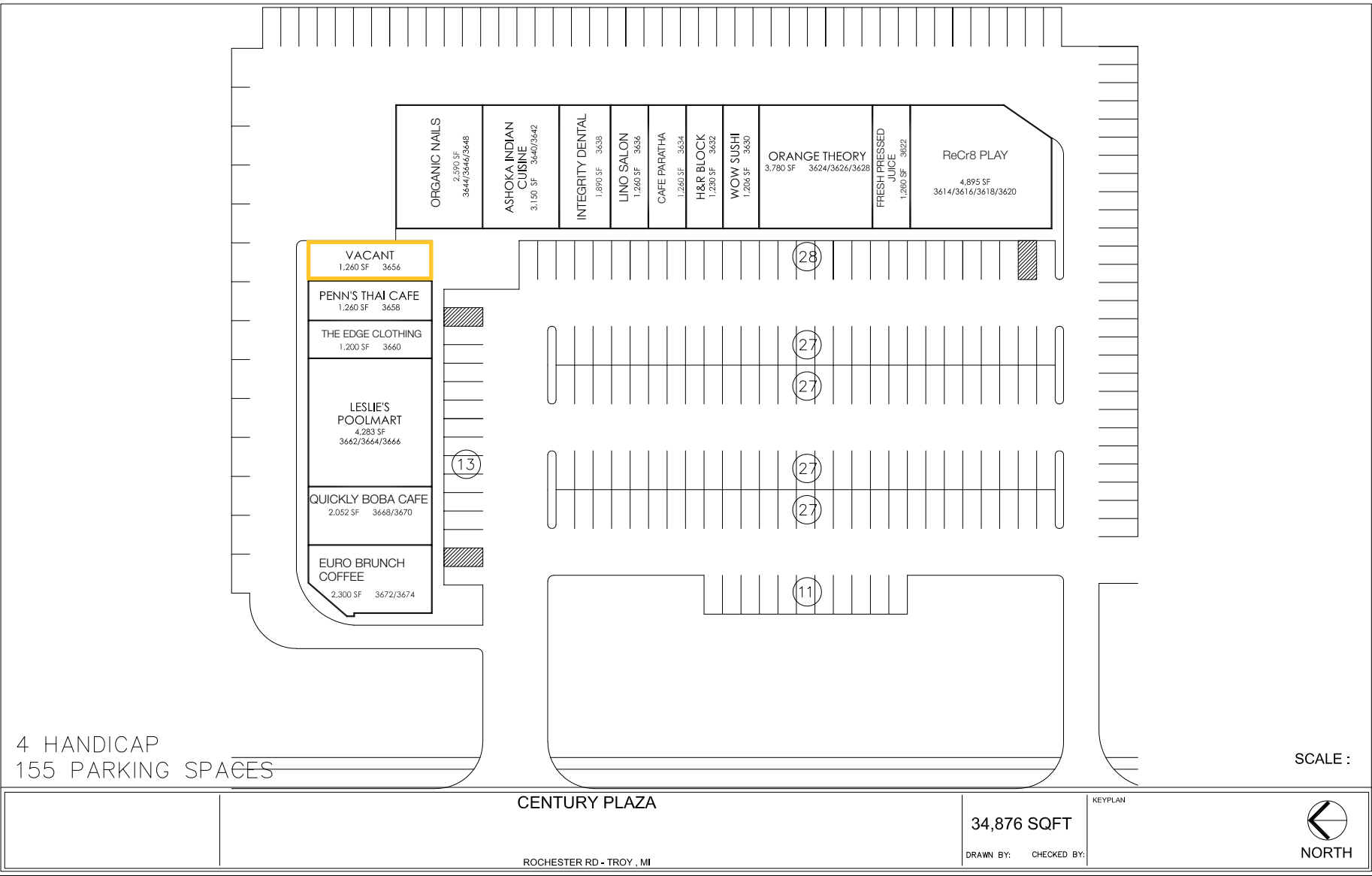



# CENTURY PLAZA



DRONE PICTURES



# CENTURY PLAZA



AERIAL