

LAND For Sale

Location: Pontiac Trail
Side of Street: South
City: Lyon Twp., MI
Cross Streets: Milford Road
County: Oakland

Acreage: 9.16
Zoning: R-0.3

Improvements: N/A
Dimensions:

UTILITIES

Sanitary Sewer: Yes
Storm Sewer: Yes
Water: Yes

Gas: Yes
Outside Storage: No
Rail Siding: No

ADJACENT LAND

North: Residential
South: Airport

East: Airport
West: Residential

PRICING INFORMATION

Asking Price: \$650,000.00
Per Acre: \$70,960.70
Per SqFt : \$1.63
Terms: Cash

Parcel #: 21-04-451-006
Assessor Number: N/A
Taxes: \$4,499.16 (2024)

TRAFFIC INFORMATION

Yr: 2024 Count: 15,902 Milford Rd. S. of Grand River Ave.
Yr: 2024 Count: 19,359 Milford Rd. N. of Grand River Ave.
Yr: 2024 Count: 12,438 Grand River Ave. E. of Milford Rd.
Yr: 2024 Count: 6,430 Grand River Ave. W. of Milford Rd.

DEMOGRAPHICS

	Population	Median HH Income
1 Mile Radius	2,695	\$135,809
3 Mile Radius	17,014	\$124,111
5 Mile Radius	68,390	\$116,116

Comments: Adjacent to 17 acres for sale in rapidly developing New Hudson, portion of Lyon Twp. Many potential uses. Call Rick Birdsall 248-842-3145.

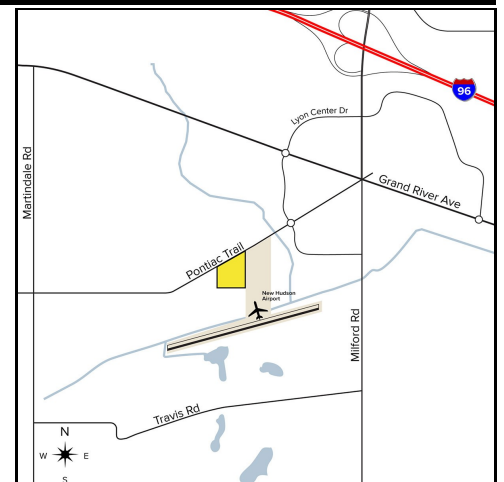

Broker: SIGNATURE ASSOCIATES

Agent(s):

Rick Birdsall, (248) 799-3145, rbirdsall@signatureassociates.com

Information is subject to verification and no liability for errors or omissions is assumed. Price and terms are subject to modification.