



Industrial For Sale

Property Name:

Location: 550 Hillsdale Street

City, State: Wyandotte, MI

Cross Streets: Biddle Avenue

County: Wayne

Zoning: Industrial

BUILDING SIZE / AVAILABILITY		Building Type:	Built	Mezzanine:	N/A
Total Building Sq. Ft.:	18,000	Available Shop Sq. Ft.:	17,050	Office Dim:	N/A
Available Sq. Ft.:	18,000	Available Office Sq. Ft.:	950	Shop Dim:	N/A

PROPERTY INFORMATION		Freestanding:	Yes	Year Built:	1991
Clear Height:	21' - 28'	Rail:	No	Sprinklers:	Yes
Grade Level Door(s):	5: 12 x 14, 12 x 12	Security:	No	Signage:	N/A
Truckwells or Docks:	0	Interior:	N/A	Exterior:	N/A
Exterior Construction:	N/A	Lighting:	N/A	Roof:	N/A
Structural System:	N/A	Bay Sizes:	N/A	Floors:	N/A
Air-Conditioning:	N/A	Restrooms:	Yes	Floor Drains:	No
Heating:	Yes	Cranes:	Yes, (3) 10-T (1) 6-T (1) 3.5-T	Acreage:	1.650
Availability:	Immediately	Parking:	20, Ample	Land Dimensions:	N/A
Power (Amps/Volts):	1200 Amps, 480 Volts, 3-Phase Heavy Power				

PRICING INFORMATION

Sale Price:	\$1,224,000 (\$68.00/sqft)	Deposit:	N/A	TD:	N/A
Taxes:	\$13,650.13 (2025)	Options:	N/A	Assessor #:	N/A
Parcel #:	57-023-02-0037-302				

COMMENTS

18,000 sq. ft. heavy power, high-bay, craned facility for sale. Sloped roof with clear heights between 21'-28'. Small yard behind the building for additional storage. (5) cranes of various capacities and (5) grade-level doors. Vacated Albion Street available for additional parking. Can be purchased individually or with 580 Hillsdale Street and/or 555 Grove Street.

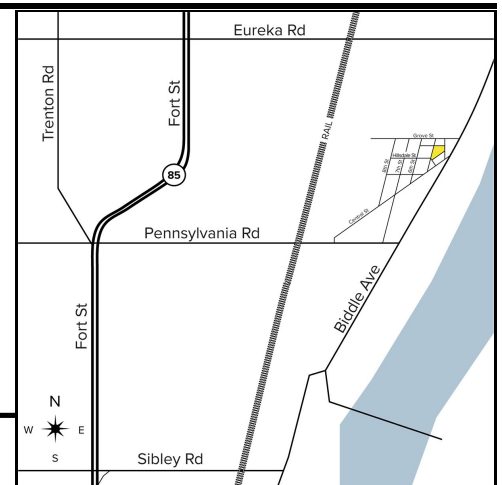

Broker: SIGNATURE ASSOCIATES

Agent(s):

Brad Viergever, (248) 799-3146, bviergever@signatureassociates.com

Alex Timmis, (248) 359-0623, atimmis@signatureassociates.com