



LAND For Sale

Location: Haggerty Road
Side of Street: East
City: West Bloomfield, MI
Cross Streets: N. of Maple Rd.
County: Oakland

Acreage: 2.18

Zoning: RM

Improvements: N/A

Dimensions:

UTILITIES

Sanitary Sewer: Yes

Storm Sewer: No

Water: Yes

Gas: Yes

Outside Storage: No

Rail Siding: No

ADJACENT LAND

North: Retail

South: Apartments

East: Apartments

West: Retail

PRICING INFORMATION

Asking Price: \$1,100,000.00

Per Acre: \$504,587.16

Per SqFt : \$11.58

Terms: Cash sale, lease or BTS

Parcel #: 18-30-326-017

Assessor Number: N/A

Taxes: \$10,723.47

TRAFFIC INFORMATION

Yr: 2022 Count: 20,757 Maple Rd. E. of Haggerty Rd.

Yr: 2022 Count: 16,289 Maple Rd. W. of Haggerty Rd.

Yr: 2022 Count: 18,655 Haggerty Rd. S. of Maple Rd.

Yr: 2022 Count: 19,279 Haggerty Rd. N. of Maple Rd.

DEMOGRAPHICS

	Population	Median HH Income
1 Mile Radius	5,641	\$90,914
3 Mile Radius	67,272	\$92,282
5 Mile Radius	168,281	\$93,516

Comments: Beautiful site for sale or build-to-suit. Master planned - Haggerty Road mixed use. Fabulous visibility and demographics. Close to M-5 @ Maple Rd. Growing area with national retailers nearby.

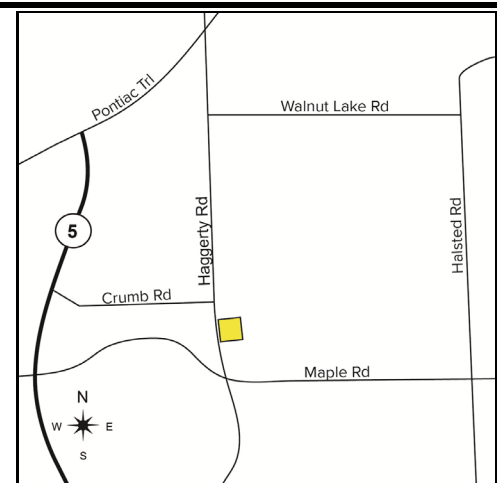

Broker: SIGNATURE ASSOCIATES

Agent(s):

Chris Secontine, (248) 799-3174, csecontine@signatureassociates.com

Marvin Petrous, (248) 359-0647, mpetrous@signatureassociates.com

Information is subject to verification and no liability for errors or omissions is assumed. Price and terms are subject to modification.