

14555 JIB STREET
PLYMOUTH, MICHIGAN

HI-TECH FOR LEASE
4,500 Square Feet Available



**SIGNATURE
ASSOCIATES**
KNOW SIGNATURE | KNOW RESULTS

METRO WEST INDUSTRIAL PARK



PROPERTY FEATURES

- 4,500 square feet available
- 24' clear height
- 50 parking spaces
- Zoned Industrial Improved
- Built in 1988, retrofit in 2015
- Separate entrance and bathrooms
- Access to grade level door through adjacent space
- Possible showroom use
- Lease Rate: \$7.95/sq. ft. NNN



For more information, please contact:

STEVE GORDON
(248) 948 0101
sgordon@signatureassociates.com

DAVID GREEN
(248) 948 4184
dgreen@signatureassociates.com

SIGNATURE ASSOCIATES
One Towne Square, Suite 1200
Southfield, MI 48076
www.signatureassociates.com

14555 Jib Street – Plymouth, Michigan

Hi-Tech For Lease

4,500
Square Feet
AVAILABLE

Site Plan

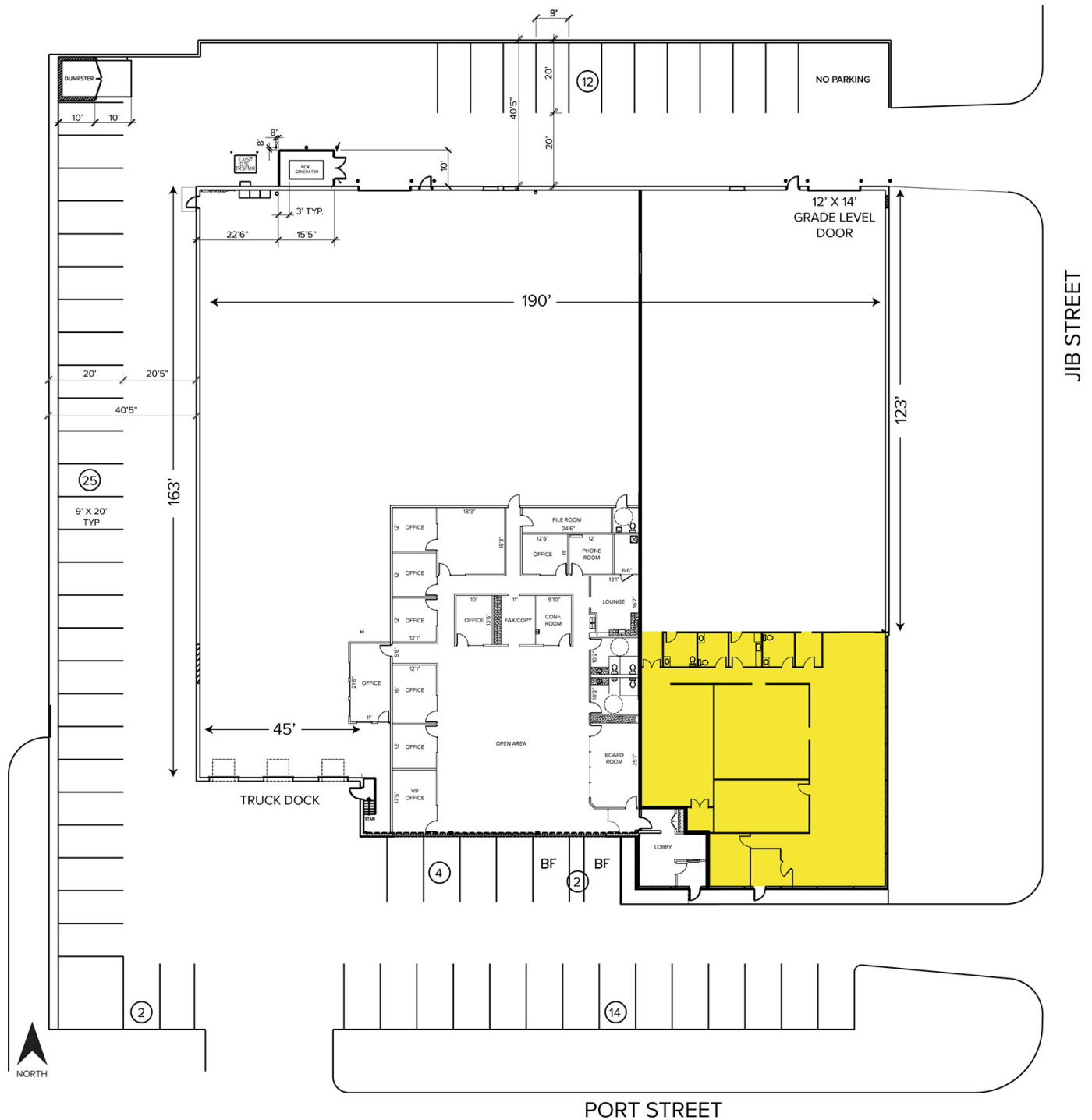

For more information, please contact:

STEVE GORDON

(248) 948 0101

sgordon@signatureassociates.com

DAVID GREEN

(248) 948 4184

dgreen@signatureassociates.com

SIGNATURE ASSOCIATES

One Towne Square, Suite 1200

Southfield, MI 48076

www.signatureassociates.com

14555 Jib Street – Plymouth, Michigan

Hi-Tech For Lease

4,500
Square Feet
AVAILABLE

Aerial



For more information, please contact:

STEVE GORDON

(248) 948 0101

sgordon@signatureassociates.com

DAVID GREEN

(248) 948 4184

dgreen@signatureassociates.com

SIGNATURE ASSOCIATES

One Towne Square, Suite 1200

Southfield, MI 48076

www.signatureassociates.com

Information is subject to verification and no liability for errors or omissions is assumed. Price is subject to change and listing withdrawal.