

6408 BRUSH STREET
DETROIT, MICHIGAN

LAND FOR SALE
0.10 Acres Available



**SIGNATURE
ASSOCIATES**
KNOW SIGNATURE | KNOW RESULTS

SUBSTANTIAL PRICE REDUCTION!



PROPERTY FEATURES

- 0.10 acres available
- 30' x 142' lot
- Zoned M4
- Easy access to I-75 and I-94
- Available for individual sale or as part of an 8-property portfolio totaling 30,700 square feet and 1.21 acres
- Sale Price: \$100,000

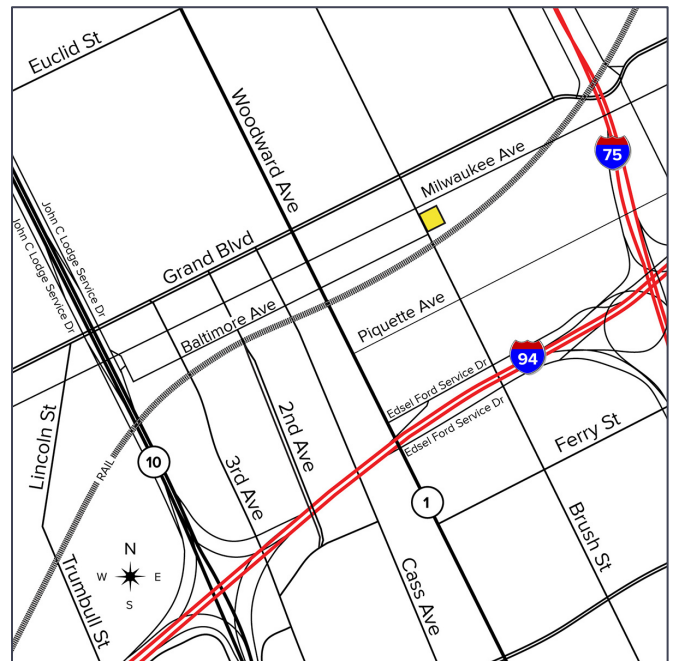

For more information, please contact:

STEVE GORDON

(248) 948 0101

sgordon@signatureassociates.com

CHRIS MONSOUR

(248) 948 0107

cmonsour@signatureassociates.com

JOE STACK

(248) 359 0615

jstack@signatureassociates.com

6408 Brush Street – Detroit, Michigan

Land For Sale

0.10
Acres
AVAILABLE

DEMOGRAPHICS		
	POPULATION	MED. HH INCOME
1 MILE	16,714	\$43,682
3 MILE	142,153	\$43,793
5 MILE	327,828	\$43,760

TRAFFIC COUNTS (TWO-WAY)	
16,725	E. Grand Blvd. E Woodward Ave.
17,993	E. Grand Blvd. W Woodward Ave.
13,773	Woodward Ave. S of E. Grand Blvd.
11,554	Woodward Ave. N of E. Grand Blvd.

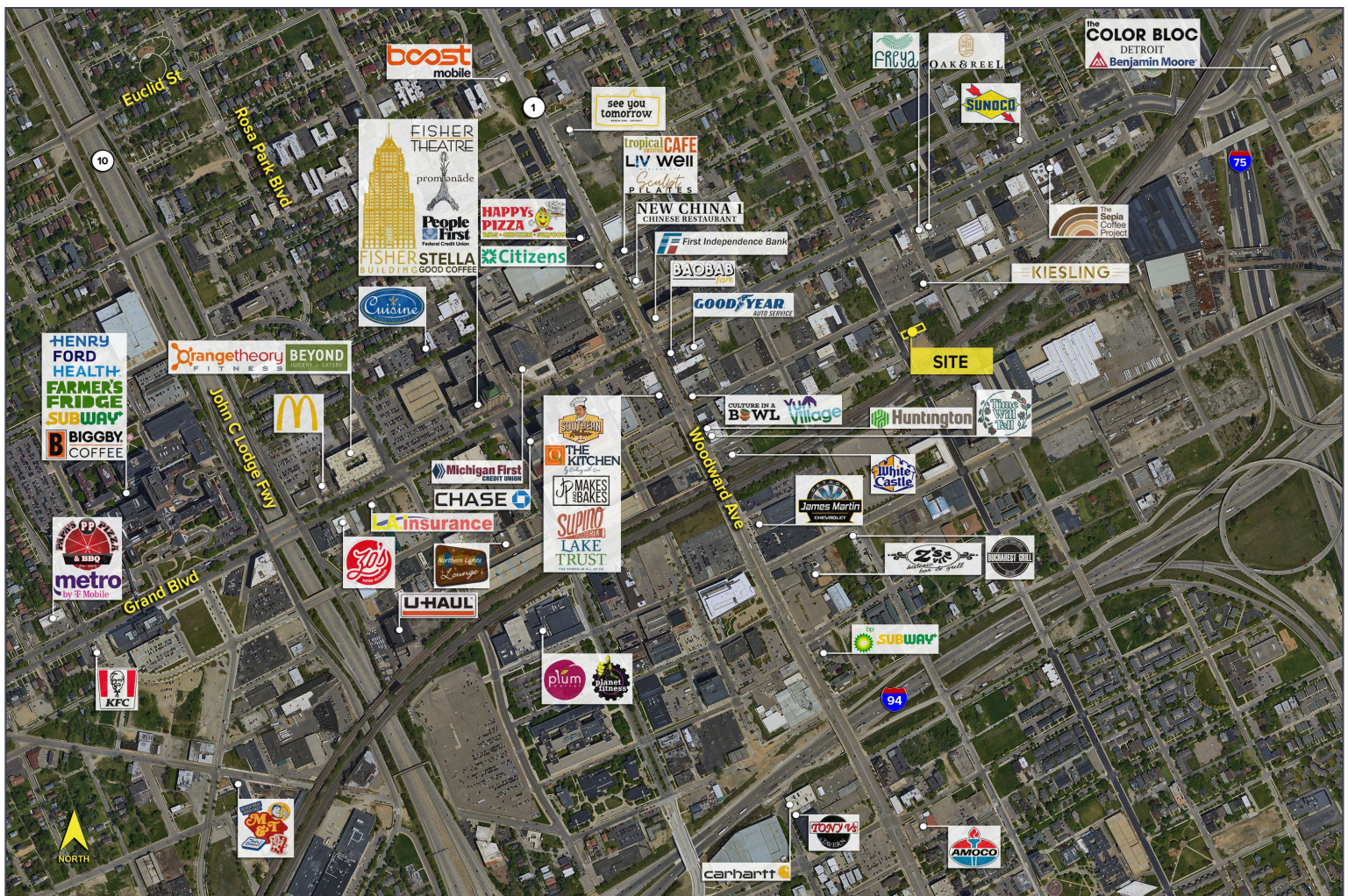

For more information, please contact:

STEVE GORDON
(248) 948 0101

CHRIS MONSOUR
(248) 948 0107

JOE STACK
(248) 359 0615

SIGNATURE ASSOCIATES
One Towne Square, Suite 1200
Southfield, MI 48076
www.signatureassociates.com