



## Industrial For Lease

**Property Name:** Marque - Troy Corporate Center  
**Location:** 409-445 Elmwood Drive  
**City, State:** Troy, MI  
**Cross Streets:** Rochester & Maple Roads  
**County:** Oakland  
**Zoning:** Industrial

### BUILDING SIZE / AVAILABILITY

<b>Total Building Sq. Ft.:</b> 45,567	<b>Building Type:</b> Built	<b>Mezzanine:</b> N/A
<b>Available Sq. Ft.:</b> 2,885 - 5,885	<b>Available Shop Sq. Ft.:</b> 2,585 - 2,700	<b>Office Dim:</b> N/A
	<b>Available Office Sq. Ft.:</b> 300	<b>Shop Dim:</b> N/A

### PROPERTY INFORMATION

<b>Clear Height:</b> 16'6"	<b>Multi-Tenant:</b> Yes	<b>Year Built:</b> 1980
<b>Grade Level Door(s):</b> 2: 12 x 14	<b>Rail:</b> No	<b>Sprinklers:</b> No
<b>Truckwells or Docks:</b> 0	<b>Security:</b> Yes	<b>Signage:</b> Marquee
<b>Exterior Construction:</b> Block	<b>Interior:</b> N/A	<b>Exterior:</b> N/A
<b>Structural System:</b> Steel/Block	<b>Lighting:</b> Fluorescent	<b>Roof:</b> N/A
<b>Air-Conditioning:</b> Office	<b>Bay Sizes:</b> N/A	<b>Floors:</b> 6"
<b>Heating:</b> Gas Forced Air	<b>Restrooms:</b> Yes	<b>Floor Drains:</b> No
<b>Availability:</b> Immediately	<b>Cranes:</b> No	<b>Acreage:</b> N/A
<b>Power (Amps/Volts):</b> 240 Volts	<b>Parking:</b> Ample	<b>Land Dimensions:</b> N/A

### PRICING INFORMATION

<b>Lease Rate:</b> \$11.25	<b>Mthly Rate:</b> N/A	<b>TD:</b> N/A
<b>Lease Type:</b> Gross	<b>Taxes:</b> N/A	<b>Deposit:</b> N/A
<b>Lease Term:</b> 5 Year(s)	<b>Parcel #:</b> 20-34-178-003	<b>Assessor #:</b> N/A
	<b>Imprv Allow:</b> N/A	<b>Options:</b> N/A

**Tenant Responsibility:** N/A

### COMMENTS

Professionally managed complex centrally located near I-75 between 14 Mile and Rochester Road exits. Each unit has been recently renovated. A variety of uses possible.

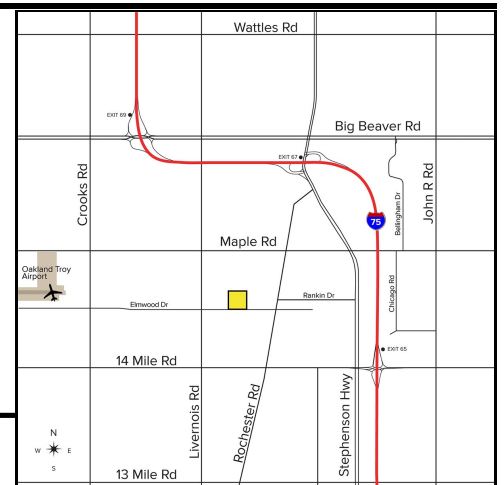

**Broker:** SIGNATURE ASSOCIATES

#### Agent(s):

Kris Pawlowski, (248) 359-3801, kpawlowski@signatureassociates.com  
 John Droze, (248) 948-4191, jdroze@signatureassociates.com