



Industrial For Lease

Property Name: Baldwin Howard Industrial Complex
Location: 60 Baldwin Avenue
City, State: Pontiac, MI
Cross Streets: Howard Street
County: Oakland
Zoning: Industrial

BUILDING SIZE / AVAILABILITY

Total Building Sq. Ft.: 350,000
Available Sq. Ft.: 20,000 - 200,000

Building Type:

Built

Available Shop Sq. Ft.: 20,000 - 180,000
Available Office Sq. Ft.: 5,000 - 20,000

Mezzanine: N/A

Office Dim: N/A

Shop Dim: N/A

PROPERTY INFORMATION

Clear Height: 16'
Grade Level Door(s): 5: 12 x 14
Truckwells or Docks: 6
Exterior Construction: N/A
Structural System: N/A
Air-Conditioning: Yes
Heating: Radiant
Availability: Immediately
Power (Amps/Volts): 3-Phase Heavy

Multi-Tenant: Yes
Rail: No
Security: Yes
Interior: Yes
Lighting: LED
Bay Sizes: N/A
Restrooms: Yes
Cranes: No
Parking: N/A

Year Built: 1920
Sprinklers: Yes
Signage: N/A
Exterior: No
Roof: Rubber
Floors: Wood 4"
Floor Drains: No
Acreage: 10.260
Land Dimensions: N/A

PRICING INFORMATION

Lease Rate: \$5.50 - \$7.75
Lease Type: Gross
Lease Term: N/A

Mthly Rate: N/A
Taxes: N/A
Parcel #: 14-29-205-004
Imprv Allow: N/A

TD: N/A
Deposit: N/A
Assessor #: N/A
Options: N/A

Tenant Responsibility: N/A

COMMENTS

Month-to-Month leases available. Climate controlled space, on-site management and fully fenced with security camera system. Central location with access to M-59, I-75, Dixie Highway and Woodward Avenue.

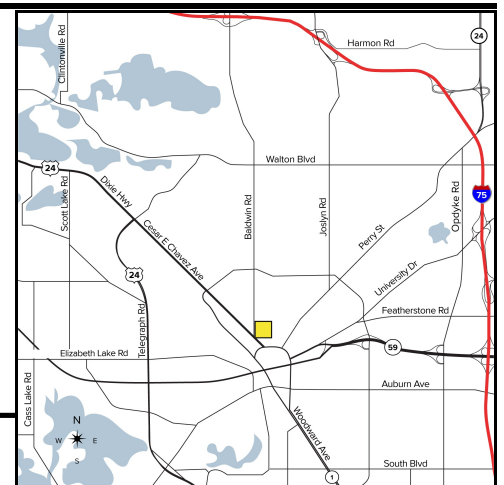

Broker: SIGNATURE ASSOCIATES

Agent(s):

John Droze, (248) 948-4191, jdroze@signatureassociates.com
 Steve Gordon, (248) 948-0101, sgordon@signatureassociates.com