

# EXECUTIVE OFFICE SUITES IN CAMPUS VILLAGE

## MODERN OFFICE SPACE NEAR MSU



**FOR LEASE**  
1151 E. Michigan Ave.  
East Lansing, MI



**AVAILABLE  
SPACE**  
Up to 237 SF

### **SAMANTHA LE**

Senior Associate, Retail Advisor  
Direct: 517 319-9279  
[samantha.le@martincommercial.com](mailto:samantha.le@martincommercial.com)

### **CARSON PATTEN**

Vice President, Retail Advisor  
Direct: 517 319-9230  
[carson.patten@martincommercial.com](mailto:carson.patten@martincommercial.com)



1111 Michigan Ave., Ste 300  
East Lansing, MI 48823  
[martincommercial.com](http://martincommercial.com)

PROPERTY BROCHURE  
Campus Village, 1151 E. Michigan Avenue, East Lansing, MI

FLOOR PLANS:

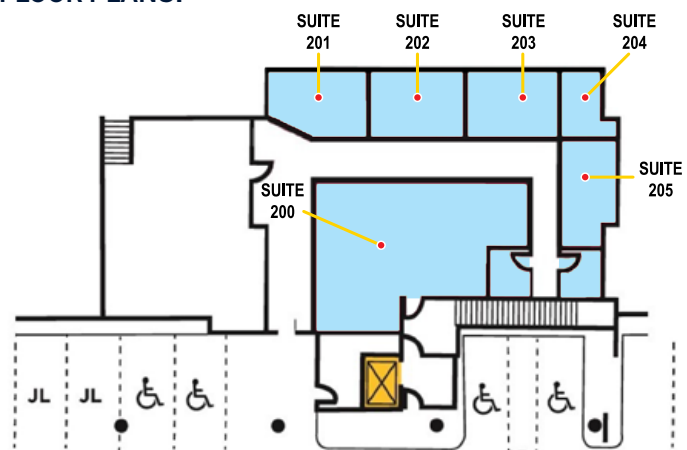

RESERVED PARKING



LOWER LEVEL

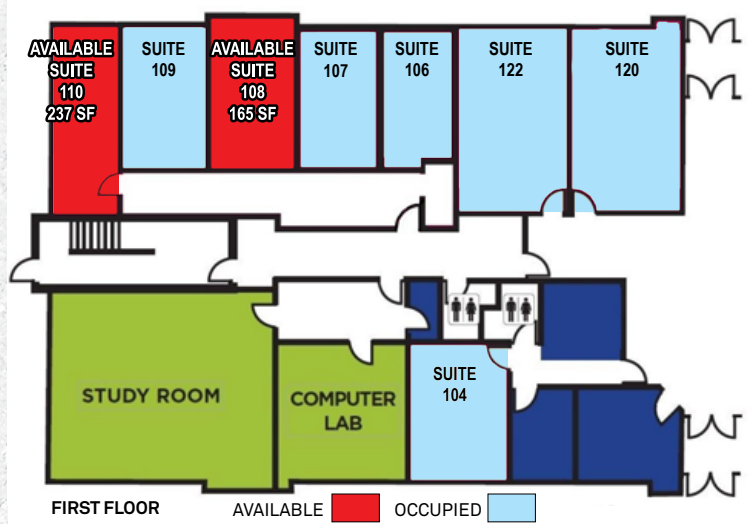

Executive Office Space on Michigan Avenue in East Lansing

Campus Village is a popular 105 unit student housing community on Michigan Avenue. The executive office suites within two floors are ready for immediate occupancy with modern loft-style offices, exposed duct work and glass-paneled doors. The building has beautifully appointed reception area with plush seating. The secure space has controlled after-hours access using key fobs, secure high-speed wireless internet and assigned and reserved parking. Flexible lease terms that will accommodate your growing business.

Walking distance to MSU and the Brody dorm complex. Convenient to US-127 and Frandor Shopping Center, on Michigan Avenue between Downtowns' of East Lansing and Lansing.

LEASE RATE:

Suite	Rate/Month
108: 165 SF .....	\$550
110: 237 SF .....	\$600

PROPERTY INFORMATION



**SPACE:**  
Mixed -Use  
Executive Office



**SECURE:** Timed  
Exterior Doors and  
Key Fob Access



**PARKING:**  
Assigned and  
Reserved



**LOCATED:** Near  
Frandor, MSU and  
Downtown East Lansing

© 2025 MARTIN COMMERCIAL PROPERTIES, INC. ALL RIGHTS RESERVED. THIS INFORMATION HAS BEEN OBTAINED FROM SOURCES BELIEVED RELIABLE BUT HAS NOT BEEN VERIFIED FOR ACCURACY OR COMPLETENESS. YOU SHOULD CONDUCT A CAREFUL, INDEPENDENT INVESTIGATION OF THE PROPERTY AND VERIFY ALL INFORMATION. ANY RELIANCE ON THIS INFORMATION IS SOLELY AT YOUR OWN RISK. MARTIN COMMERCIAL PROPERTIES AND THE MARTIN LOGO ARE SERVICE MARKS OF MARTIN COMMERCIAL PROPERTIES, INC. ALL OTHER MARKS DISPLAYED ON THIS DOCUMENT ARE THE PROPERTY OF THEIR RESPECTIVE OWNERS. PHOTOS HEREIN ARE THE PROPERTY OF THEIR RESPECTIVE OWNERS. USE OF THESE IMAGES WITHOUT THE EXPRESS WRITTEN CONSENT OF THE OWNER IS PROHIBITED.

## PROPERTY BROCHURE

Campus Village, 1151 E. Michigan Avenue, East Lansing, MI

### AREA INFORMATION

**<4 Minutes**

drive to Downtown East Lansing

**5 Minute Walk**

to Michigan State University

**3 Minutes**

to Frandor Shopping Center

**1 Mile**

to US-127/I-496 Interchange

**3 Miles**

to State Capitol

**Walking Distance**

to numerous multi-housing complexes, restaurants, shopping, banking, entertainment and lodging



### TRAFFIC COUNTS

Michigan Ave	13,491
Harrison Rd.	14,345
US-127	66,467

### DEMOGRAPHICS

Proximity	1-Mile	3-Mile	5-Mile
Households	6,309	37,550	76,194
Average Household Income	\$82,646	\$76,650	\$85,295
Labor Force	19,705	83,663	156,098

## PROPERTY BROCHURE

Campus Village, 1151 E. Michigan Avenue, East Lansing, MI

### GALLERY:

