

8306 DALTON RIDGE PL

Mailing Address 920 DUPONT RD STE 203,
 LOUISVILLE, KY 40207-4692
Owner QUICK SELL LLC
Parcel ID 103900350000
Land Value \$53,290
Improvements Value \$97,910
Assessed Value \$151,200
Approximate Acreage 1.8521
Property Class 510 RES 1 FAMILY
 DWELLING
Deed Book/Page 13120 641
District Number 500009
Old District 25
Fire District PLEASURE RIDGE PARK
School District Jefferson County
Neighborhood 405158 / RIVIERA PARK
Home Rule City Jefferson County
Sheriff's Tax Info [View Tax Information](#)
County Clerk [Delinquent Taxes](#)



103900350000 12/1/2025

Area Type	Gross Area	Finished Area
Main Unit	-	2,068
Basement	1,068	0
Attic	NONE	0
Attached Garage	-	n/a
Detached Garage	-	n/a

All measurements in square feet.

Property Details

Type	1 : SINGLE FAMILY
Year Built	1925
Exterior Wall	W2 WOOD SIDING
Roof	GABLE
Basement Foundation	FULL BSMT, FULL CRAWL
Condition	POOR FOR AGE
Heating Type	1 CENTRAL WARM AIR
Central Air	No
Fireplace	No
Construction Frame	Wood frame
Stories	1.50
Full Bathrooms	1
Half Bathrooms	0

Property Sketch

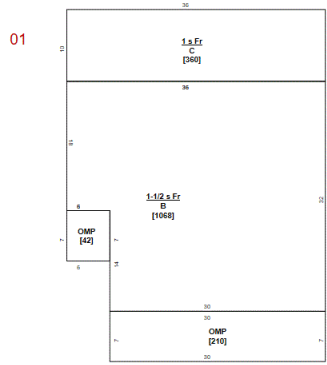

Miscellaneous Improvements

General Purpose Bldg Wood Pole Frame

Map Tips

Use the **"Labels"** dropdown menu to display additional map text: house number, dimensions, and more.

Use the **"Layers"** dropdown menu to display recent sales.

Click the  icon below to view the map in LOJIC to view floodplain, zoning, and additional detailed info.

Sales History

Deed Book/Page	Price	Date	Previous Owner
13120 641	\$115,000	07/28/2025	THOMAS ALETHA ANN
11727 344	\$90,000	07/06/2020	LAMPE MEGAN CATHERINE
11218 689	\$83,500	08/13/2018	DOOLEY THOMAS SCOTT

Assessment History

Record Year	Land	Improvements	Total	Reason
2023	\$53,290	\$97,910	\$151,200	CR - Computer Reassessment
2019	\$37,040	\$73,910	\$110,950	CR - Computer Reassessment
2011	\$30,700	\$94,040	\$124,740	DC - Decrease by comp-reass
2009	\$30,700	\$98,990	\$129,690	NC - Residential no change
2005	\$30,700	\$98,990	\$129,690	RC - Residential computer reass

Legal Lines

LN	Legal Description
1	TRACT 1 MINOR PLAT DB 7728 X 60, 1.8521 AC +/-

Property is assessed per KRS 132.20 on January 1st of each year. The current year assessments are updated and posted on the website in mid April. Information deemed reliable but not guaranteed. Data last updated: 03/02/2026.