

Five Corporate Center

9960 Corporate Campus Drive, Suite 3000

“Plug and Play” Opportunity - 28,713± SF



Five Corporate Center

9960 Corporate Campus Drive, Suite 3000 | Louisville, KY 40223



Property Highlights

Five Corporate Center is a dynamic work environment with all the amenities needed to nurture a healthy and productive lifestyle. One of five multi-tenant Class A office buildings within Corporate Campus, it's a professional business setting where your company runs smarter, faster, and more cost effectively. Conveniently located in the Hurstbourne corridor, near the Lagrange Road and Hurstbourne Parkway intersection.

- + 28,713± SF Sublease opportunity on 3rd floor
- + Sublease expires August 31, 2027
- + Move-in ready with furniture available
- + Highly visible building with signage opportunity
- + Restaurants, hotels, and retail amenities nearby
- + Common conference room located on the lower level
- + Access to I-64, I-265 & I-264
- + Near YMCA with child care services
- + Building backup generator
- + Parking ratio 5:1,000

For Sublease



Floor Plan

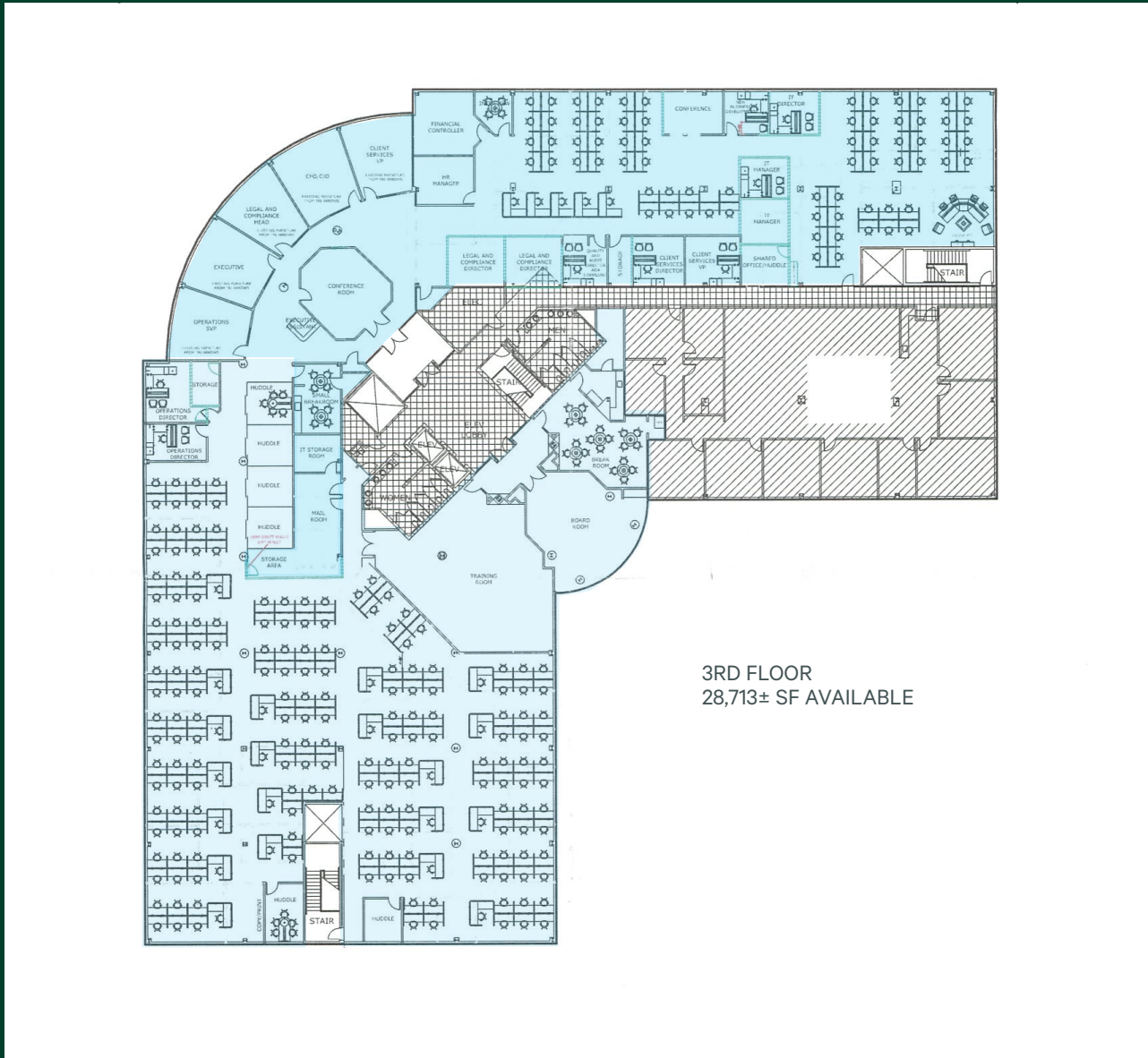

Contact Us

Jeff Dreher, SIOR, MBA
Senior Vice President
+1 502 412 7610
jeff.dreher@cbre.com

© 2024 CBRE, Inc. All rights reserved. This information has been obtained from sources believed reliable, but has not been verified for accuracy or completeness. You should conduct a careful, independent investigation of the property and verify all information. Any reliance on this information is solely at your own risk. CBRE and the CBRE logo are service marks of CBRE, Inc. All other marks displayed on this document are the property of their respective owners, and the use of such logos does not imply any affiliation with or endorsement of CBRE. Photos herein are the property of their respective owners. Use of these images without the express written consent of the owner is prohibited.