



For Lease
13,759 SF

For lease

6310A Cane Run Road
Louisville, Kentucky 40258
13,759 SF manufacturing/distribution building

Stephen C. Lannert, SIOR, CCIM, GRI
Executive Vice President
Steve.Lannert@jll.com
+1 502 394 2508

Property specifications

- 13,759 SF
- 13,663 SF warehouse; 96 SF office
- Fenced parking lot
- 200 amp, 277/480 volt, 3 phase
- 1" water line; 4" fire line
- 1" medium pressure gas line
- 6" sewer line
- 71 parking spaces
- Metal Halide lighting
- 3 docks and 3 levelers

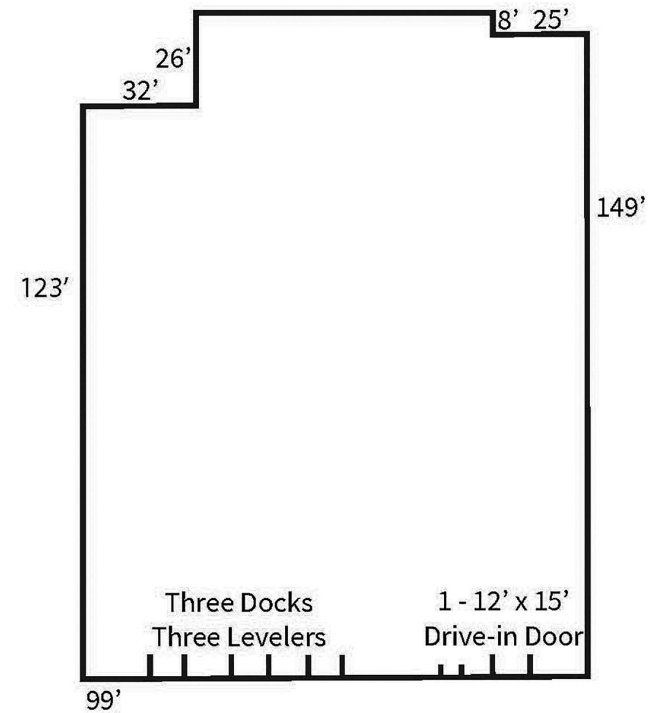
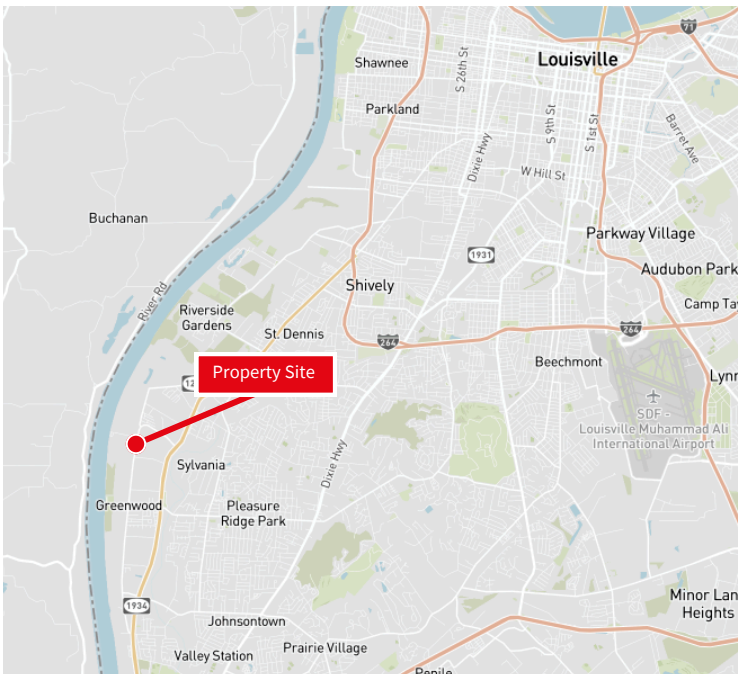

- One 12' x 15' drive-in door
- 20' clear height
- Wet sprinkler system
- Zoned M-3
- Located in the Riverport submarket
- 1 mile from Ohio River Port
- 10.9 miles from Louisville International Airport
- 4 miles to I-264 and the Snyder Freeway
- Built in 1991

Although information has been obtained from sources deemed reliable, JLL does not make any guarantees, warranties or representations, express or implied, as to the completeness or accuracy as to the information contained herein. Any projections, opinions, assumptions or estimates used are for example only. There may be differences between projected and actual results, and those differences may be material. JLL does not accept any liability for any loss or damage suffered by any party resulting from reliance on this information. If the recipient of this information has signed a confidentiality agreement with JLL regarding this matter, this information is subject to the terms of that agreement. ©2024. Jones Lang LaSalle Brokerage, Inc. All rights reserved.