

DISTILLERY | COMMONS

New Mixed-Use Redevelopment in Historic Irish-Hill Neighborhood



DISTILLERY
COMMONS

Now Leasing
Office | Retail | Entertainment

For Information Contact
Duncan Commercial Real Estate
(502) 292-5464

A Storied Past, A Vibrant Future.



TASTE



EXPLORE

Originally established in the 19th century, Distillery Commons began as a working bourbon distillery and played a key role in Louisville's booming spirits industry. The site's iconic brick buildings and rickhouses once stored thousands of barrels of aging whiskey, contributing to Kentucky's global reputation for bourbon.

Over the decades, the area evolved alongside the city—transitioning from industrial use to a hub for small businesses, artists, and creatives. Today, Distillery Commons is being thoughtfully redeveloped into a dynamic mixed-use destination, blending historic architecture with modern living, retail, and community spaces.

Rooted in Louisville's heritage and designed for today's urban lifestyle, Distillery Commons continues to pour new life into a historic landmark.



GATHER



CREATE

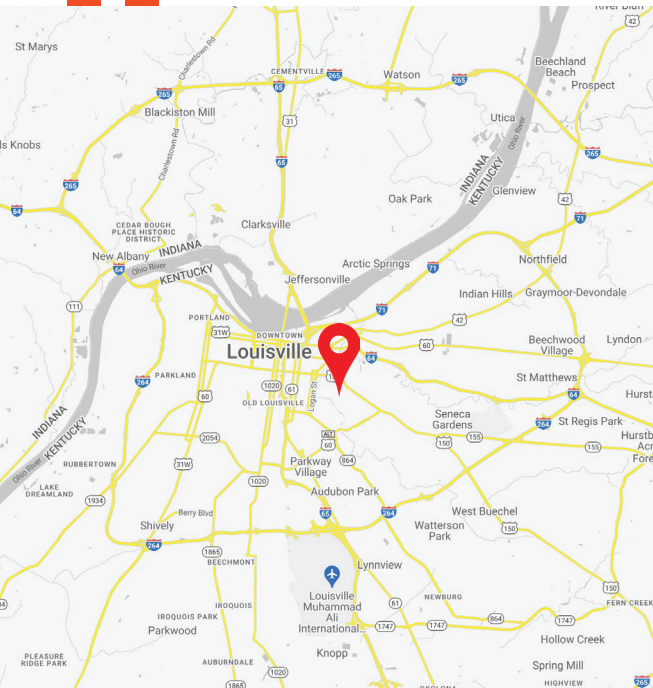

Property Highlights

- Located in the heart of Irish Hill Neighborhood
- 2,112 SF - 13,775 SF Available
- Accessible to I-64
- 1.8 Miles to Downtown
- Minutes from vibrant districts including, the Highlands, Nulu, and Germantown
- Historic distillery reimaged as a modern mixed-use space
- On-site parking
- Close to residential neighborhoods and major employers

Lease Rates



Office
\$25.00 | Full Service



Retail
\$22.00 | NNN



Basement
\$12.00 | NNN

Distillery Commons transforms a historic campus into nearly 300,000 square feet of creative office, dining, and entertainment experiences.

From a vibrant food hall and coworking hub to bourbon tasting, live music, and makers markets, it's set to become Louisville's favorite playground for tastemakers and explorers.

What's Around Town



Floor Plans

LEVEL 2

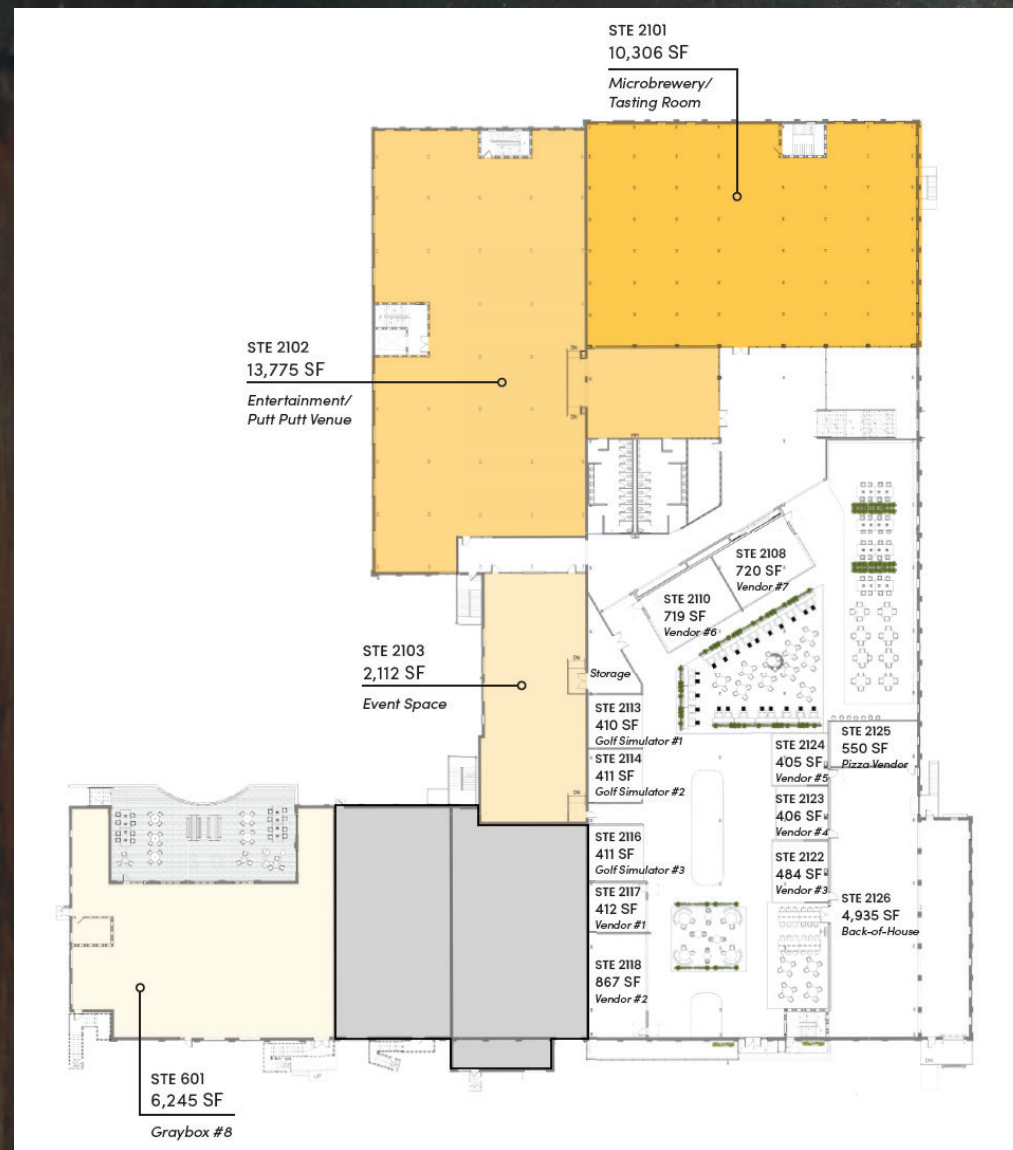

LEVEL 1



Floor Plans

LEVEL G

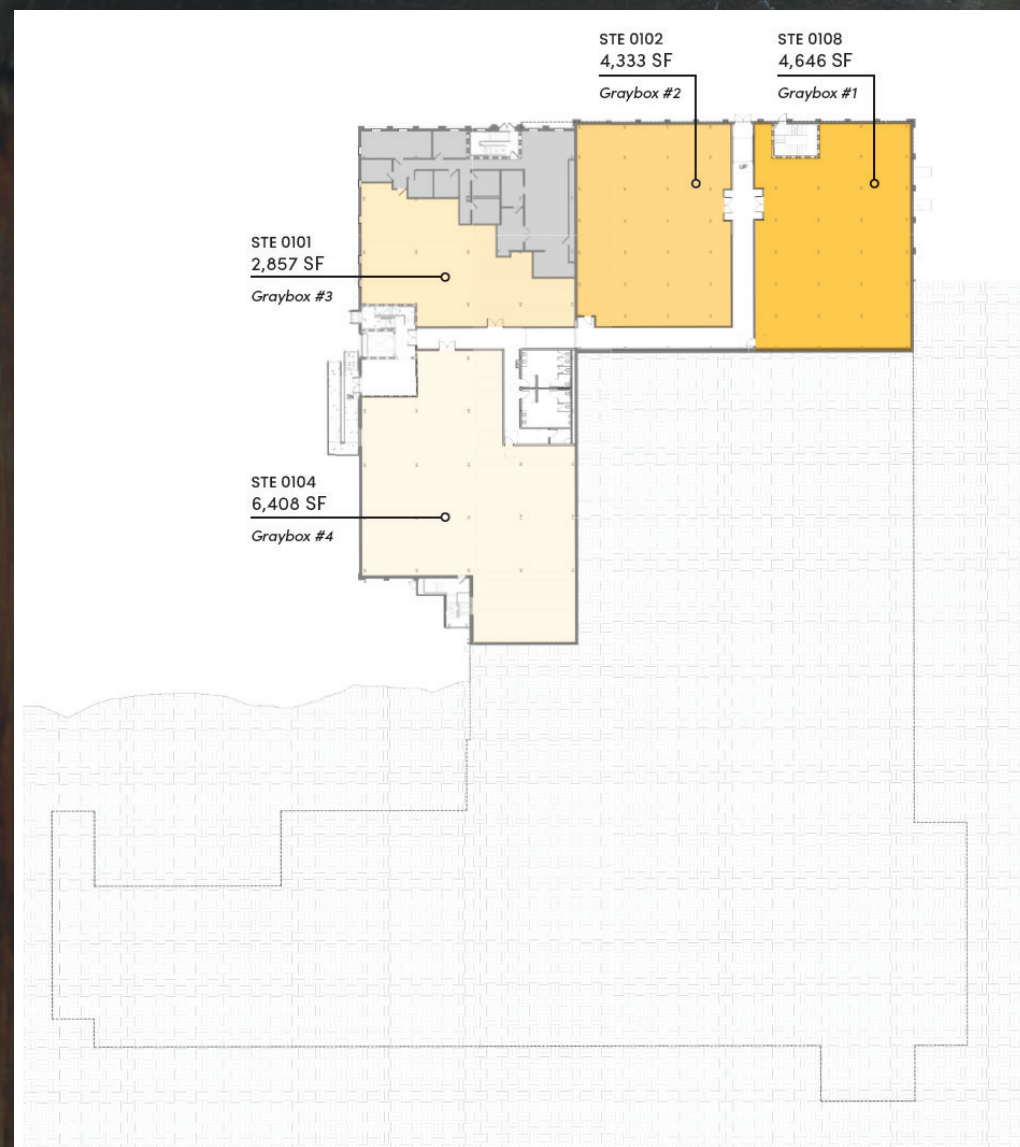

LEVEL B

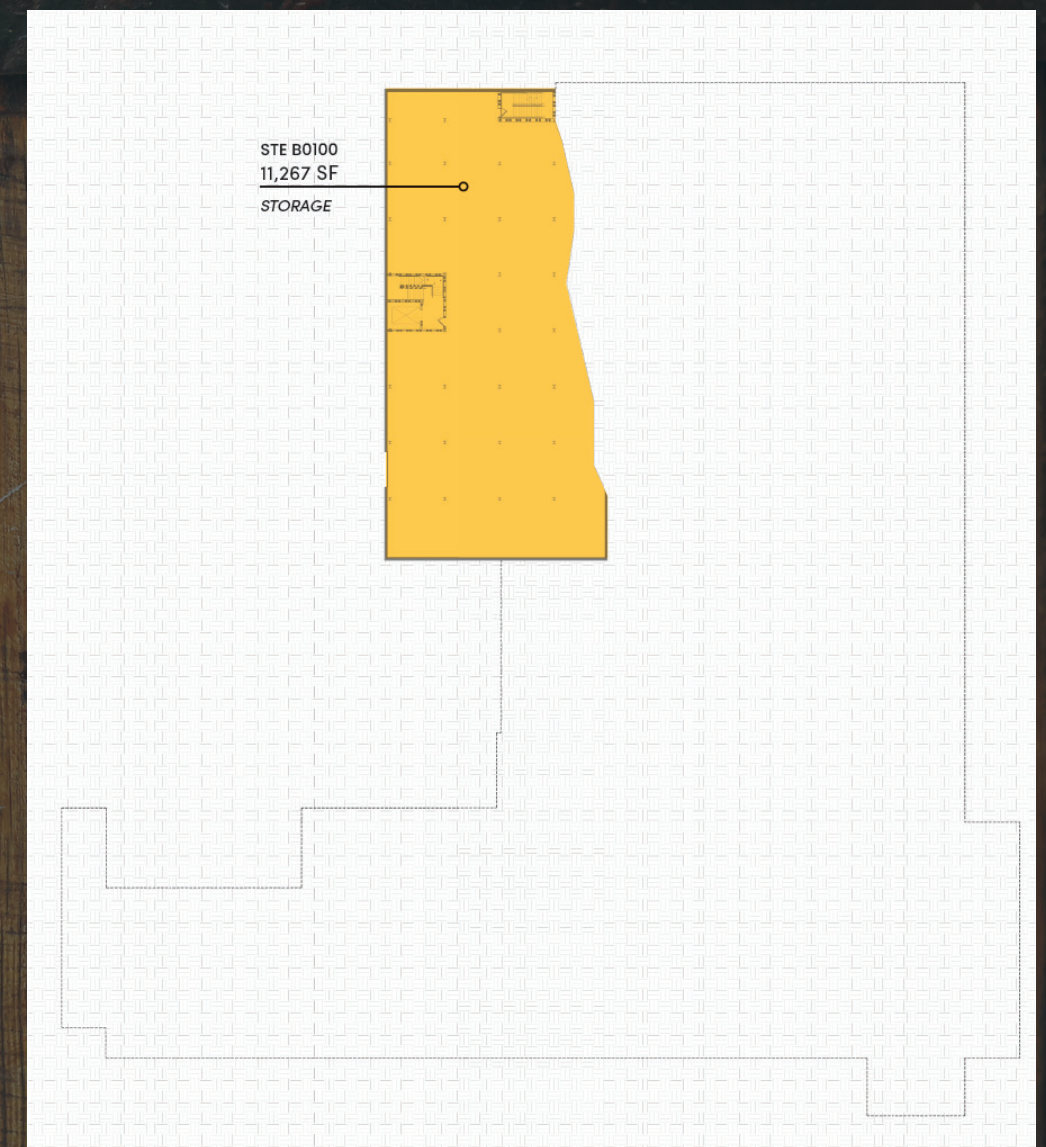

DISTILLERY || COMMONS

For Information Contact

Duncan Commercial Real Estate

Will Duncan, Todd Whitchurch, and Suzanne Cheek

(502) 292-5464



distillerycommons.com