



For lease

1480 South Tenth Street
Louisville, Kentucky 40210
34,944 SF distribution building

Stephen C. Lannert, SIOR, CCIM, GRI
Executive Vice President
Steve.Lannert@jll.com
+1 502 394 2508

 **JLL** SEE A BRIGHTER WAY

jll.com

Property specifications

- 34,944 SF
- 100 amp, 120/208 volt, 3 phase electric
- .5" water line; 6" fire line; 8" main
- .5" medium pressure gas line; 2" main
- 24" sewer line
- Five parking spaces
- Halide and LED lights

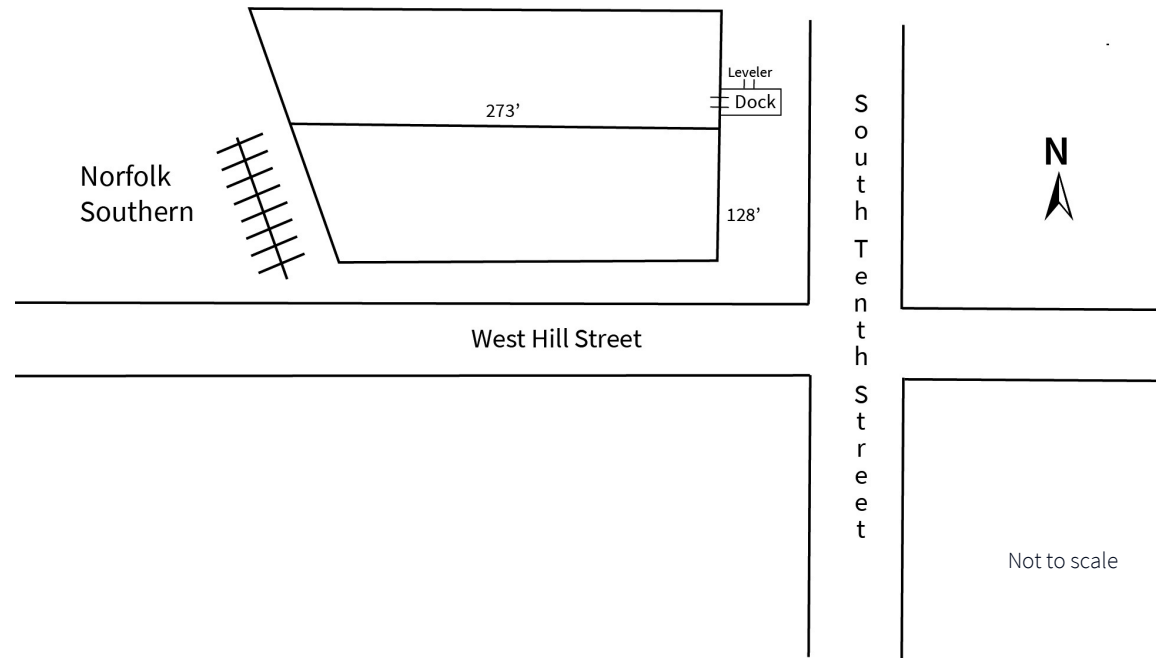
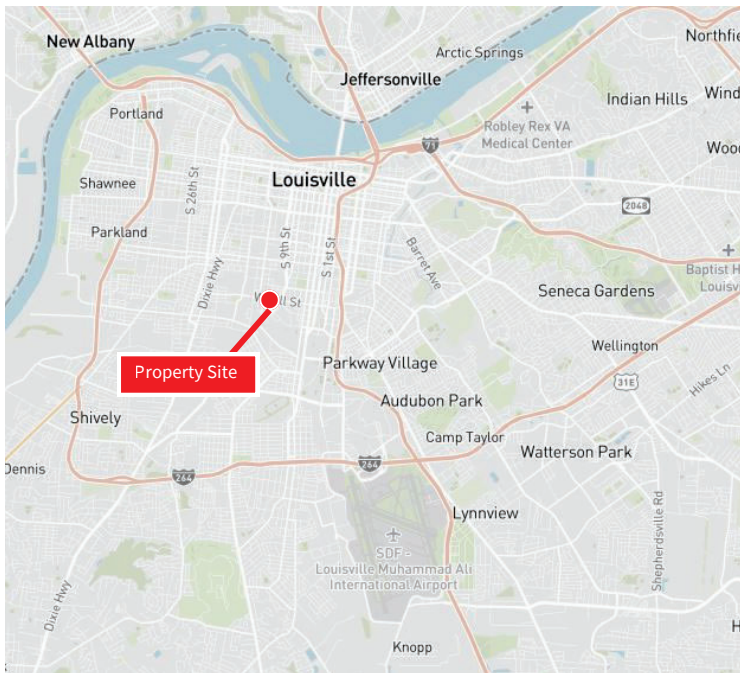

- One dock and one leveler
- 16' - 18' clear height
- Dry sprinkler system
- EZ-1 zoning
- Located in the Central City submarket
- Two miles to I-65
- Five miles from Louisville International Airport
- Built in 1925

Although information has been obtained from sources deemed reliable, JLL does not make any guarantees, warranties or representations, express or implied, as to the completeness or accuracy as to the information contained herein. Any projections, opinions, assumptions or estimates used are for example only. There may be differences between projected and actual results, and those differences may be material. JLL does not accept any liability for any loss or damage suffered by any party resulting from reliance on this information. If the recipient of this information has signed a confidentiality agreement with JLL regarding this matter, this information is subject to the terms of that agreement. ©2025. Jones Lang LaSalle Brokerage, Inc. All rights reserved.