

THIS DOCUMENT, AND THE IDEAS AND DESIGNS INCORPORATED HEREIN, IS THE PROPERTY OF K4 ARCHITECTURE, L.L.C. AND IS NOT TO BE USED, IN WHOLE OR IN PART, FOR ANY OTHER PROJECT WITHOUT THE WRITTEN AUTHORIZATION OF K4 ARCHITECTURE, L.L.C. COPYRIGHT 2007, K4 ARCHITECTURE, L.L.C. ALL RIGHTS RESERVED.

File Location: X:\2007 Projects\2007 K4-Chinami\Project\07-4466 River Valley - Multi Location Arch
Filename: 07-0466 A-101.dwg Plot Date: Feb. 13, 2008 7:59am

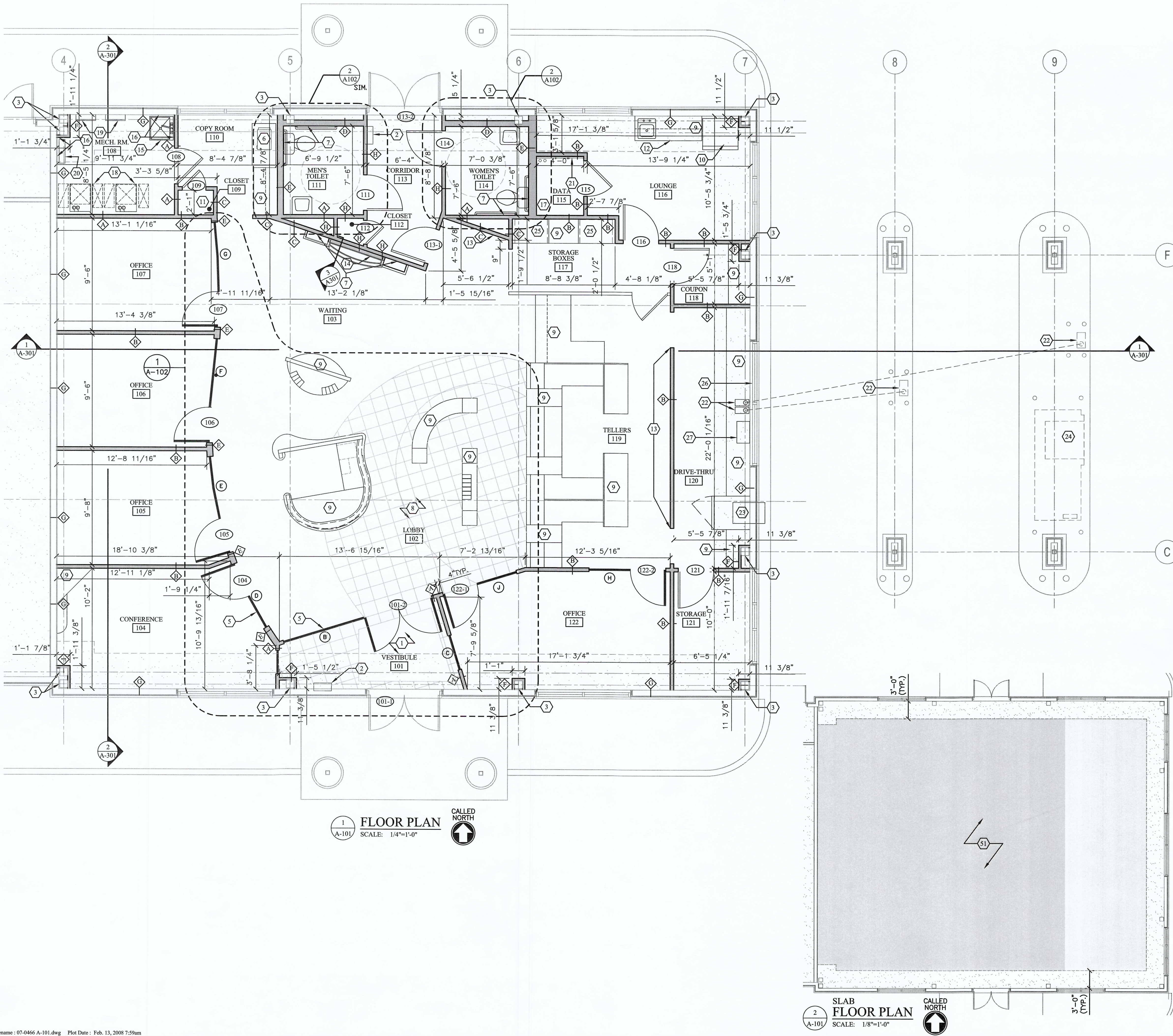

GENERAL NOTES:

- REFER TO T-001 FOR ADDITIONAL GENERAL NOTES.
- SEE DRAWING A-901 FOR DOOR AND ROOM FINISH SCHEDULES.
- PROVIDE BLOCKING TO ALL CASEWORK, COUNTERTOPS, EQUIPMENT, AND FIXTURES AS NEEDED. VERIFY BLOCKING LOCATION W/ SUPPLIER PRIOR TO INSTALLATION.
- GENERAL CONTRACTOR TO COORDINATE INSTALLATION OF BANKING EQUIPMENT, FURNITURE, MILLWORK AND ANY OTHER EQUIPMENT ON DRAWINGS.
- VERIFY OPENING REQUIREMENTS W/ EQUIPMENT SUPPLIER PRIOR TO INSTALLATION.
- FLOOR TRANSITIONS FOR DIFFERENT FLOORING MATERIAL OR CHANGES IN FLOOR PATTERN ORIENTATION SHALL OCCUR UNDER A DOOR WHEN IT OCCURS IN A DOORWAY.
- DIMENSIONS SHOWN ON FLOOR PLAN ARE ROUGH FRAMING DIMENSIONS UNLESS OTHERWISE NOTED ON DRAWING.

NOTES THIS DRAWING:

- WALK OFF MAT
- SEMI RECESSED FIRE EXTINGUISHER CABINET W/ A 10lb MULTIPURPOSE DRY CHEMICAL FIRE EXTINGUISHER UL RATED 4-A-B-C. FINAL LOCATION PER FIRE INSPECTORS RECOMMENDATIONS.
- EXISTING STEEL COLUMN.
- NOT USED.
- INTERIOR ALUMINUM STOREFRONT SYSTEM. SEE WINDOW TYPES FOR ELEVATION. SEE SPECIFICATIONS FOR TYPE.
- COPYER BY OWNER.
- PROVIDE BLOCKING IN WALL. ANCHOR VERTICAL 2'x8 FROM 30" A.F.F. UP TO 84" A.F.F. SEE GENERAL NOTE "D" THIS SHEET.
- SEE ENLARGED FLOOR PLAN ON SHEET A-102 FOR TILE LAYOUT.
- COUNTER TOPS / CASEWORK BY MILLWORK CONTRACTOR. SEE CASEWORK DRAWINGS.
- REFRIGERATOR BY OWNER.
- CHROME COATED ROD AND PLASTIC LAMINATE SHELF BY MILLWORK CONTRACTOR.
- SINGLE BOWL SINK IN COUNTERTOP W/ BASE AND WALL CABINETS.
- GRAPHIC WALL BY GRAPHIC CONTRACTOR. NO EQUIPMENT SWITCHES, OUTLETS, OR OTHER DEVICES SHALL BE LOCATED ON THIS WALL UNLESS COORDINATED W/ ARCHITECT.
- WATER FEATURE. SEE SPECIFICATIONS.
- MOP SINK. SEE PLUMBING DRAWINGS.
- MECHANICALLY FASTEN FRP PANEL FROM FINISH FLOOR TO 4'-0" AFF. INSTALL 5/8" GREEN BOARD BEHIND FRP PANEL AND 2'-0" BEYOND FRP PANEL IN ALL DIRECTIONS.
- DATA RACK AND COMPUTER EQUIPMENT BY OTHERS.
- MECHANICAL EQUIPMENT. SEE MECHANICAL DRAWINGS.
- ELECTRICAL PANELS. SEE ELECTRICAL DRAWINGS.
- WATER SERVICE. SEE PLUMBING DRAWINGS.
- TELEPHONE BOARD. COORDINATE FINAL LOCATION W/ ARCHITECT/ OWNER PRIOR TO INSTALLATION.
- PNEUMATIC TELLER SYSTEM. COORDINATE SIZE, LOCATION, & ROUTING WITH EQUIPMENT SUPPLIER. COORDINATE WORK W/ HVAC DUCT WORK, ELECTRICAL AND CEILING WORK.
- AHD BY EQUIPMENT SUPPLIER. VERIFY SIZE & LOCATION W/ EQUIPMENT SUPPLIER.
- ATM BY EQUIPMENT SUPPLIER. VERIFY SIZE & LOCATION W/ EQUIPMENT SUPPLIER.
- LOCK BOXES BY EQUIPMENT SUPPLIER. VERIFY SIZE AND LOCATION W/ EQUIPMENT SUPPLIER.
- DRIVE UP WINDOW BY EQUIPMENT SUPPLIER. VERIFY SIZE & LOCATION W/ EQUIPMENT SUPPLIER.
- TRANSACTION DRAWER BY EQUIPMENT SUPPLIER. VERIFY SIZE & LOCATION W/ EQUIPMENT SUPPLIER.
- OF 50. NOT USED.
- SHADED AREA INDICATES AREA OF NO CONCRETE FOR PLUMBING AND OTHER UTILITIES. ONCE UTILITIES ARE INSTALLED GENERAL CONTRACTOR TO INSTALL NEW SLAB TO MATCH EXISTING. NEW SLAB SHALL MATCH EXISTING SLAB ELEVATION. 4" CONCRETE FLOOR SLAB W/ 6# W14 x 14 WWF OVER 4" SUB BASE OF 4" GRAVEL MIN. AND A 10-MIL VAPOR BARRIER. SAWCUT CONTROL JOINTS (10'-0" o.c. MAX.) AT CONTRACTOR'S OPTION, PROVIDE KEVED COLD JOINTS IN LIEU OF SELECTED SAWCUT JOINTS. COORDINATE JOINT LOCATION WITH FLOOR FINISHES.

PARTITION LEGEND:

- 5/8" GYPSUM BOARD EACH SIDE ON 3 5/8" METAL STUDS AT 16" O.C. EXTEND ENTIRE PARTITION ASSEMBLY TO UNDERSIDE OF DECK. HORIZONTAL BRIDGING AT MID HEIGHT OF WALL AND AT CEILING LINE (MIN.). ATTACH BRACE(KICKERS) AS REQUIRED TO SUPPORT WALL. FILL STUD CAVITY WITH 3 1/2" SOUND ATTENUATION BLANKETS.
- 5/8" GYPSUM BOARD (EXTEND GYPSUM BOARD 3" ABOVE CEILING) EACH SIDE ON 3 5/8" METAL STUDS (EXTEND STUDS 6" ABOVE CEILING) AT 16" O.C. . ATTACH BRACE(KICKERS) AS REQUIRED TO SUPPORT WALL. FILL STUD CAVITY WITH 3 1/2" SOUND ATTENUATION BLANKETS.
- LAY 2'-0" OF 3 1/2" SOUND ATTENUATION BLANKETS ON THE PERIMETER OF THE CEILING IN ALL ROOMS THAT HAVE SOUND ATTENUATION BLANKETS IN THE WALLS.
- 5/8" GYPSUM BOARD (EXTEND GYPSUM BOARD 3" ABOVE CEILING) EACH SIDE ON 3 5/8" METAL STUDS (EXTEND STUDS 6" ABOVE CEILING) AT 16" O.C. . ATTACH BRACE(KICKERS) AS REQUIRED TO SUPPORT WALL.
- 5/8" GYPSUM BOARD (EXTEND GYPSUM BOARD 3" ABOVE CEILING) ONE SIDE ON 6" METAL STUDS (EXTEND STUDS 6" ABOVE CEILING) AT 16" O.C. . ATTACH BRACE(KICKERS) AS REQUIRED TO SUPPORT WALL.
- 5/8" GYPSUM BOARD EACH SIDE ON 6" METAL STUDS AT 16" O.C. EXTEND ENTIRE PARTITION ASSEMBLY TO UNDERSIDE OF DECK. HORIZONTAL BRIDGING AT MID HEIGHT OF WALL AND AT CEILING LINE (MIN.). ATTACH BRACE(KICKERS) AS REQUIRED TO SUPPORT WALL. FILL STUD CAVITY WITH 3 1/2" SOUND ATTENUATION BLANKETS.
- 5/8" GYPSUM BOARD OUTSIDE FACE ON 2 1/2" METAL STUD @ 16" O.C. EXTEND GYPSUM BOARD 3" ABOVE CEILING. BRACE(KICKERS) WHERE REQUIRED TO SUPPORT WALL.
- INSTALL R-19 BATT INSULATION (FULL HEIGHT). FINISH EXISTING STUDS WITH 5/8" GYPSUM BOARD. EXTEND GYPSUM BOARD TO 3" ABOVE CEILING HEIGHT.
- ONE HOUR FIRE RATED PARTITION (U.L. DESIGN NO. U419) FLOOR AND CEILING RUNNER. 5/8" GYPSUM BOARD EACH SIDE ON 3 5/8" METAL STUDS AT 16" O.C. EXTEND ENTIRE PARTITION ASSEMBLY TO UNDERSIDE OF FIRE RATED CEILING ASSEMBLY @ 13'-0" A.F.F. COORDINATE FINAL HEIGHT WITH GC. (SEE DETAIL 2/A111). ATTACH BRACE(KICKERS) AS REQUIRED TO SUPPORT WALL. FILL STUD CAVITY WITH 3 1/2" SOUND ATTENUATION BLANKETS.

SPECIAL NOTE:

* ALL INTERIOR PARTITIONS ARE NON-LOAD BEARING UNLESS OTHERWISE NOTED

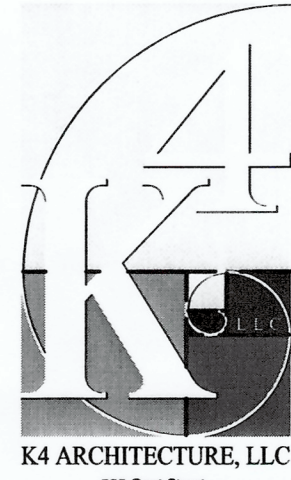

555 West Street
Channahon, Ohio 43020
Tel: (615) 455-5005
Fax: (615) 455-5008
Webpage: www.k4places.com
Email: k4arch@k4places.com

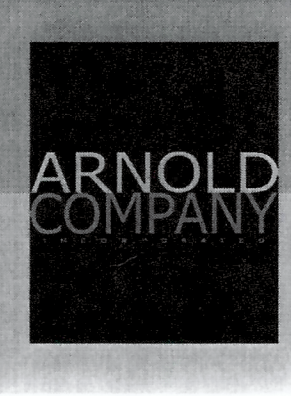

2592 E. US 224
DECATUR, IN 46733
PHONE: 260.724.2626
FAX: 260.724.2610

TENANT FINISH FOR:
**RIVER VALLEY
FINANCIAL BANK**
PAOLI PIKE
FLOYDS KNOBS, INDIANA

REVISIONS / SUBMISSIONS		
NO.	DESCRIPTION	DATE
1	ISSUED FOR PERMIT & CONSTRUCTION	1.11.2008

FLOOR
PLAN

Drawn By: MDC, BMR
Scale: AS NOTED
Job No.: 07-0466

A-101