

FLEX / INDUSTRIAL FOR LEASE



196 Turner Commons Way - Suite 140
Lexington, KY 40508



Amy Mellinger
C: 859.619.5369
Amy@BALRealEstate.com



PROPERTY DESCRIPTION

Block and Lot is pleased to present a newly renovated flex/industrial facility in the premier, mixed-use development, The Commons. Ideally situated less than 5 miles from I-75/I-64, this property provides unparalleled accessibility to Lexington's major transportation arteries.

Under a mile from New Circle Road and only blocks from downtown, the location offers exceptional convenience to area retail and Lexington's Central Business District.



BLOCK+LOT

BALREALESTATE.COM

PROPERTY HIGHLIGHTS

AVAILABLE SF: **6,068**

LEASE RATE: **\$7.50 NNN**

- **AVAILABLE NOW**
- Customizable Flex / Industrial Space
- 13' - 28' ceiling heights
- Prime location in The Commons, a premier mixed-use development
- Walking trails and abundant green space
- Security patrol with surveillance cameras
- Convenient surface parking with LED lighting
- Close proximity to retail and Lexington's Central Business District
- Easy access to I-75, I-64, and New Circle Road



BLOCK+LOT

BALREALESTATE.COM

KEY FEATURES

Ready-to-Transform "Cold Shell" Flex Space

YEAR BUILT: **1959, Renovated: 2024**

LIGHTING: **LED**

CLEAR HEIGHT: **13' - 28'**

COLUMN SPACING: **15' x 17'**

ZONING: **I-1 (Light Industrial)**

SPRINKLER SYSTEM: **Dry**

HEATING: **Gas**

ROOF TYPE: **New Metal**

FLOOR TYPE: **Concrete Slab**

POWER: **60+ AMP**

DRIVE-IN DOORS: **1**

INSULATION: **Fully Insulated**



BLOCK+LOT

BALREALESTATE.COM

LOCATION AERIAL



THE COMMONS RENDERING



THE COMMONS MASTER PLAN

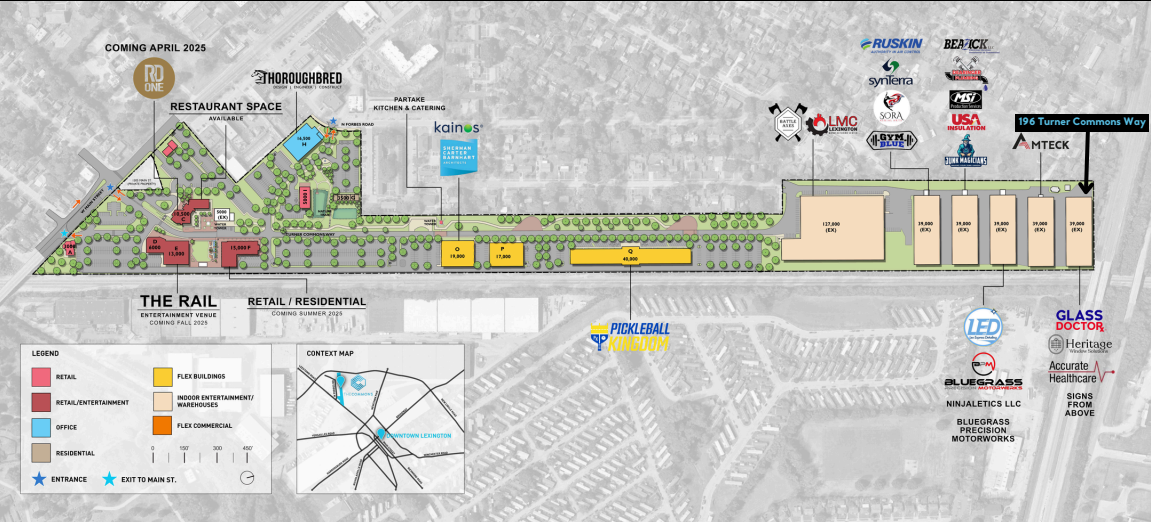

BLOCK+LOT

BALREALESTATE.COM

FLOOR PLAN

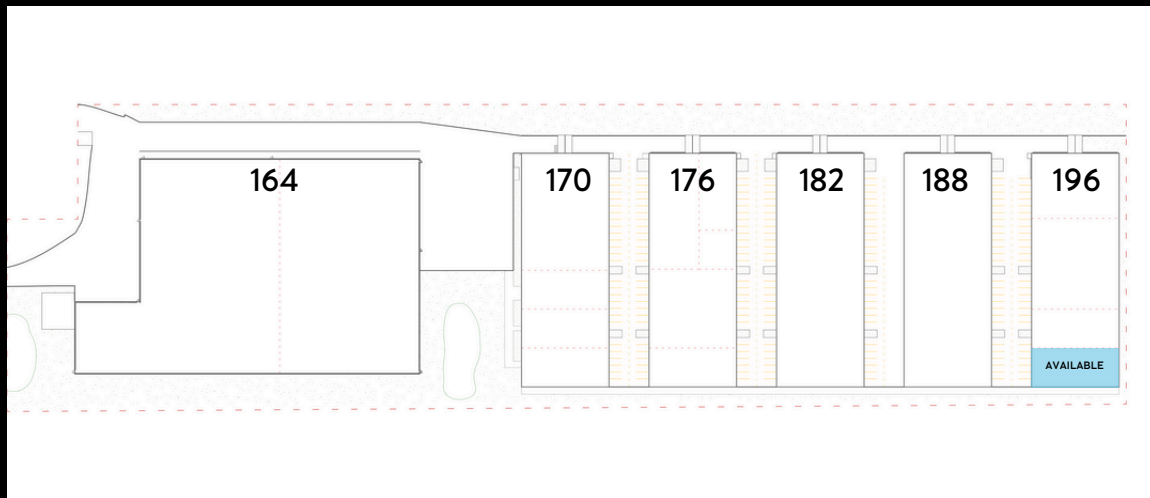

BLOCK+LOT

BALREALESTATE.COM

PROPERTY FLOOR PLAN



BLOCK+LOT

BALREALESTATE.COM

- | Key Name | Comments |
|----------|---|
| 1. | Verify all existing Dimensions on site. |
| 2. | All existing windows shall remain full height to serve as a visual link. |
| 3. | All work should reflect the local Kennedy Building Code and American with Disabilities Act. |
| 4. | Fire Extinguishers shall be provided. |
| 5. | All interior metal chairs are to be painted "10" spot or 11. |
| 6. | Emergency and exit lighting shall be provided in accordance with all national local codes. |
| 7. | Electrical wiring must meet the latest requirements of the National Electrical Code. |
| 8. | Lighting fixtures shall provide the appropriate amount of foot candles for intended use. |
| 9. | The design of these plans will not be performing requirements on this project. Therefore it is the responsibility of the building owner to uphold the latest code requirements. |
| 10. | WPC Systems shall conform to the latest building codes and Raze Building Standards. |
| 11. | Dimensions are shown from South to North. |

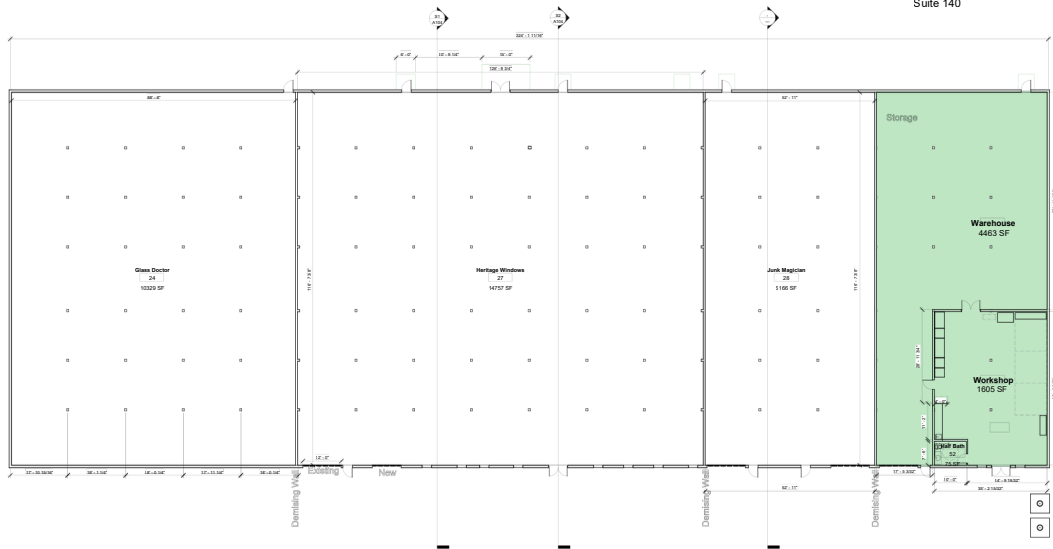

① Level 1
1" = 10'-0"

Add header on all door openings



www.turnerproperty.com

Consultant
Address
Address
Address
Phone

Consultant
Address
Address
Address
Phone

Consultant
Address
Address
Address
Phone

Consultant
Address
Address
Address
Phone

Consultant
Address
Address
Address
Address

[illegible]

196 Turner
Commons Way

Project Number	02
Date	07.26.22
Drawn By	Brandon Sarrett
Checked By	Otis Cveticanin

A100

Scale 1" = 10'-0"

07/20/22 11:25 AM

PHOTOS



BLOCK+LOT

BALREALESTATE.COM

PHOTOS



BLOCK+LOT

BALREALESTATE.COM