

For Sale

2003 Boundary Oak Drive | Radcliff, KY



SITE
±22 AC

31W

Walmart Fuel

Walmart Neighborhood Market

BURGER KING

TACO BELL

Hampton Inn & Suites

COLTON'S Steak House & Grill

CANDLEWOOD SUITES

BOUNDARY OAK

Huddle House

McDonald's

Holiday Inn Express

FIVESTAR

3,124 VPD

26,888 VPD

7,765 VPD

S Wilson Rd

Abound

31W

SUBWAY

TONY WILCOX
502.694.8116 | tony.wilcox@srsre.com



For Sale

2003 Boundary Oak Drive
Radcliff, KY

Property Specifications

LAND AVAILABLE

±22 AC

SALES PRICE

\$770,000



About the Property

- ±22 AC prime development opportunity in Radcliff, KY
- Ideal for mixed-use, entertainment, hospitality, and retail uses
- Adjacent to Boundary Oak Distillery, creating strong synergy and destination appeal
- Excellent opportunity to create a destination-oriented lifestyle and entertainment hub
- Large, contiguous site allows for flexible planning and phased development
- Strong growth corridor within Hardin County, supported by tourism and military-driven demand
- Rare opportunity to develop a landmark project with public-sector support in one of North Central Kentucky's most active markets

Join These Retailers



TONY WILCOX
502.694.8116 | tony.wilcox@srs.com

SRS REAL ESTATE PARTNERS

Regional Map View

Kentucky

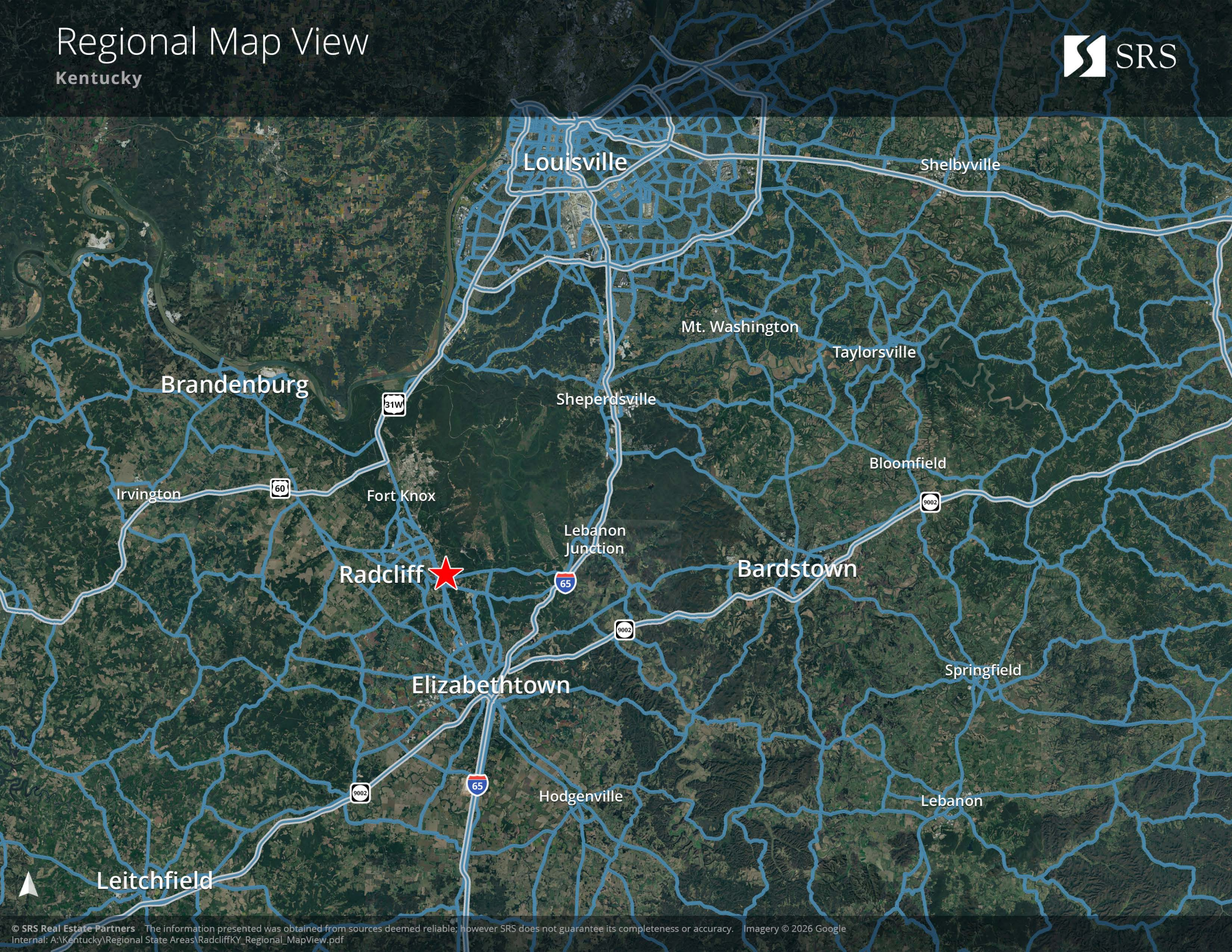

Radcliff 

Louisville

Shelbyville

Mt. Washington

Taylorsville

Sheperdsville

Brandenburg

Bloomfield

Irvington

Fort Knox

Lebanon Junction

Bardstown

Springfield

Elizabethtown

Lebanon

Hodgenville

Leitchfield



Radcliff Trade Area

Radcliff, KY



2003 Boundary Oak Dr

Radcliff, KY



SITE
±22 AC

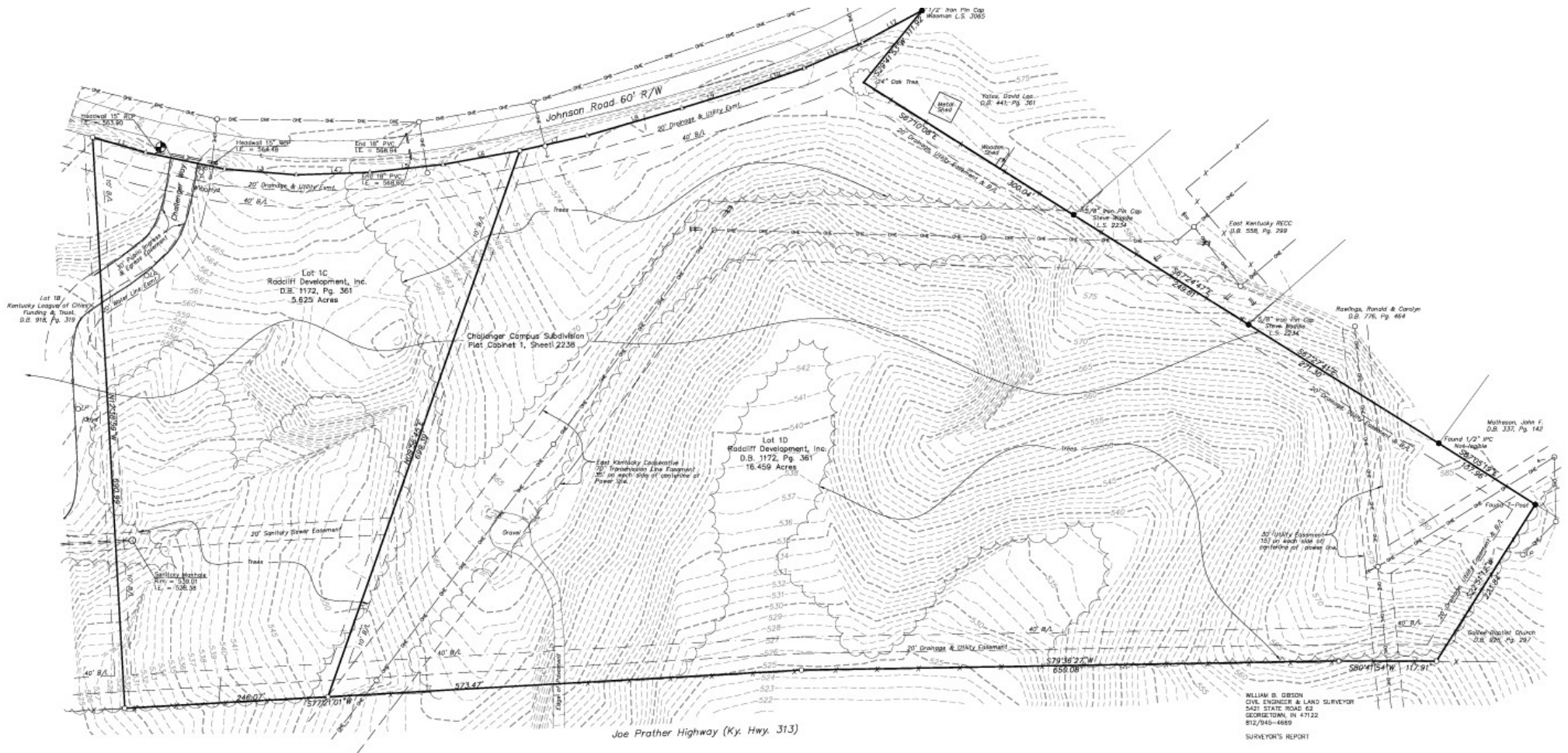



Area Snapshot

5 MILES

45,763 Population	41,306 Total Daytime Population	\$87,859 Average Household Income	18,638 Total Households
-----------------------------	--	--	--------------------------------------

7 MILES

70,792 Population	68,087 Total Daytime Population	\$88,388 Average Household Income	28,819 Total Households
-----------------------------	--	--	--------------------------------------

10 MILES

100,869 Population	107,578 Total Daytime Population	\$89,661 Average Household Income	39,588 Total Households
------------------------------	---	--	--------------------------------------

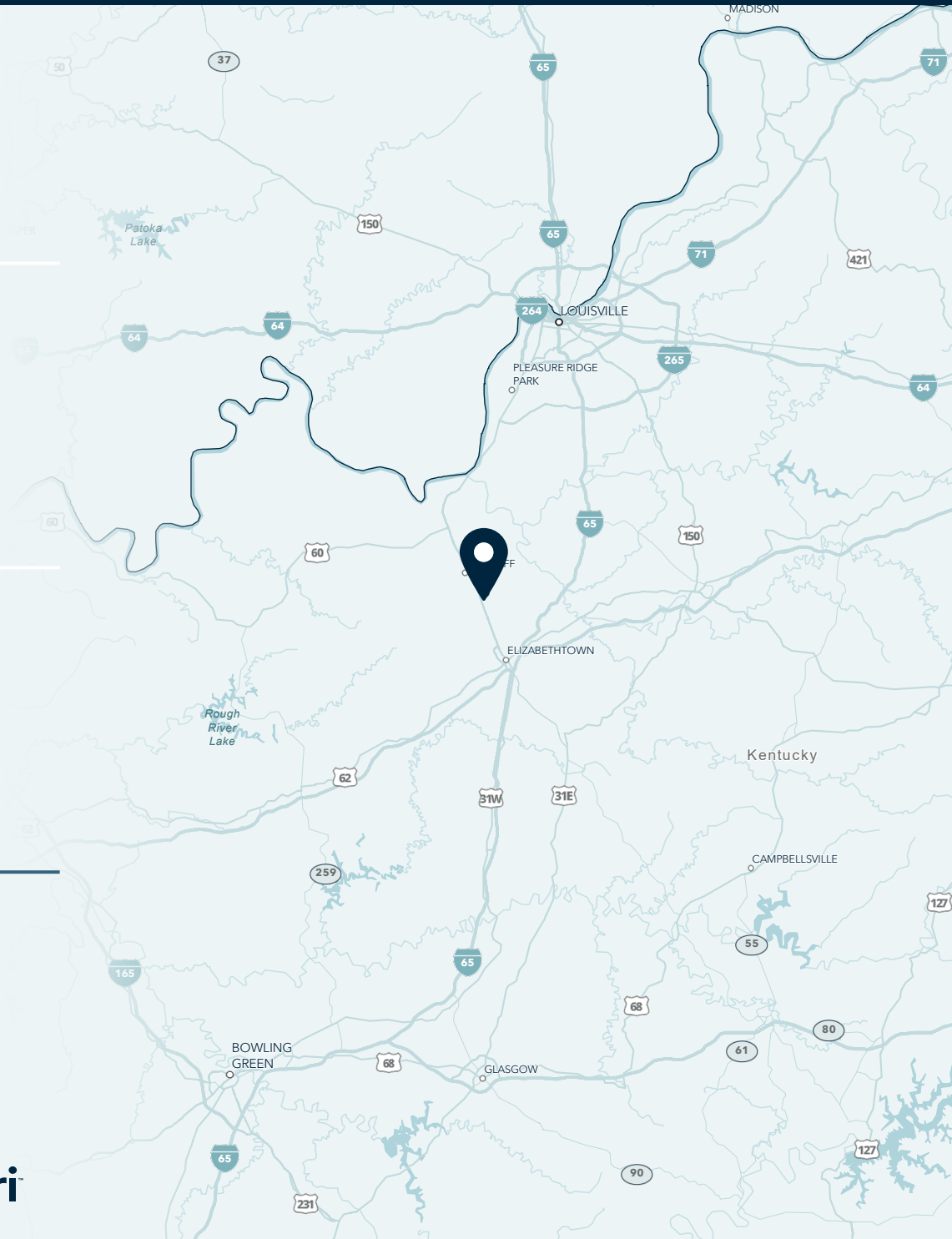

Want more? Contact us for a complete demographic, foot-traffic, and mobile data insights report.



Ring of 10 Miles

Key Facts

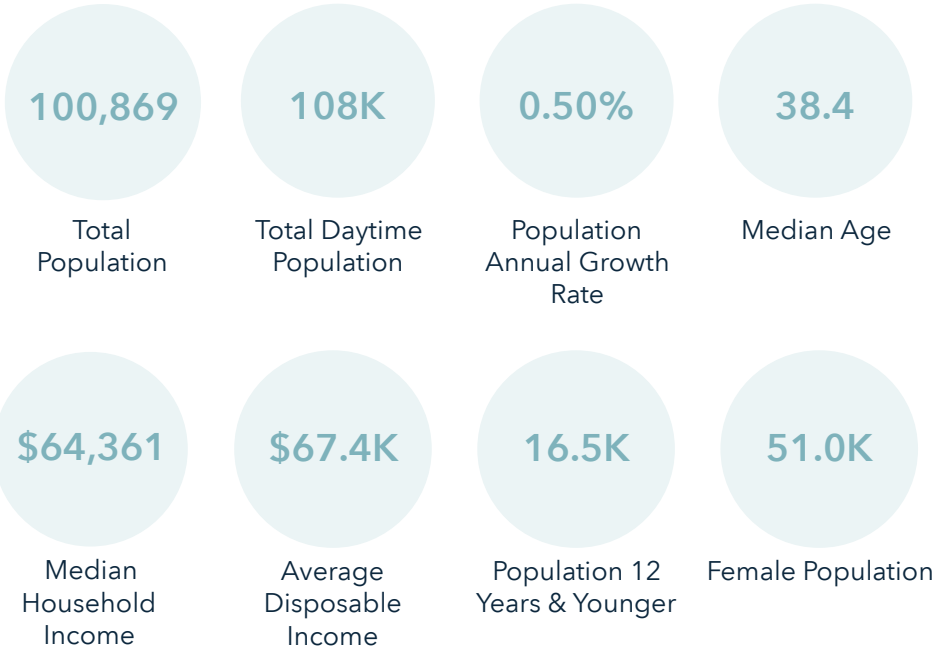

Annual Household Spending

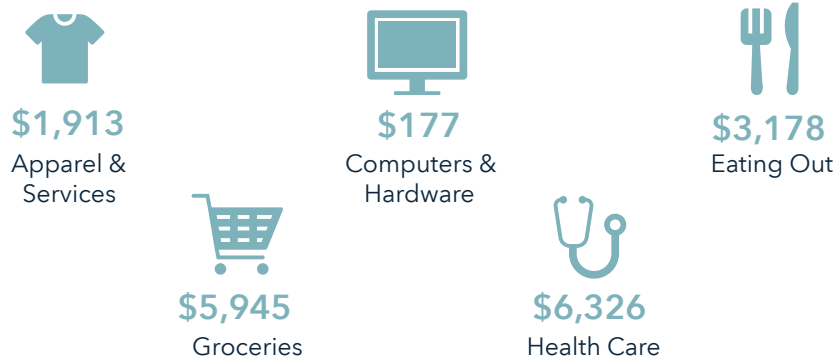

Annual Lifestyle Spending

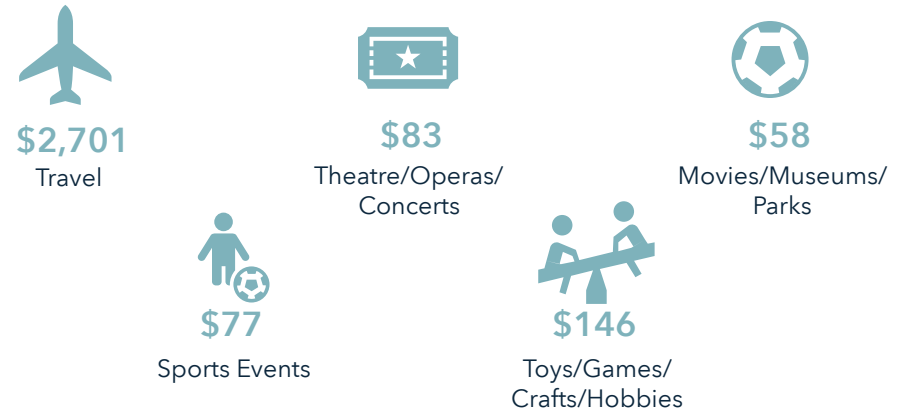

Race

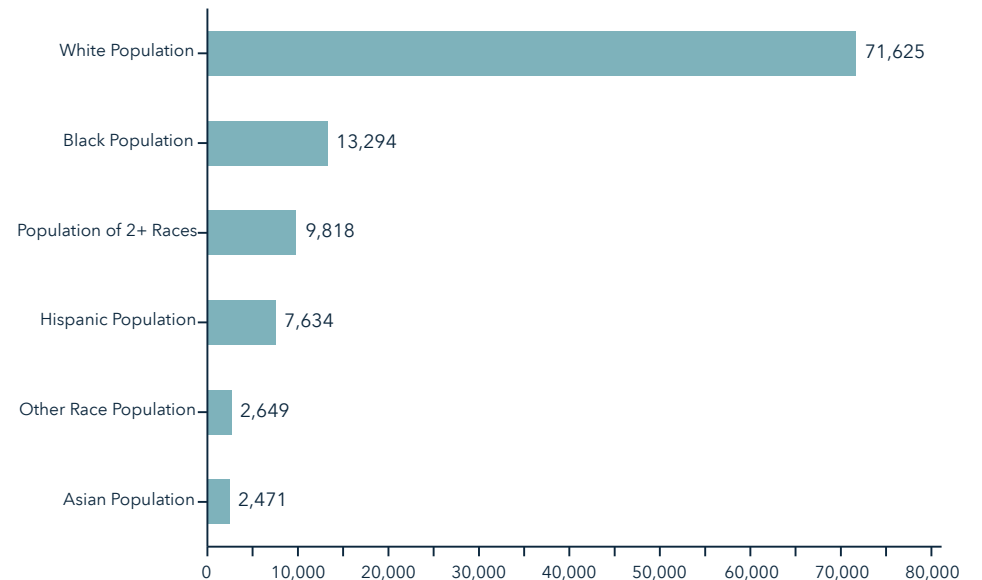



Data for 01/31/2025 - 01/30/2026



VISITS TREND

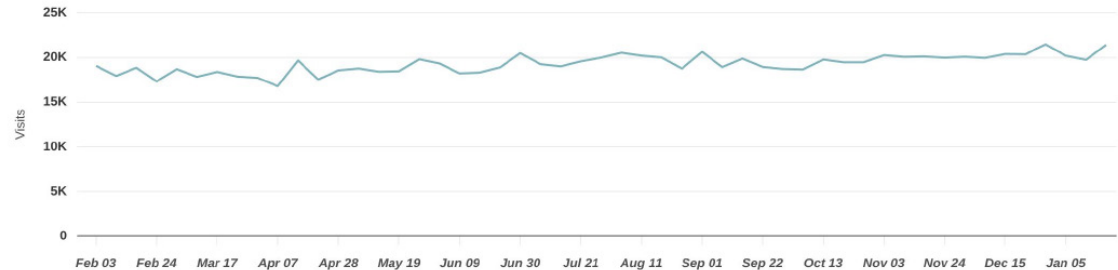

TRADE AREA

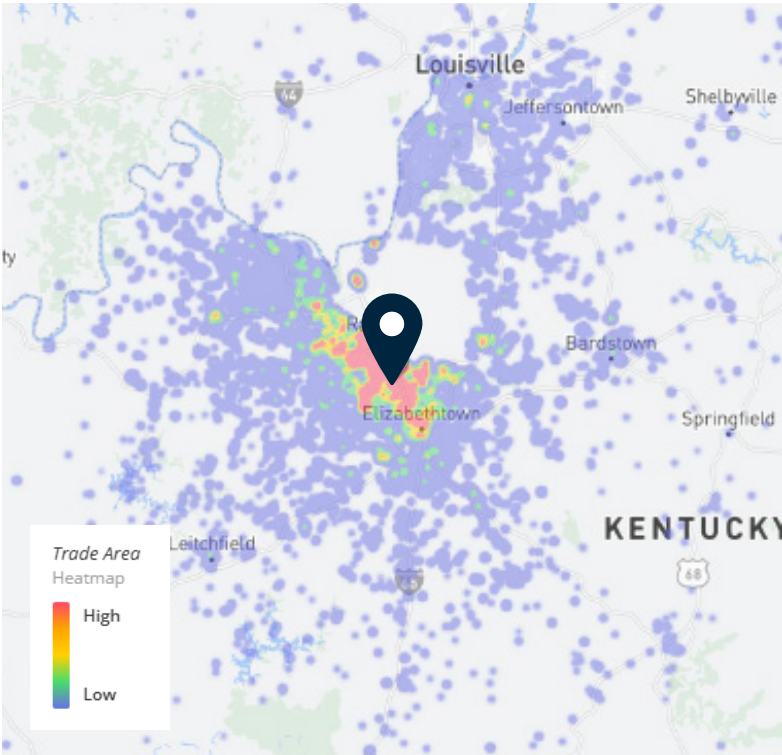

DAILY VISITS

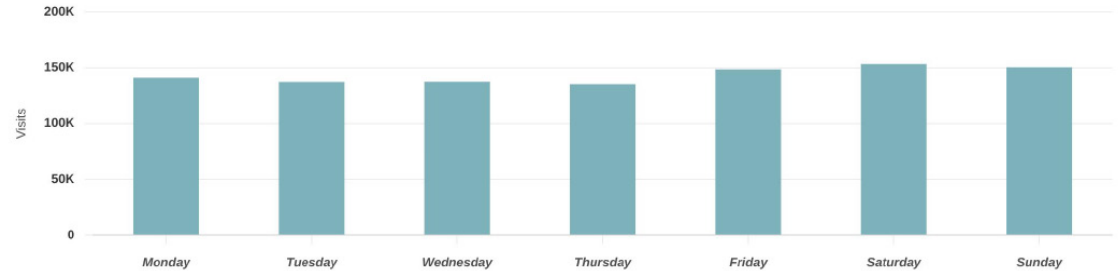

TRADE AREA COVERAGE BY DISTANCE

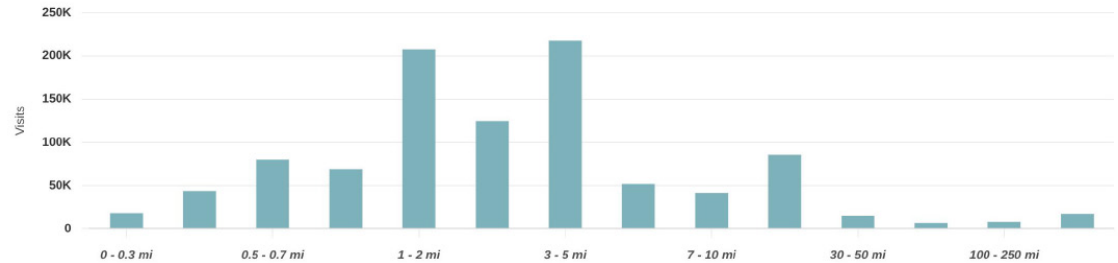

Want more? Contact us for a complete demographic, foot-traffic, and mobile data insights report.



SRS REAL ESTATE PARTNERS

6100 Dutchmans Lane, Suite 1200
Louisville, KY 40205
502.399.8949

SRSRE.COM

©2026 SRS. All Rights Reserved.

The information presented was obtained from sources deemed reliable;
however SRS does not guarantee its completeness or accuracy.