

# 4200 Champions Trace

Louisville, KY 40218

28,000+/- SF Available June 1<sup>st</sup>, 2025



## Property Features

- + 28,000+/- total SF
- + 6,500+/- SF office area
- + 3 dock doors
- + 1 box truck height door
- + 1 (14' X 12') drive-in door
- + 18'-22' clear height
- + Fully temperature controlled warehouse
- + Ample power (480v, 3-phase)
- + Fenced side yard
- + ~1 mile to I-264
- + For Lease: \$8.50/SF/YR, NNN

## Contact Us

**Blake Scinta, CCIM**  
First Vice President  
+1 502 412 7620  
blake.scinta@cbre.com

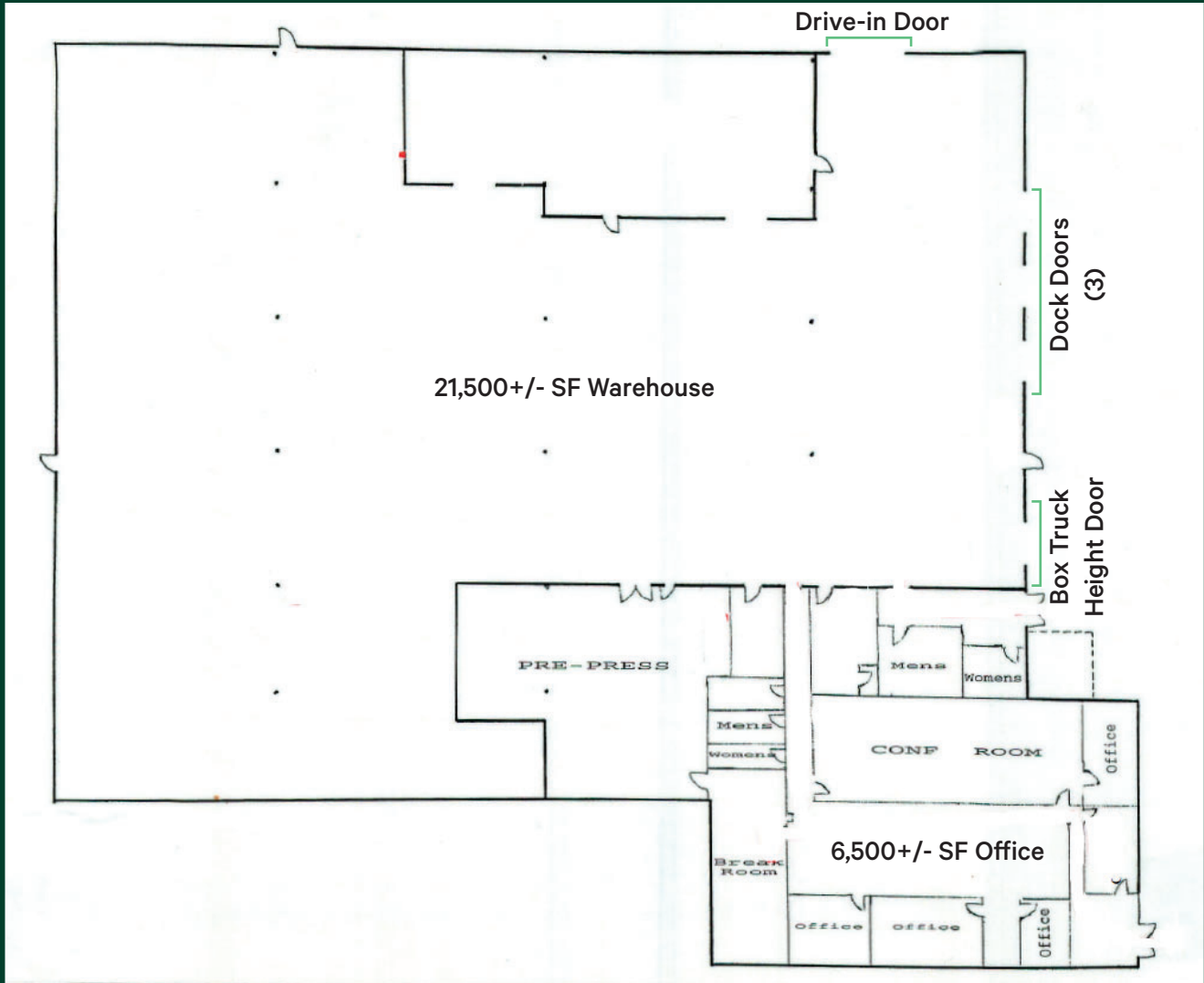

© 2025 CBRE, Inc. All rights reserved. This information has been obtained from sources believed reliable, but has not been verified for accuracy or completeness. You should conduct a careful, independent investigation of the property and verify all information. Any reliance on this information is solely at your own risk. CBRE and the CBRE logo are service marks of CBRE, Inc. All other marks displayed on this document are the property of their respective owners, and the use of such logos does not imply any affiliation with or endorsement of CBRE. Photos herein are the property of their respective owners. Use of these images without the express written consent of the owner is prohibited.