

JEFFERSON COUNTY PVA

7800 DIXIE HWY

| | |
|----------------------------|---|
| Mailing Address | 1414 NORTHWIND RD, LOUISVILLE, KY 40207-1665 |
| Owner | BHPH PROPERTIES LLC |
| Parcel ID | 111200870000 |
| Land Value | \$405,110 |
| Improvements Value | \$125,680 |
| Assessed Value | \$530,790 |
| Approximate Acreage | 0.6236 |
| Property Class | 445 COM OFFICE |
| Deed Book/Page | 12253 40 |
| District Number | 500009 |
| Old District | 25 |
| Fire District | PLEASURE RIDGE PARK |
| School District | Jefferson County |
| Neighborhood | 45 / COM DIXIE HIGHWAY CORRIDOR |
| Home Rule City | Jefferson County |
| Sheriff's Tax Info | View Tax Information ↗ |
| County Clerk | Delinquent Taxes ↗ |



Details & Photos



OFFICE BLDG



Property Details

| | |
|---------------------------|----------------|
| Use Description | OFFICE BLDG |
| Year Built | 1995 |
| Basement Area | 0 sq. ft. |
| Basement Finished? | No |
| Construction Frame | Fire Resistant |
| Stories | 1.00 |
| Above Grade Sq Ft. | 912 sq. ft. |

Photos



Property Sketch

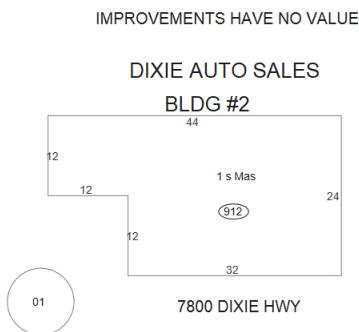

Miscellaneous Improvements

Paving

Map Tips

Use the "Labels" dropdown menu to display additional map text: house number, dimensions, and more.

Use the "Layers" dropdown menu to display recent sales.

Click the  icon below to view the map in LOJIC to view floodplain, zoning, and additional detailed info.

Sales History

| Deed Book/Page | Price | Date | Previous Owner |
|------------------------|-----------|------------|------------------------|
| 12253 40 | \$0 | 01/19/2022 | BPH PROPERTIES LLC |
| 9845 0706 | \$475,000 | 02/16/2012 | COX MILLARD G & MARY K |
| 5005 0935 (N/A Online) | \$0 | 01/01/1978 | OWNER UNKNOWN |

Assessment History

| Record Year | Land | Improvements | Total | Reason |
|-------------|-----------|--------------|-----------|----------------------------|
| 2023 | \$405,110 | \$125,680 | \$530,790 | CR - Computer Reassessment |
| 2023 | \$416,620 | \$22,430 | \$439,050 | SP - SPLIT OR MERGER |
| 2019 | \$826,530 | \$22,430 | \$848,960 | CR - Computer Reassessment |
| 2015 | \$700,550 | \$0 | \$700,550 | CR - Computer Reassessment |
| 2013 | \$583,780 | \$10 | \$583,790 | N - No Change in Value |

Legal Lines

LN Legal Description

- 1 .62 AC, TRACT 1 MINOR PLAT DB. 12253 X 40, WS DIXIE HGWY, 150 FT NE OF COFER AV
- 2 E, 159 X 169 AVG

Property is assessed per KRS 132.20 on January 1st of each year. The current year assessments are updated and posted on the website in mid April. Information deemed reliable but not guaranteed. Data last updated: 01/08/2026.