

Summary

Parcel Number 23035919
 Location Address 2592 PALUMBO DR
 LEXINGTON KY 40509
 Tax District District 01
 Tax Rate 1.2638
 Acres 2.1
 Legal Description D-570 LAKEVIEW INDUSTRIAL LOT 19 21
 Property Class C - COMMERCIAL
 PVA Neighborhood 721 - WINCHESTER
 Land Use Code (410) C-INDUSTRIAL
 USA/RSA Map 43
 Map Block 022
 Lot 19 - 21
 Subdivision LAKEVIEW INDUSTRIAL #3 CONSL
 Cabinet/Slide D-570
 ND-1 Zone
 Overlay
 PDR
 Map Scale 200
 Block B
 Council District 7
 LFUCG Zoning I-1 - LIGHT INDUSTRIAL
 Deeded SqFt 91476
 Frontage / Out of 217 / 75-OUT OF 58.752 AC



Owner

[ROB PROP LLC](#)
 C/O THE GIBSON CO
 1050 MONARCH ST STE 200
 LEXINGTON KY 40513
 January 1, 2025 Owner
 ROB PROP LLC
 C/O THE GIBSON CO

Commercial Improvement Information

Card	1	Year Built	1984
Building No	1	Above Grade Sqft	42,000
Structure Code/Desc	401-MFG/PROCESS	Total Basement Sqft	
Units	1		

Accessory Information

Card 1

Description	Year Built	Size	Area	Grade
PAVING CONCRETE AVERAGE	1984		39,500	C -AVERAGE

Sales

Sale Date	Sale Price	Deed Book	Deed Page	Sales Validity	Owner	Previous Owner	Recording
6/18/2004	\$4,275,000	2467	430	MULTIPLE PROPERTIES	ROB PROP LLC	H & JS HOLDING COMPANY	2467 430
10/15/1992	\$1,000,000	1648	748	ARMS LENGTH TRANSACTION	H & JS HOLDING COMPANY	GENERAL INDUSTRIAL CORP	1648 748
6/1/1984	\$550,000	1343	512	ARMS LENGTH TRANSACTION	GENERAL INDUSTRIAL CORP	P & M PROPERTIES	1343 512

Valuation

	2025	2024	2023	2022
Fair Cash Value	\$1,600,000	\$1,600,000	\$1,600,000	\$1,600,000
Agricultural Value Land	\$0	\$0	\$0	\$0
Agricultural Value Total	\$0	\$0	\$0	\$0
Exempt	\$0	\$0	\$0	\$0
Taxable Value	\$1,600,000	\$1,600,000	\$1,600,000	\$1,600,000

Sketches

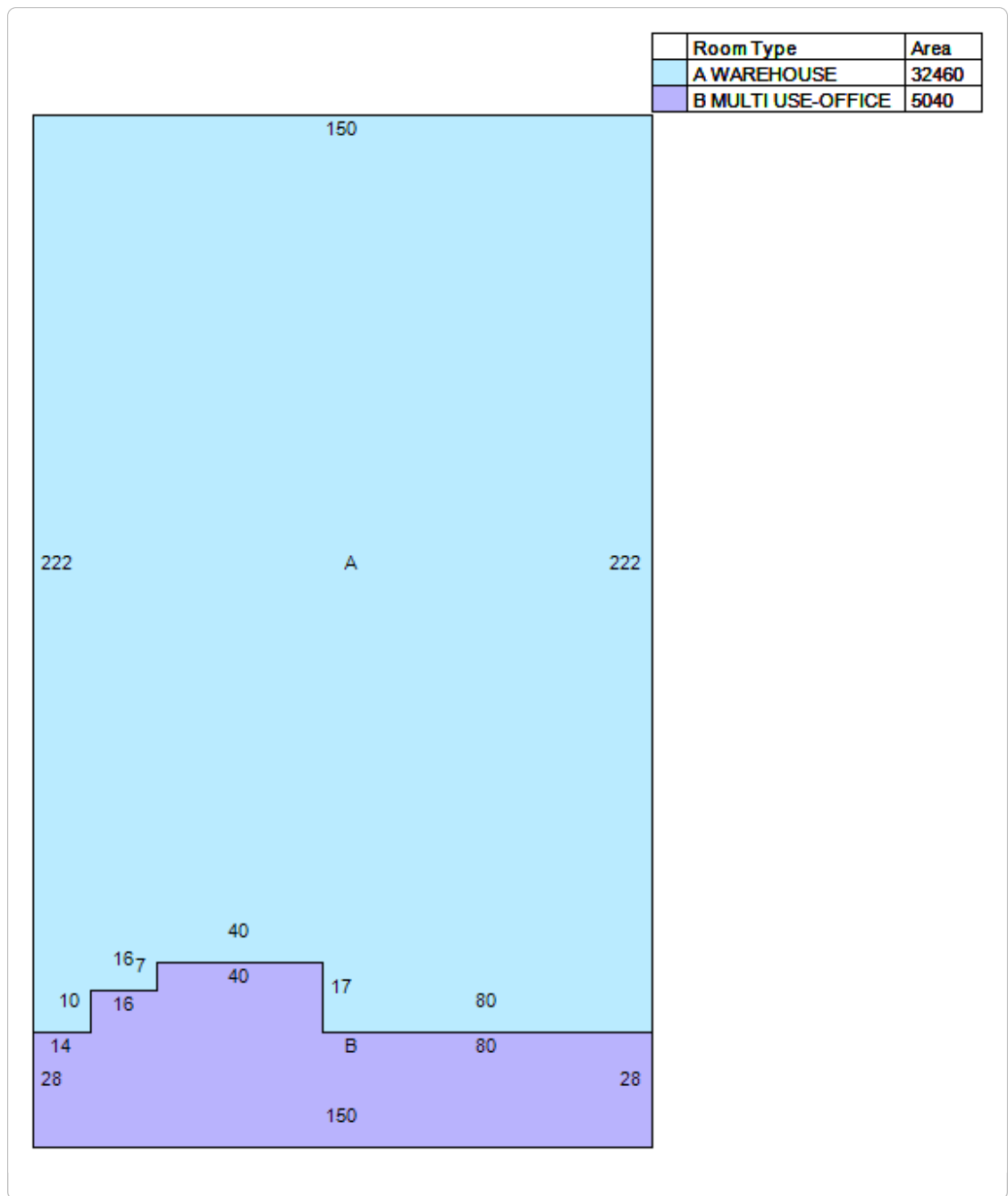

Photos



No data available for the following modules: Assessment Notice, Residential Improvement Information, Comparable Sales List, .

The Fayette County Property Valuation Administrator's Office makes every effort to produce the most accurate information possible. No warranties, expressed or implied, are provided for the data herein, its use or interpretation.
| [User Privacy Policy](#) | [GDPR Privacy Notice](#)
[Last Data Upload: 12/18/2025, 5:28:10 AM](#)

Contact Us

