 **JLL** SEE A BRIGHTER WAY

# For lease

13100 Eastpoint Park Boulevard  
Louisville, KY 40223

First Floor Office Space  
2,290 RSF Available

# For lease

## Suite 201

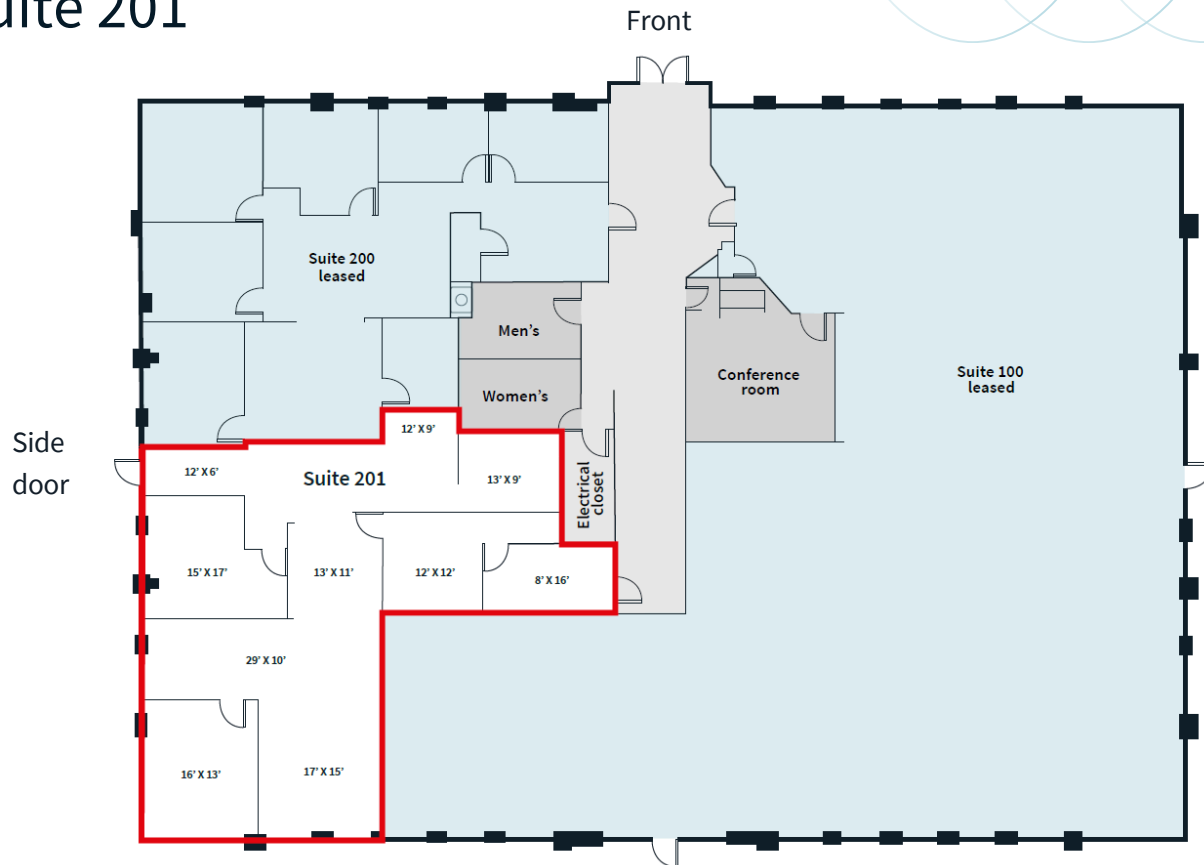

### Highlights

- First floor space with entrance off of building lobby
- Additional side door leading to parking lot
- Nice, large building conference room with water available for use by tenants
- Two private offices with windows, availability to add additional ones
- The space has lots of windows providing natural light
- Abundant surface parking adjacent to building
- Location is within minutes of I-265, I-64 and I-71
- Local ownership with responsive management

JLL

**John David Hale**

Vice President

John.Hale@jll.com

(502) 541 1881