

103 Village Market Path Georgetown, KY

Ceiling: Open to Structure (Block Bearing Bar Joist)

- Bot. of Bar Joist: 11'-8 3/8"
- Bot. of Steel Deck: 13'-8 3/4"

Flooring: None

- Portion of 6" Slab Poured at Front Entry
- Gravel Fill from Slab Extends to Rear of Space

Base: None

Walls: Bare Masonry Block (No Stud Framing or Gy. Bd.)

Existing Sq. Ft.: 1,304.58 (Interior)

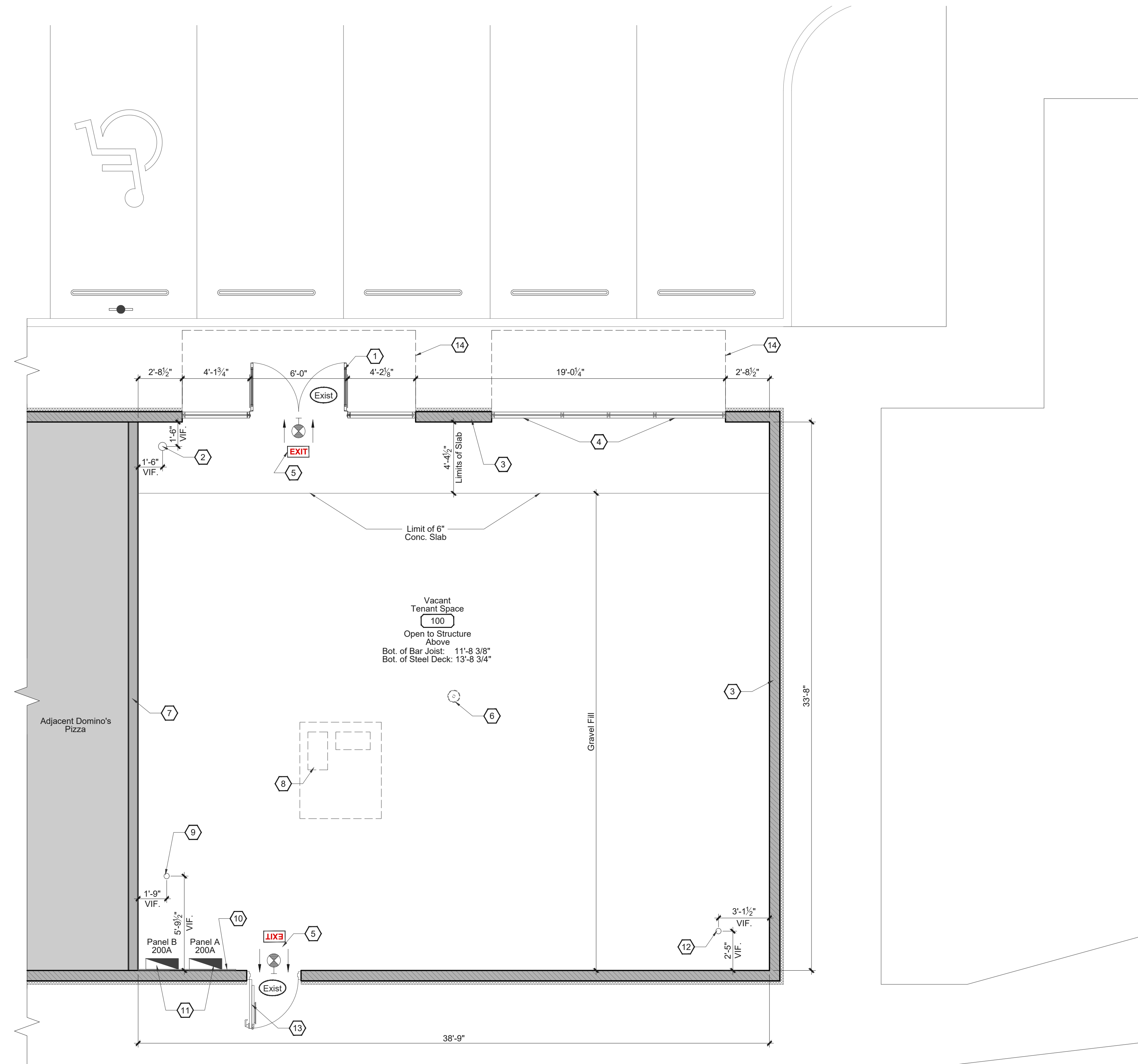

Keynotes ①

1. EXISTING 6'-0" STOREFRONT DOOR SYSTEM.
2. APPROXIMATE LOCATION OF EXISTING 4" SPRINKLER RISER.
3. EXISTING EXTERIOR MASONRY BLOCK WALL.
4. EXISTING STOREFRONT GLAZING AND FRAMING SYSTEM.
5. EXISTING WALL MOUNTED ILLUMINATED EXIT SIGNAGE
6. EXISTING OVERHEAD MOUNTED TEMPORARY LIGHTING.
7. EXISTING TENANT SEPARATION WALL.
8. DASHED LINED INDICATE APPROXIMATE LOCATION OF HVAC DUCT PENETRATION ABOVE.
9. APPROXIMATE LOCATION OF EXISTING SANITARY STUB.
10. EXISTING ELECTRICAL EQUIPMENT PLYWOOD BACKBOARD.
11. EXISTING ELECTRICAL PANELS. 200A EACH.
12. APPROXIMATE LOCATION OF EXISTING SANITARY CLEANOUT.
13. EXISTING EGRESS DOOR W/ CRASHBAR HARDWARE AND CLOSER
14. DASHED LINE INDICATES EXTERIOR ARCHITECTURAL AWNING ABOVE DOOR AND WINDOW LOCATIONS..

General Notes

1. DIMENSIONS ON DRAWINGS WERE TAKEN FROM FIELD MEASUREMENTS AND OWNER PROVIDED INFORMATION. ACTUAL DIMENSIONS MAY VARY FROM THOSE INDICATED
2. VERIFICATION OF THE EXISTING CONDITIONS OF OTHER SYSTEMS, EQUIPMENT, AND CONSTRUCTION NOT INDICATED WITHIN SHALL BE BY OTHERS.
3. FIELD MEASURED DRAWINGS ARE PROVIDED FOR GENERAL GUIDANCE. ANY ENTITY TAKING RELIANCE UPON THE INFORMATION WITHIN IS TO VERIFY THE ACCURACY OF ALL DATA USING ACCEPTED INDUSTRY STANDARD PRACTICES OF OBTAINING FIELD DATA.
4. SITE ELEMENTS DEPICTED ARE FOR GENERAL REFERENCE ONLY. ALL SITE ELEMENTS SHALL BE VERIFIED BY SURVEY, DEED, PLAT, SITE DEVELOPMENT PLANS, AND EXISTING CONSTRUCTION DOCUMENTS AS REQUIRED.

REVISIONS

NO.	TITLE	DATE

1 Existing Floor Plan - Vacant Tenant Space  
1/4" = 1'-0"

Legend

- INDICATES ITEMS ABOVE
- (Exist) DOOR DESIGNATION
- ROOM NAME XXX ROOM NAME AND NUMBER

**R&P DESIGN INC.**  
**ARCHITECTS**  
3213 Summit Square Place, Ste 100  
Lexington, Kentucky 40509  
(859) 231-8404

**Existing Tenant Space**  
**103 Village Market Path**  
**Georgetown, Kentucky 40324**

DRAWN BY: Staff	JOB NO: 1123
CHECKED BY: Staff	DATE: 011123

SHEET NUMBER:  
**AS-101**