

FIT-UP GENERAL NOTES:

- TOTAL FIT-UP "WORK" AREA: 5,000 SQ. FT.
- ZONED COMMERCIAL
- 2013 KENTUCKY BUILDING CODE, 2006 INTERNATIONAL BUILDING CODE
- USE & OCCUPANCY: CHAPTER 3, USE AND OCCUPANCY CLASSIFICATION (SEC 305.2) "DAYCARE" (FOR SENIORS)
- MECHANICAL, ELECTRICAL, PLUMBING & FIRE SUPPRESSION ARE DESIGN/BUILD BID. FIELD VERIFY ALL EXISTING CONDITIONS. CONTRACTOR TO SPECIFY MECHANICAL UNIT UPGRADES, ADDITIONS, &/OR CHANGES IN THE BID SUBMITTAL. CONTRACTOR TO SUBMIT REQUIRED DOCUMENTS TO OBTAIN ALL REQUIRED PERMITS & APPROVALS.
- BUILDING PERMIT APPLICATION & PLAN REVIEW WILL BE SUBMITTED BY THE CONTRACTOR.
- ANY ADDITIONAL WORK DISCOVERED BEYOND THE SCOPE OF THIS PLAN MUST BE REPORTED TO THE ARCHITECT & APPROVED BY THE OWNER BEFORE BEING PERFORMED.
- ALL DIMENSIONS ARE TO THE FACE OF STUDS. ALL DIMENSIONS FROM AN EXISTING WALL TO BE FIELD VERIFIED. ALL WALLS ARE 3/8" STEEL STUDS UNLESS NOTED OTHERWISE.
- ALL DOOR HARDWARE MUST BE LEVER TYPE.
- ALL WALLS, CEILINGS, & FLOOR TYPES MUST HAVE A CLASS I OR CLASS II FINISH RATING PER ASTM E84 & ASTM E648.

WALL LEGEND:

- EXISTING WALL & STRUCTURE, FIELD VERIFY WALL TYPE.
- NEW WOOD STUD WALLS W/ 5/8" GYP. BOARD ON EACH SIDE. COORDINATE WALL HEIGHT WITH CEILING HEIGHT.
- PER KBC 425.3, ALL DAYCARE FACILITIES IN A MIXED USE BUILDING MUST BE SEPARATED BY FIRE BARRIER TENANT WALL NO LESS THAN 1-HOUR RATING. EXTEND WALL TO UNDERSIDE OF ROOF DECK ABOVE & FIRE CAULK ALL PENETRATIONS. UL RATED WALL ASSEMBLY \*505, NOM. 2x4 STUDS @ 16" O.C. W/ 3/8" TYPE-X GYP. BRD. ON EACH SIDE.
- 1 FIBER REINFORCED PLASTIC WALL PANELS, MARLITE "STANDARD FRP" W/ PEBBLE FINISH OR EQUAL FROM FLOOR TO CEILING.
- 2 FIBER REINFORCED PLASTIC WALL PANELS, MARLITE "STANDARD FRP" W/ PEBBLE FINISH OR EQUAL FROM TOP OF COUNTERTOP BACKSPLASH TO UNDERSIDE OF WALL CABINETS ABOVE.
- 3 PAINTED WOOD CHAIR RAIL WITH VINYL WALL COVERING BELOW IT & PAINTED WALLS ABOVE IT.
- NOTE: ALL WALLS NOT MARKED TO BE PAINTED PER TENANT'S SPECIFICATIONS.

FLOORING TYPES:

- LWF: LAMINATED WOOD FLOOR.
- CPT: CARPET
- T-1: 12"x12" V.C.T. FLOORING W/ 4" VINYL BASE.
- EXPC: EXPOSED CONCRETE, SEALED.

NOTES:

- 4'x4' SHEET OF 1/2" PLYWOOD SECURED OVER GYP. BOARD @ 48" AFF.
- WATER HEATER
- 24" FLOOR TOP SINK W/ HEAVY DUTY SPOUT/HOSE CONNECTION @ 30" AFF. PROVIDE F.R.P. ON ALL WALLS ABOVE.
- PROVIDE WASHER/DRYER HOOK-UP & VENT.
- BULKHEAD @ 8'-0" AFF.
- PASS-THRU @ 36" AFF. (LEVEL W/ COUNTERTOP IN FOOD PREP) W/ BULK HEAD @ 6'-8" AFF.
- (2) 36"W X 72"H WINDOWS @ 8" AFF, PROVIDE HORIZONTAL MULLION @ 36" AFF.
- (1) 36"W. X 72"H. WINDOW @ 8" AFF, PROVIDE HORIZONTAL MULLION @ 36" AFF.
- NEW 4" FLOOR DRAIN.
- 48" WIDE ACCESSIBLE PREFABRICATED SHOWER BASE.
- (2) 36" X 36" WINDOWS @ 44" AFF.
- (1) 36" X 36" WINDOW @ 44" AFF.
- LAMINATE COUNTERTOP W/ BACKSPLASH (OPEN BELOW). MOUNTING HEIGHT PER TENANT'S REQUEST. PROVIDE BRACING BELOW.

DOOR AND FRAME SCHEDULE											
MARK	DOOR					FRAME		FIRE RATING LABEL	HDMR SET NO		
	WD	SIZE	HOT THK	MATL	GLAZING	TYPE	MATL				FINISH
00	EXISTING DOOR & FRAME TO REMAIN						PAINT			5	
01	3'	6'-6"	1 1/2"	SCWD	YES	FULL GLS - 3/4" TEMP - CLEAR	WD.	PAINT	--	3	KEYPAD ON BOTH SIDES, PER TENANT'S SPEC.
02	3'	6'-6"	1 1/2"	SCWD	YES	VISION PANEL - 3/4" TEMP - CLEAR	WD.	PAINT	--	2	4"X36" VERTICAL VISION PANEL
03	3'	6'-6"	1 1/2"	SCWD	YES	--	WD.	PAINT	--	1	
04	3'	6'-6"	1 1/2"	SCWD	NO	--	WD.	PAINT	--	4	REQUIRES KICKPLATE
05	3'	3'-6"	1 1/2"	SCWD	NO	--	WD.	PAINT	--	1	NOTE: HALF DOOR
06	6'	6'-6"	1 1/2"	SCWD	NO	POCKET DOOR	WD.	PAINT	--	6	
07	3'	6'-6"	1 1/2"	SCWD	NO	DUAL SWING	WD.	PAINT	--	7	

- HARDWARE SETS:
- PASSAGE LEVERED SET, CLOSER, WALL STOP
  - KEYED LEVER HDMR SET, WALL STOP
  - PUSH/PULL, CLOSER
  - PRIVACY LEVERED SET, CLOSER, WALL STOP
  - ADD PANIC HARDWARE & CLOSER
  - RECESSED HANDLES & SLIDING MECHANISMS
  - LEVER PULLS & BALL CATCH IN EACH PANEL

NOTE: MAGNETIC LOCKS AT ALL EXTERIOR EXIT DOORS.

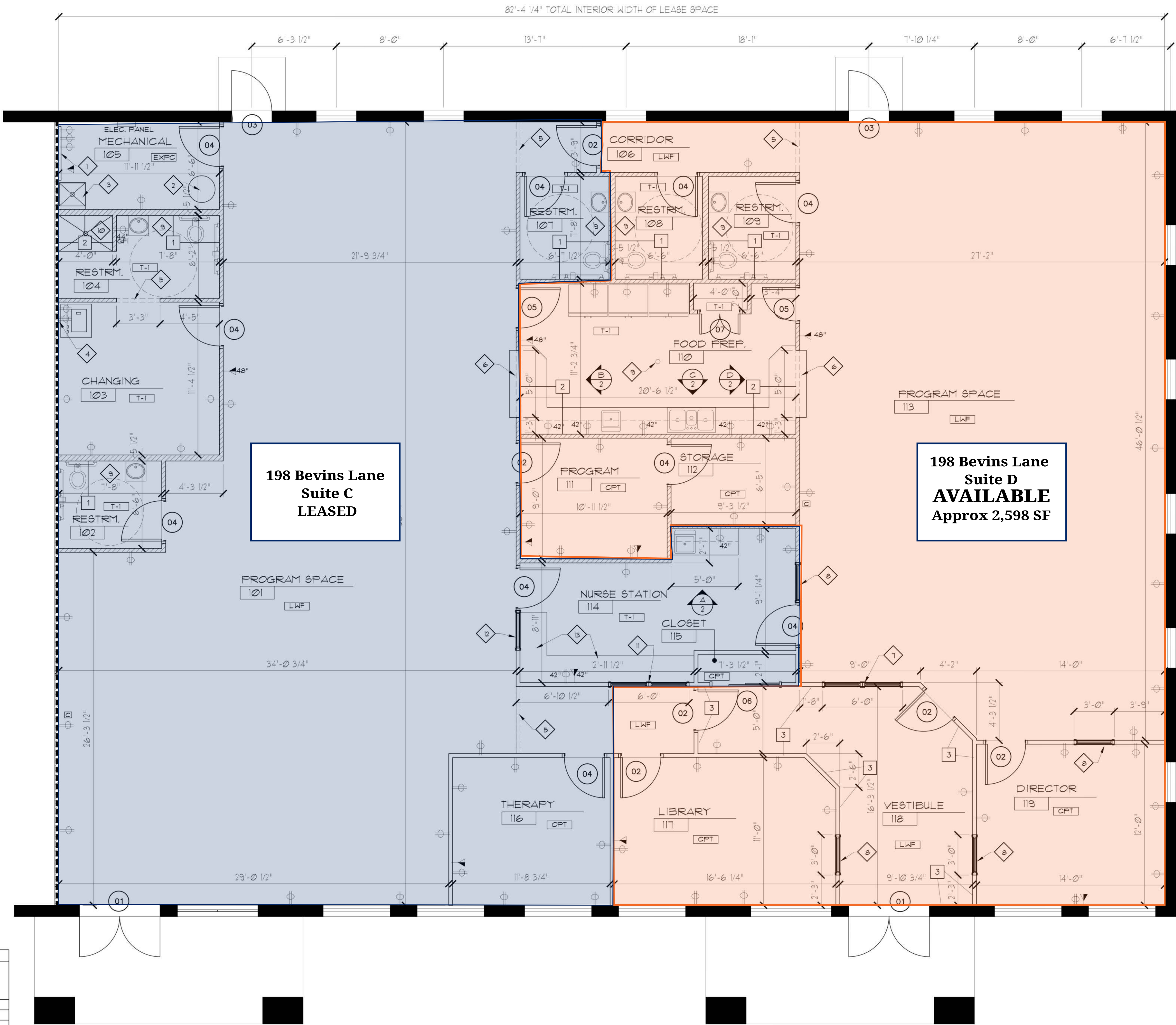

POWER & SIGNAL LEGEND

- TYPICAL SYMBOL NOMENCLATURE
- OUTLET - DUPLEX
- OUTLET - 220
- OUTLET - VOICE/DATA
- 42" - INCHES ABOVE FLOOR
- CABLE TV OUTLET
- SINGLE POLE SWITCH
- NOTE: SWITCHES LOCATED IN FIELD. ADDITIONAL DUPLEX OUTLETS MAY BE REQUIRED PER LOCAL CODE OR PER TENANT'S REQUEST. COORDINATE EQUIPMENT POWER REQUIREMENTS W/ MANUFACTURER & TENANT.

FLOOR PLAN

SCALE: 1/4" = 1'-0"

CLASSIFICATION: KBC 305.2 "DAYCARE"  
"DAYCARE" PER KBC 2013, TABLE 1004.1.2  
OCCUPANCY COUNT:

PROGRAM SPACE 101	=	1,568 sf / 35	=	45
OFFICES (1 EACH)	=		=	5
FOOD PREP	=		=	2
CHANGING	=		=	1
VESTIBULE	=		=	2
LIBRARY	=	181 sf / 50	=	3

TOTAL OCCUPANCY = 92



2525 HARRODSBURG RD.,  
LEXINGTON, KY. 40504  
T:859.983.6760 • F:502.586.8004  
WWW.STUDIOAARCH.COM



PROJECT NAME

ACTIVE DAY  
SENIOR CARE

198 Bevens Lane, Suite F  
Georgetown, Ky.

CLIENT

SEAL

No.	Description	Date

CD

© 2011 STUDIO A ARCHITECTURE  
MATERIAL INCLUDED HEREIN IS COVERED BY  
COPYRIGHT. USE OF THIS WORK IN WHOLE OR IN  
PART IS FORBIDDEN WITHOUT THE EXPRESSED  
WRITTEN CONSENT OF STUDIO A ARCHITECTURE.

A-1

Project number 2013-078  
Date 7/28/14

Scale

For marketing purposes only, exact locations not warranted.