

BMP'S SHOWN ARE THE MINIMUM REQUIRED. CONTRACTOR SHALL INSTALL ADDITIONAL BMP'S AS NECESSARY THROUGHOUT ALL PHASES OF CONSTRUCTION TO ENSURE ALL REQUIREMENTS OF PARISH AND LPDES PERMIT ARE MET, AT NO ADDITIONAL COST TO OWNER.

CONTRACTOR SHALL BE RESPONSIBLE FOR ADJUSTING AND MAINTAINING EROSION AND SEDIMENTATION CONTROL MEASURES (SILT FENCING, ROCK CHECK DAMS, ETC.) DURING ALL PHASES OF CONSTRUCTION.

CONTRACTOR IS RESPONSIBLE FOR EROSION & SEDIMENTATION CONTROL FOR ALL AREAS INCLUDED IN THE LIMITS OF DISTURBANCE AND ANY ADDITIONAL AREAS IMPACTED BY THE PROJECT. CONTRACTOR'S RESPONSIBILITY SHALL BEGIN AT THE AWARD OF BID & SHALL CONTINUE UNTIL THE PROJECT IS ACCEPTED BY THE OWNER AND CLOSED OUT WITH THE PROPER GOVERNING AUTHORITY.

REFERENCE LANDSCAPE PLANS FOR FINAL STABILIZATION REQUIREMENTS.

ACREAGE SUMMARY	
TOTAL PROJECT AREA	+/- 21 ACRES
DISTURBED AREA	+/- 21 ACRES
UNDISTURBED AREA	+/- 1 ACRES

LEGEND - NEW IMPROVEMENTS

SITE FEATURES

PROPERTY LINE
LIMITS OF DISTURBANCE
PROPOSED CONTOUR

EROSION DETAILS

SS SWPPP INFORMATION SIGN
IP INLET PROTECTION *
FP FLUME PROTECTION
SF TEMPORARY SILT FENCE
CE TEMPORARY CONSTRUCTION EXIT
SB STRAW BALES
RR RIP RAP PAD
TS TEMPORARY SWALE
PP ROCK PIPE PROTECTION

* ALL INLETS SHALL CONTAIN INLET PROTECTION UPON COMMENCEMENT OF CONSTRUCTION. EXISTING DRAINAGE STRUCTURES IN PAVED AREAS INCORPORATING INLET PROTECTION SHALL SOLELY USE FILTER SACK PROTECTION.

REFER TO SURVEY FOR LEGEND OF EXISTING FEATURES

REFERENCE SHEET ES-1 FOR ALL EROSION CONTROL AND BMP MAINTENANCE NOTES

REFERENCE SHEET ES-3 FOR TIME SCHEDULE AND DETAILS ON EROSION CONTROL MEASURES

REVISION	BY

DUPLANTIS DESIGN GROUP, PC
8352 Bluebonnet Blvd. Baton Rouge, La 70810
Phone: 225-751-4490 | Fax: 225-751-4495
THIBODAUX | COVINGTON
HOUSTON | BATON ROUGE

DDG
WWW.DDGPC.COM

SIGNATURE: *Joseph Morino, Jr.*
DATE: 3/2/2018
STAMP: PROFESSIONAL ENGINEER IN CIVIL ENGINEERING
STATE OF LOUISIANA
C. Joseph Morino, Jr.
Lic. No. 35928

CAMPING WORLD & GANDER OUTDOORS
REES STREET EXTENSION
BREAUX BRIDGE, LOUISIANA
ST. MARTIN PARISH
FOR STRUCTURED REAL ESTATE
1046 W. KINZIE ST., SUITE 301
CHICAGO, ILLINOIS 60642

DRAWN CDS
CHECKED CJM
ISSUED DATE 3/2/2018
ISSUED FOR CONSTRUCTION
PROJECT NO. 18-108
FILE 18-108 ES-2 Phase 2 Erosion Control Plan
SHEET ES-2

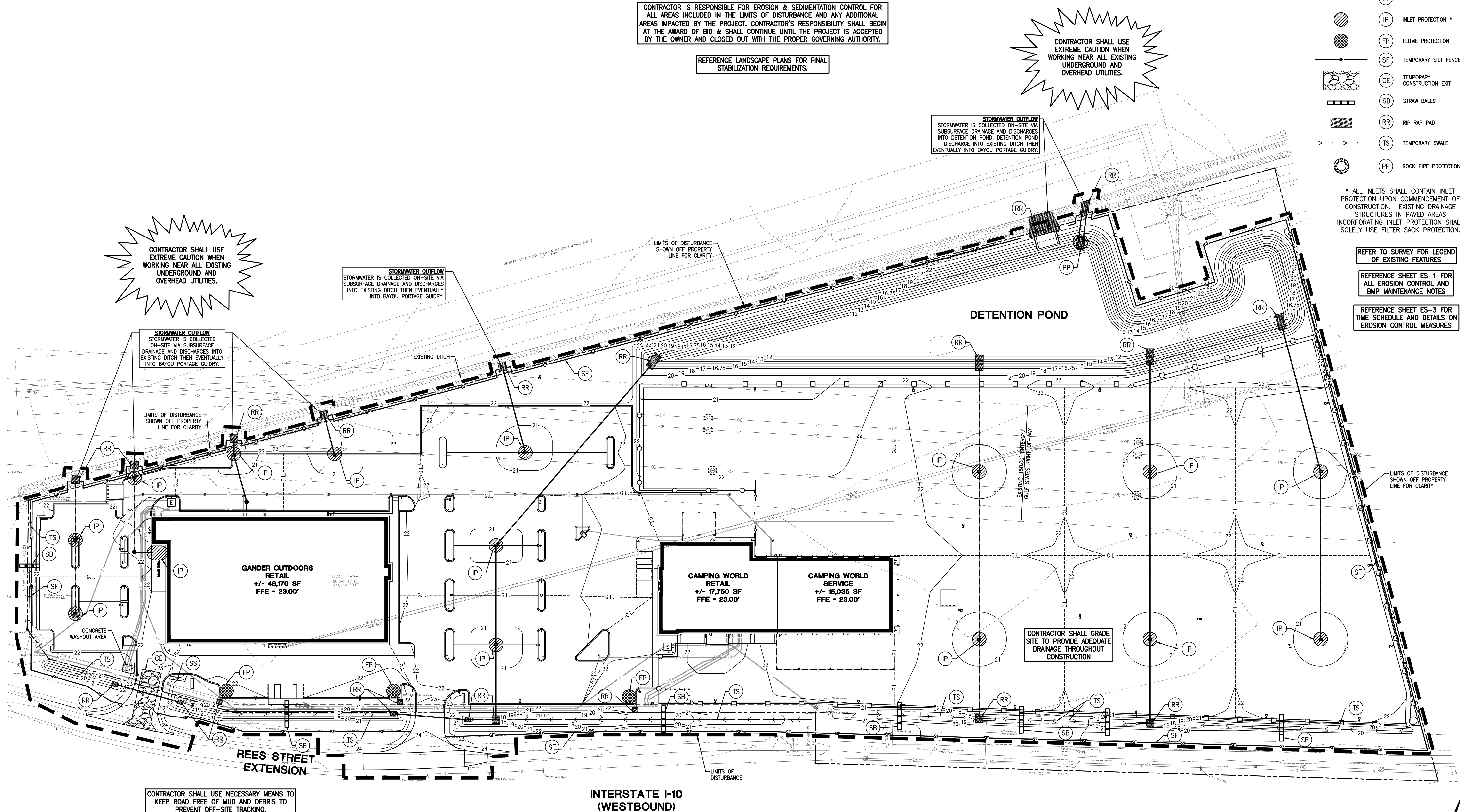

PHASE 2 EROSION CONTROL PLAN

SCALE IN FEET
60' 30' 0 60' 120' 180'

One Call
CALL 811
BEFORE YOU DIG
800-727-2620