

9500 BLOCK OF MANSFIELD RD.
SHREVEPORT, LA 71118

LAND FOR SALE ON MANSFIELD ROAD

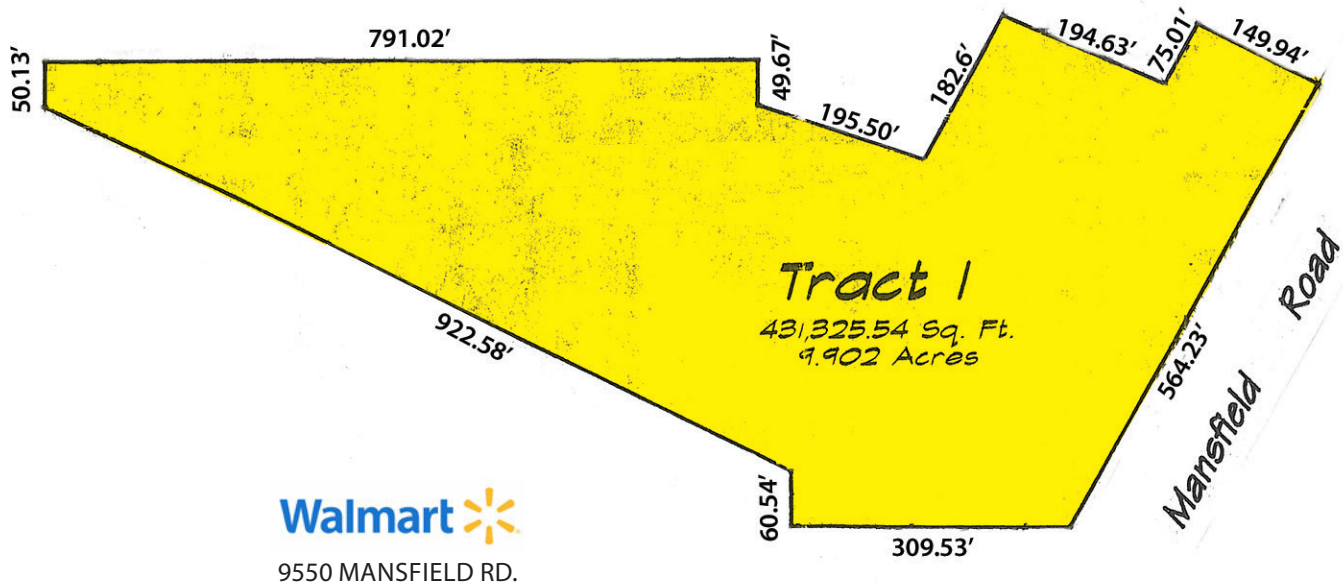

HIGHLIGHTS

- 9.902 ACRES TRACT OF LAND, OWNERS WILL CONSIDER SUBDIVIDING
- THE PARCEL IS ADJACENT TO THE WALMART SUPERCENTER LOCATED AT 9550 MANSFIELD ROAD
- THE PARCEL HAS 564.23 LINEAR FEET ON MANSFIELD ROAD
- THE TRAFFIC COUNT IS APPROXIMATELY 28,397 CARS PER DAY
- THE TRACT IS ZONED B-3 AND R-3

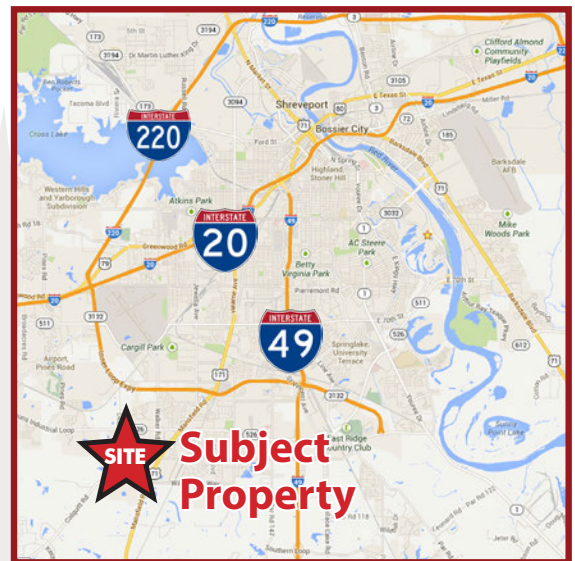

For More Info Contact:

Andrew Querbes IV | Associate Broker | 318-222-2244

aquerbes@vintagerealty.com | vintagerealty.com

ALL INFORMATION CONTAINED HEREIN IS BELIEVED TO BE ACCURATE, BUT IS NOT WARRANTED AND NO LIABILITY OF ERRORS OR OMISSIONS IS ASSURED BY EITHER THE PROPERTY OWNER OR VINTAGE REALTY COMPANY OR ITS AGENTS AND EMPLOYEES. PRICE AS STATED HEREIN AND PRODUCT AVAILABILITY IS SUBJECT TO CHANGE AND/OR SALE OR LEASE WITHOUT PRIOR NOTICE, AND ALL SIZES AND DIMENSIONS ARE SUBJECT TO CORRECTION.3/2015

9500 BLOCK OF MANSFIELD RD.
SHREVEPORT, LA 71118

LAND FOR SALE ON MANSFIELD ROAD



For More Info Contact:

Andrew Querbes IV | Associate Broker | 318-222-2244
aquerbes@vintagerealty.com | vintagerealty.com

ALL INFORMATION CONTAINED HEREIN IS BELIEVED TO BE ACCURATE, BUT IS NOT WARRANTED AND NO LIABILITY OF ERRORS OR OMISSIONS IS ASSURED BY EITHER THE PROPERTY OWNER OR VINTAGE REALTY COMPANY OR ITS AGENTS AND EMPLOYEES. PRICE AS STATED HEREIN AND PRODUCT AVAILABILITY IS SUBJECT TO CHANGE AND/OR SALE OR LEASE WITHOUT PRIOR NOTICE, AND ALL SIZES AND DIMENSIONS ARE SUBJECT TO CORRECTION. 3/2015