



3,146 SF

RETAIL SPACE | FOR LEASE

St. Charles Ave. Retail Space in Place St. Charles

Located in CBD near the French Quarter

201 St. Charles Avenue
NEW ORLEANS, LA 70170



Joe Gorman CCIM
jgorman@corp-realty.com
504.582.1406



CORPORATE REALTY

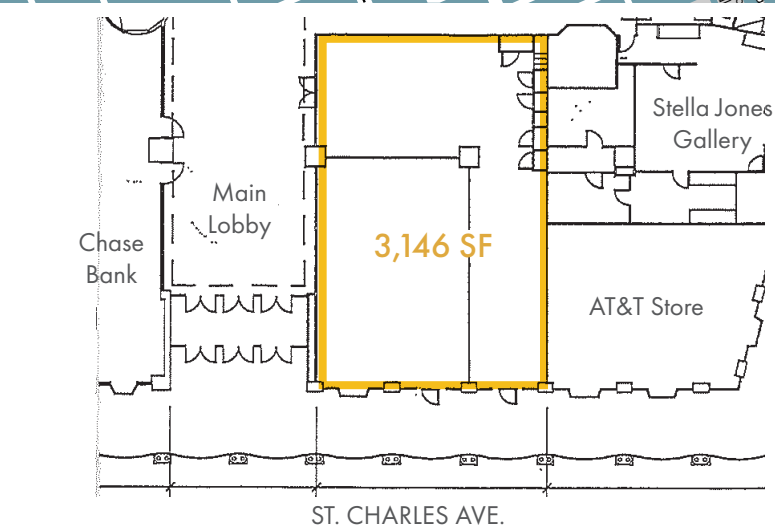
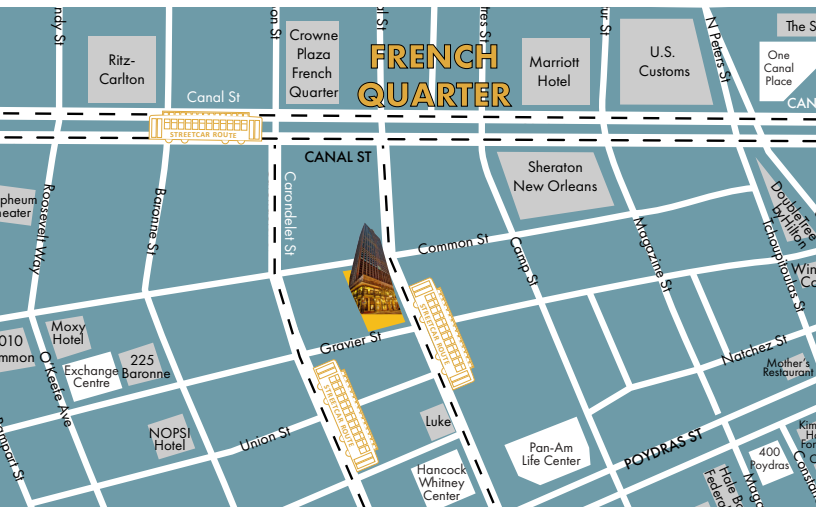

SIZE

3,146 sf

RENTAL RATE

\$33.00/sf, NNN

DESCRIPTION

Fantastic retail suite with high visibility, glass façade, and St. Charles Ave frontage available Summer 2026. Suite features 3,146 sf and is strategically located at the building entrance. Glass walls on the exterior front St. Charles Ave and on the interior front the Place St. Charles lobby. Space is ideal for men's fashion, and Owner will consider other retail uses. Roughly 1,800 people currently work in the building.

HIGHLIGHTS

- High visibility from St. Charles Ave and Place St. Charles' main and elevator lobbies
- Steps away from the first streetcar stop on the historic St. Charles Ave Streetcar route
- Co-tenants include Chase Bank, AT&T store, Ship Happens, Pierre's Jewelry, Main Squeeze, Stella Jones Art Gallery, Executive Traditions Tailoring, and Place St. Charles Food Court
- In-building, hourly parking
- Stable building ownership

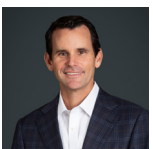

Joe Gorman CCIM
jgorman@corp-realty.com
504.582.1406



CORPORATE REALTY