

SUMMARY

AERIAL

SITE PLAN

PHOTOS

MAPS

DEMOGRAPHICS

FOR LEASE

APPROXIMATE GLA

- 108,930 SF

AVAILABLE BAYS

- Suite A - 2,625 SF
Freshly Renovated Vanilla Box
Former China Palace
- Suite B-C - 3,900 SF
Freshly Renovated Vanilla Bo
Former Fox's Pizza Den
- Suite E - 2,300 SF
- Suite I - 600 SF
- Suite J - 840 SF
- Suite K - 540 SF
- Suite P1-2 - 3,158 SF
- Suite Q - 1,425 SF

EXECUTIVE SUMMARY

Southwest Mall Shopping Center is located on the main thoroughfare in McComb, Mississippi. Surrounding businesses include Kroger, CVS Pharmacy, Harbor Freight Tools, Wendy's and Southwest Mississippi Regional Medical Center. One mile north of the center is a Walmart Supercenter, Lowe's and Uptown McComb Center, consisting of Belk, Bealls, Aldi, Hobby Lobby, Marshalls, Ross Dress For Less, and Shoe Dept. Encore.

TENANTS INCLUDE

Fitness Depot, Dollar Tree, Dollar General, O'Reilly Auto Parts, Petsense, Rent-A-Center, El Sombrero Mexican Restaurant, Hibbett, Hollywood Beauty Mart, The UPS Store, and many more!

TRAFFIC COUNT (ADT 2024)

On Delaware Avenue, west of Price Street: 13,000





SUMMARY

AERIAL

SITE PLAN

PHOTOS

MAPS

DEMOGRAPHICS

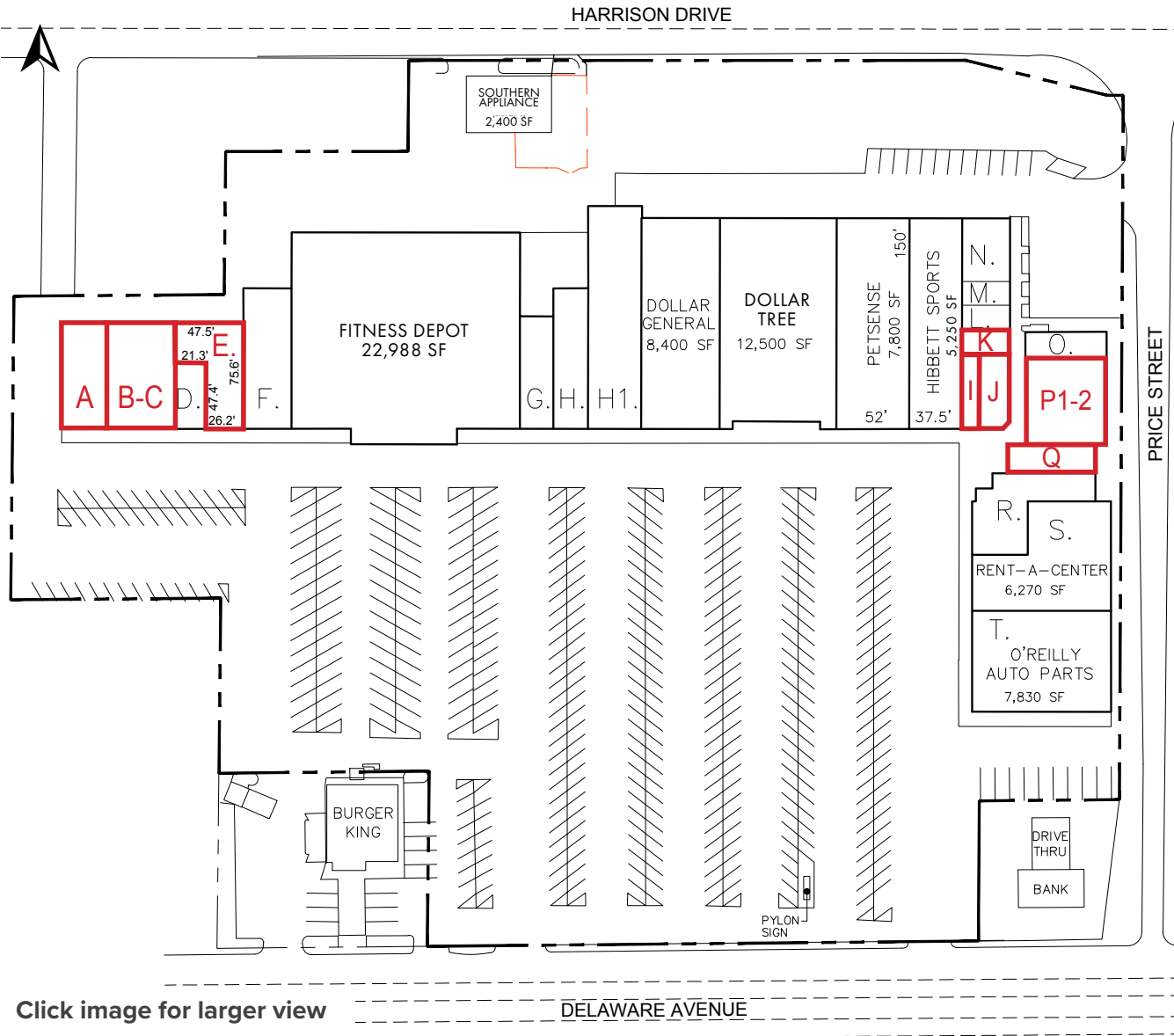

TENANTS

Fitness Depot	22,988 SF
Dollar Tree	12,500 SF
Dollar General	21,155 SF
Petsense	8,400 SF
Hibbett	5,625 SF
A AVAILABLE (Former China Palace)	2,625 SF
B-C AVAILABLE (Former Fox's Pizza Den)	3,900 SF
D Edward Jones	900 SF
E AVAILABLE	2,300 SF
F Hollywood Beauty Mart	3,500 SF
G U.S. Army Recruiting	2,000 SF
H Advance America	2,500 SF
H1 El Sombrero Mexican Restaurant	5,810 SF
I AVAILABLE	600 SF
J AVAILABLE	840 SF
K AVAILABLE	540 SF
L Maxine S. Brock, CPA	300 SF
M Occupied	300 SF
N Jay Bee Co. Real Estate	1,152 SF
O Occupied	740 SF
P1-2 AVAILABLE	3,158 SF
Q AVAILABLE	1,425 SF
R The UPS Store	1,747 SF
S Rent-A-Center	6,270 SF
T O'Reilly Auto Parts	7,830 SF

SUMMARY

AERIAL

SITE PLAN

PHOTOS

MAPS

DEMOGRAPHICS



stirling

RHONDA SHARKAWY

Office: 504-523-4481

Direct: 504-620-8145

rsharkawy@stirlingprop.com

SOUTHWEST MALL SHOPPING CENTER

NWC of Delaware Avenue & Price Street, McComb, MS

SUMMARY

AERIAL

SITE PLAN

PHOTOS

MAPS

DEMOGRAPHICS

MISSISSIPPI STATE MAP

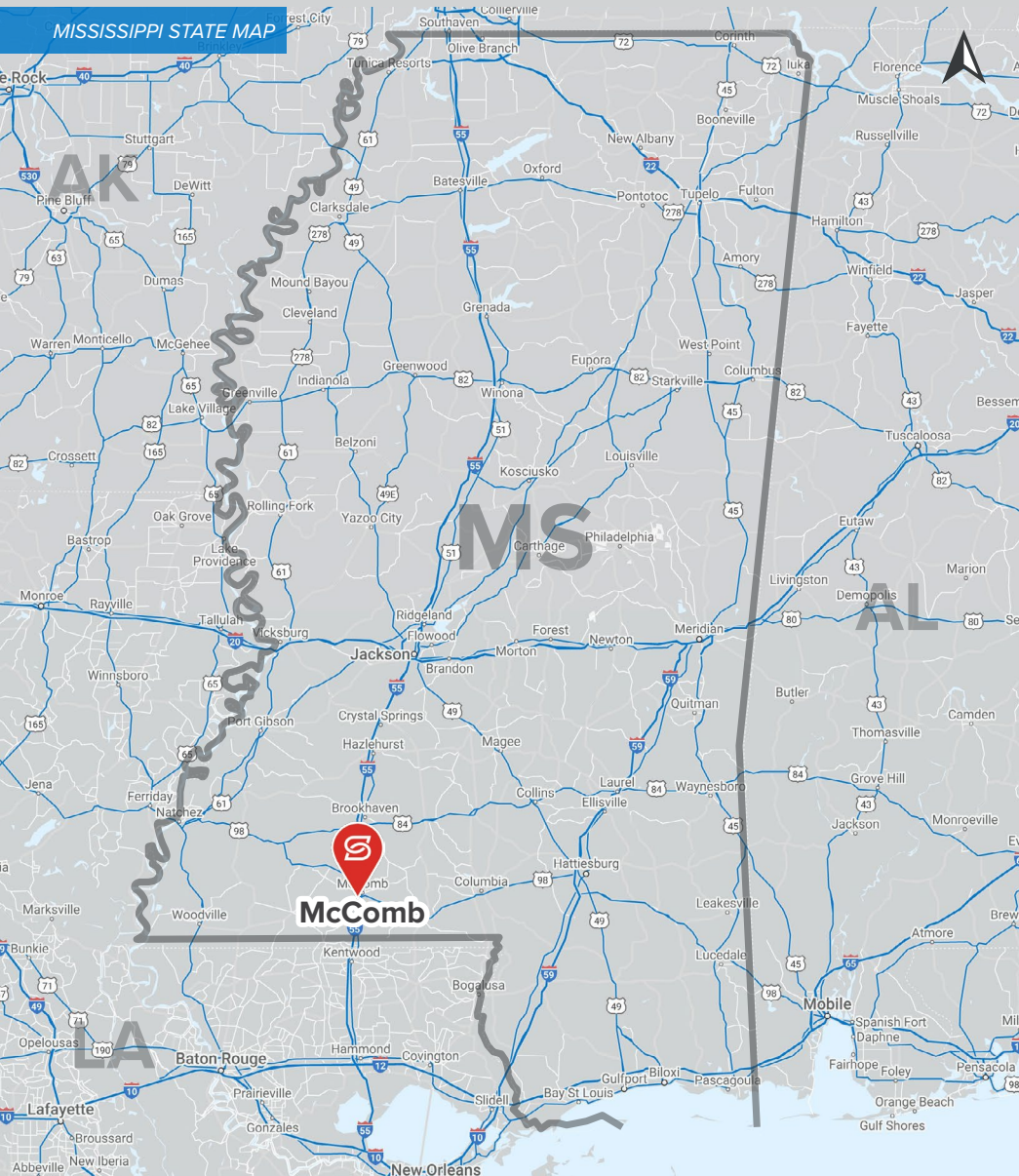

MCCOMB MAP



SUMMARY

AERIAL

SITE PLAN

PHOTOS

MAPS

DEMOGRAPHICS

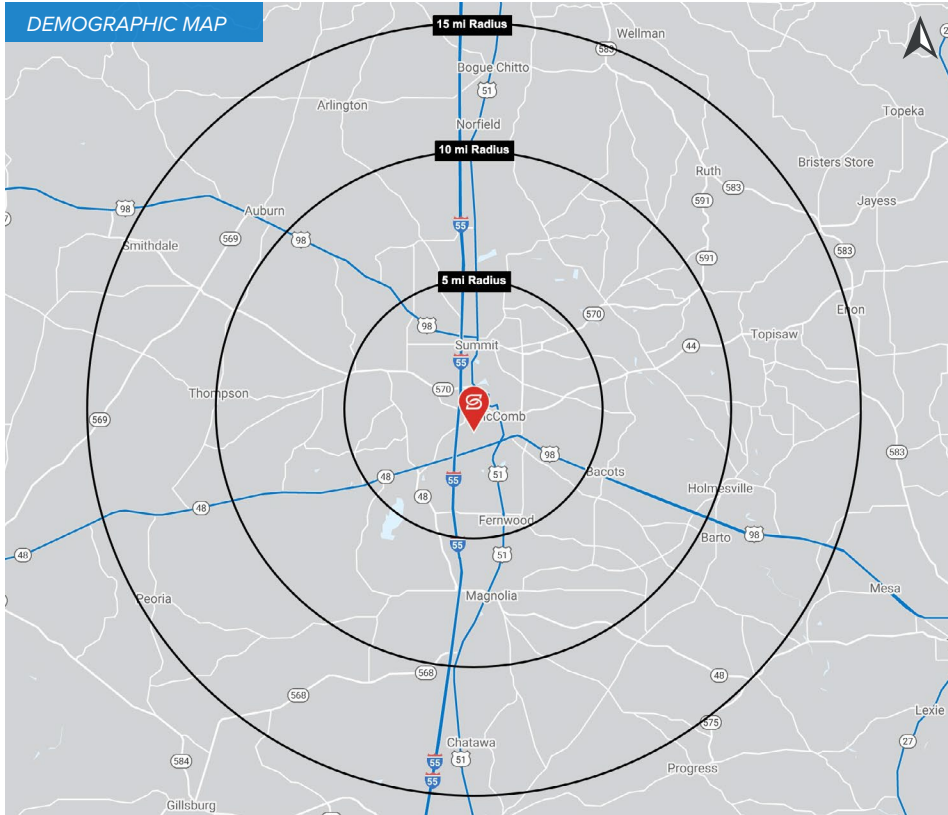

2025 DEMOGRAPHICS

5 MILE

10 MILE

15 MILE



POPULATION

22,325

34,184

46,607

5 MILE

10 MILE

15 MILE



AVG. HH
INCOME

\$58,661

\$63,262

\$65,031

5 MILE

10 MILE

15 MILE



HOUSEHOLDS

8,696

13,433

18,548