

A SURVEY OF THE PROPERTY  
OF  
ROBERT WYLIE JENKINS

W-5 BAYOU  
FALAYA LATERAL

S 33° 54' 45" E  
(S 40° 40' E-T)  
66.2'

S 87° 51' 45" E  
(S 76° 02' E-T)  
58.0'

N 49° 29' E (N 49° 10' E-T)  
478.0'

1.70 ACRES

S 40° 27' W - 493.7'

NORTHWEST CORNER  
OF SECTION 37  
T-6-S, R-11-E

### LEGEND

• 1/2" IRON PIPE FOUND

SEC. 45

1332.7'

SOUTH

SEC. 37

NOTE: The calls to the point of beginning  
were taken from a survey by Eddie J. Champagne  
dated April 1, 1971, drawing #3238, made for  
Carmel Graci.  
REFERENCE: Said plat by Eddie J. Champagne.

A CERTAIN PIECE OR PORTION OF GROUND situated in Section 45, Township 6 South, Range 11 East, St. Tammany Parish, Louisiana, and more fully described as follows:  
From the Northwest Corner of Section 37, Township 6 South, Range 11 East, go South 1332.7 feet along the section line common to Sections 37 and 45 to a point located on the northerly right-of-way line of U.S. Highway 190 (Covington By-Pass)(Collins Boulevard); thence go along the northerly right-of-way line of said highway North 64 degrees 50 minutes West 904.5 feet to an 1/2-inch iron pipe and the point of beginning. From the point of beginning, continue along the northerly right-of-way line of U.S. Highway 190 North 64 degrees 37 minutes West 200.0 feet (Title-North 64 degrees 50 minutes West) to an 1/2-inch iron pipe; thence North 49 degrees 29 minutes East 534.2 feet (Title-North 49 degrees 10 minutes East) to a point located in W-5 Bayou Falaya Lateral; thence South 33 degrees 54 minutes 45 seconds East 66.2 feet (Title-South 40 degrees 46 minutes East) in said bayou; thence South 87 degrees 51 minutes 45 seconds East 58.0 feet (Title-South 76 degrees 02 minutes East) in said bayou; thence South 40 degrees 27 minutes West 493.7 feet to an 1/2 inch iron pipe located on the northerly right-of-way line of the above mentioned U.S. Highway 190 and the point of beginning.

Said property contains 1.70 acres.



Herbert C. Sanders

A PORTION OF GROUND SITUATED IN  
SECTION 45, TOWNSHIP 6 SOUTH, RANGE 11 EAST,

ST. TAMMANY PARISH,  
LOUISIANA

H. C. SANDERS & ASSOCIATES, INC.  
CIVIL ENGINEERS & LAND SURVEYORS  
THE FOUNTAIN BUILDING  
Post Office Drawer 1779 - Covington, La. 70434  
Office: 892-2847

| JOB NO.   | DRAWN   | DATE       | SHEET NO. |
|-----------|---------|------------|-----------|
| ST-83-423 | RICK    | 20 OCT. 83 | 1 OF 1    |
|           | CHECK'D | SCALE      |           |
|           | HCS     | 1" = 60'   |           |

SURVEY

Sketch

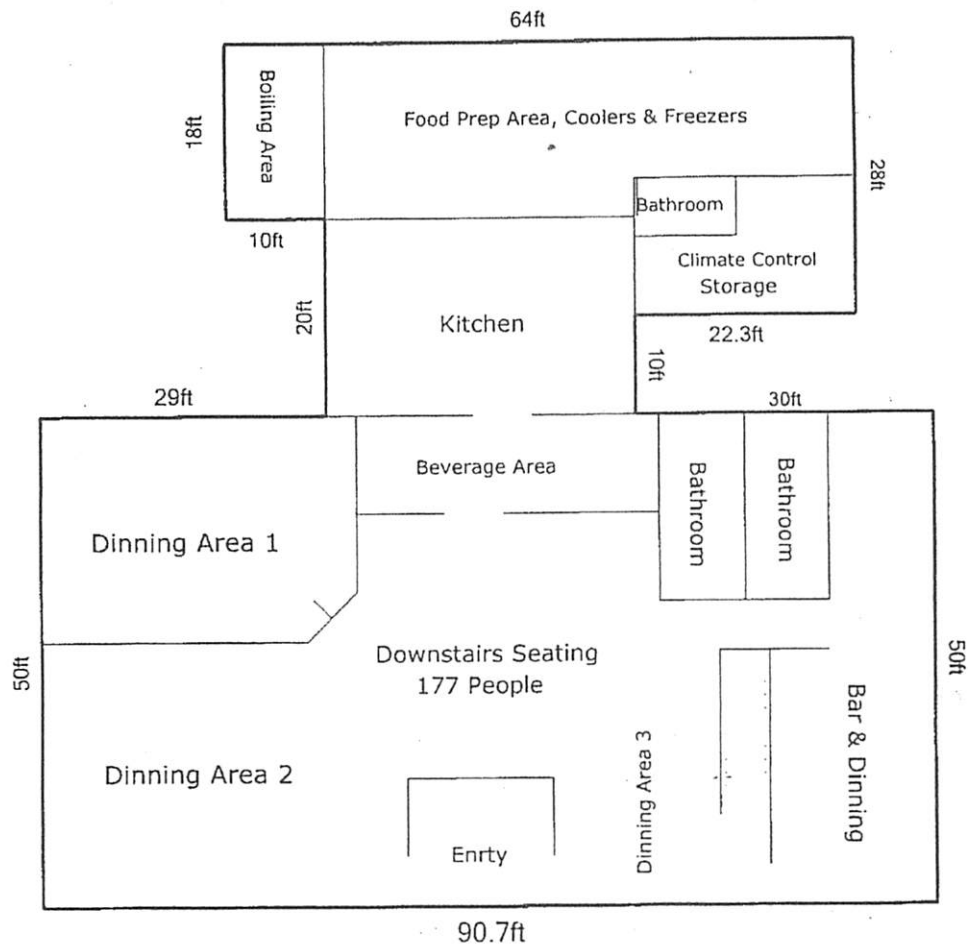

Seafood World First Floor  
[Area: 6544 ft<sup>2</sup>]



Seafood World Upstairs  
[Area: 2170 ft<sup>2</sup>]

18 ft

FLOOR PLAN