

SKETCH/AREA TABLE ADDENDUM

SUBJECT INFO

File No.: Parcel No.: 007-6959-2 & 007-6962-2
 Property Address: 6109-6111 Hollyfield Drive
 City: Baton Rouge County: East Baton Rouge State: LA ZipCode: 70809
 Owner: D&T Properties, LLC
 Client: Red River Bank Client Address: 1412 Centre Court Dr, Ste 202, Alexandria, LA 71301
 Appraiser Name: James N. Lieux, Jr. Inspection Date: 10/09/2024

SKETCH

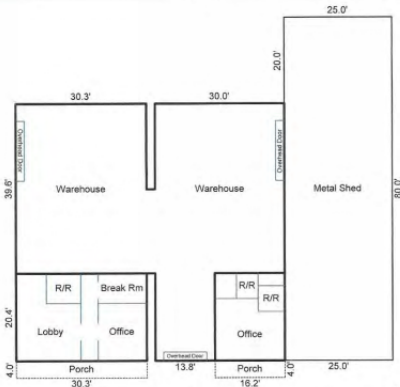

Sketch by Apex Sketch

AREA CALCULATIONS SUMMARY

Code	Description	Factor	Net Size	Perimeter	Net Totals
GBA1	Office	1.0	618.1	101.4	
	Office	1.0	330.5	73.2	
	Warehouse	1.0	2708.6	284.6	3657.2
	Metal Shed	1.0	2000.0	210.0	2000.0
OTH	Porch	1.0	64.8	40.4	
P/P	Porch	1.0	121.2	68.6	186.0

Net BUILDING

(rounded)

3,657